

ATTACHMENT 1

Appendix A

Vicinity Map

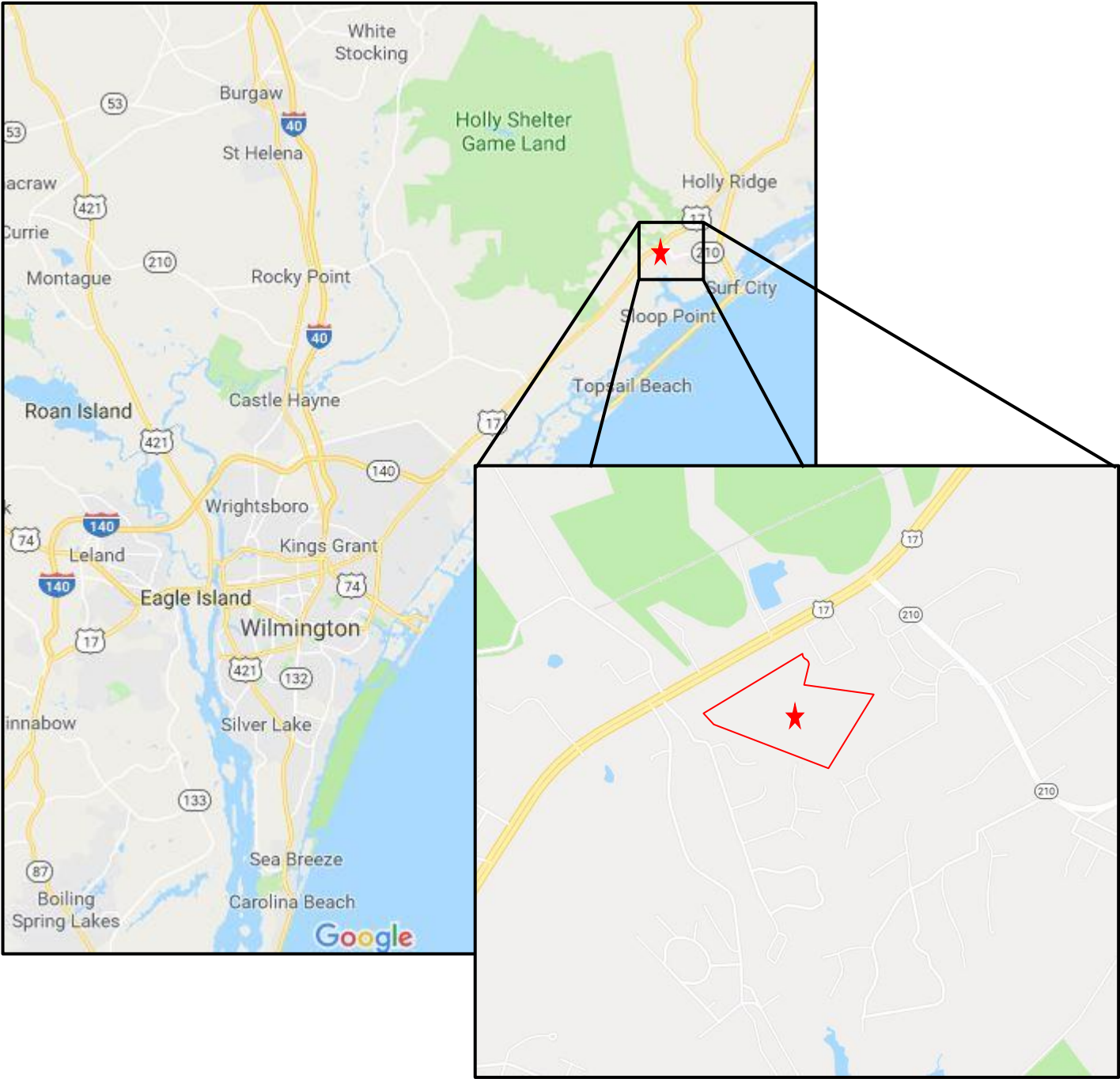

Appendix B

2018 Google Earth Aerial Photograph



ATTACHMENT 2

U.S. HIGHWAY 17
VARIABLE WIDTH RIGHT OF WAY
R-2405 C & D - PROJECT 6.2790021

Overall Impact Map - EX-1
The Terraces
Town of Surf City, North Carolina
Date: 10.16.2019

LEGEND

- JURISDICTIONAL WETLAND IMPACTS
- TEMPORARY WETLAND IMPACT
- STREAM
- RPW
- SWAMP FOREST (SF)
- HEADWATER FOREST (HF)
- POCOSIN (P)

SITE DATA

SITE ACREAGE = 40.56 AC. +/-

TEMPORARY STREAM IMPACT = 20 LF (TOTAL)

WETLAND IMPACTS				
IMPACT AREA	PERMANENT IMPACT		TEMPORARY IMPACT	
	SF	ACRES	SF	ACRES
'A'	5,197	0.119	1,037	0.024
'B'	9,083	0.209	520	0.012
'C'	3,127	0.072	0	0.000
'D'	2,936	0.067	0	0.000
'E'	4,211	0.097	218	0.005
'F'	2,121	0.049	179	0.004
'G'	6	0.0001	0	0.000
'H'	1,342	0.031	0	0.000
'I'	1,072	0.025	0	0.000
'J'	193	0.0044	0	0.0000
'K'	1,265	0.029	0	0.000
'L'	0	0.000	2,124	0.049
'M'	525	0.012	0	0.000
'N'	0	0.000	591	0.014
TOTAL IMPACTS =				
	31,077	0.713	4,668	0.107

NOTE: SEE EX-2 AND EX-3 FOR FURTHER BREAKDOWN OF WETLAND IMPACT AREAS

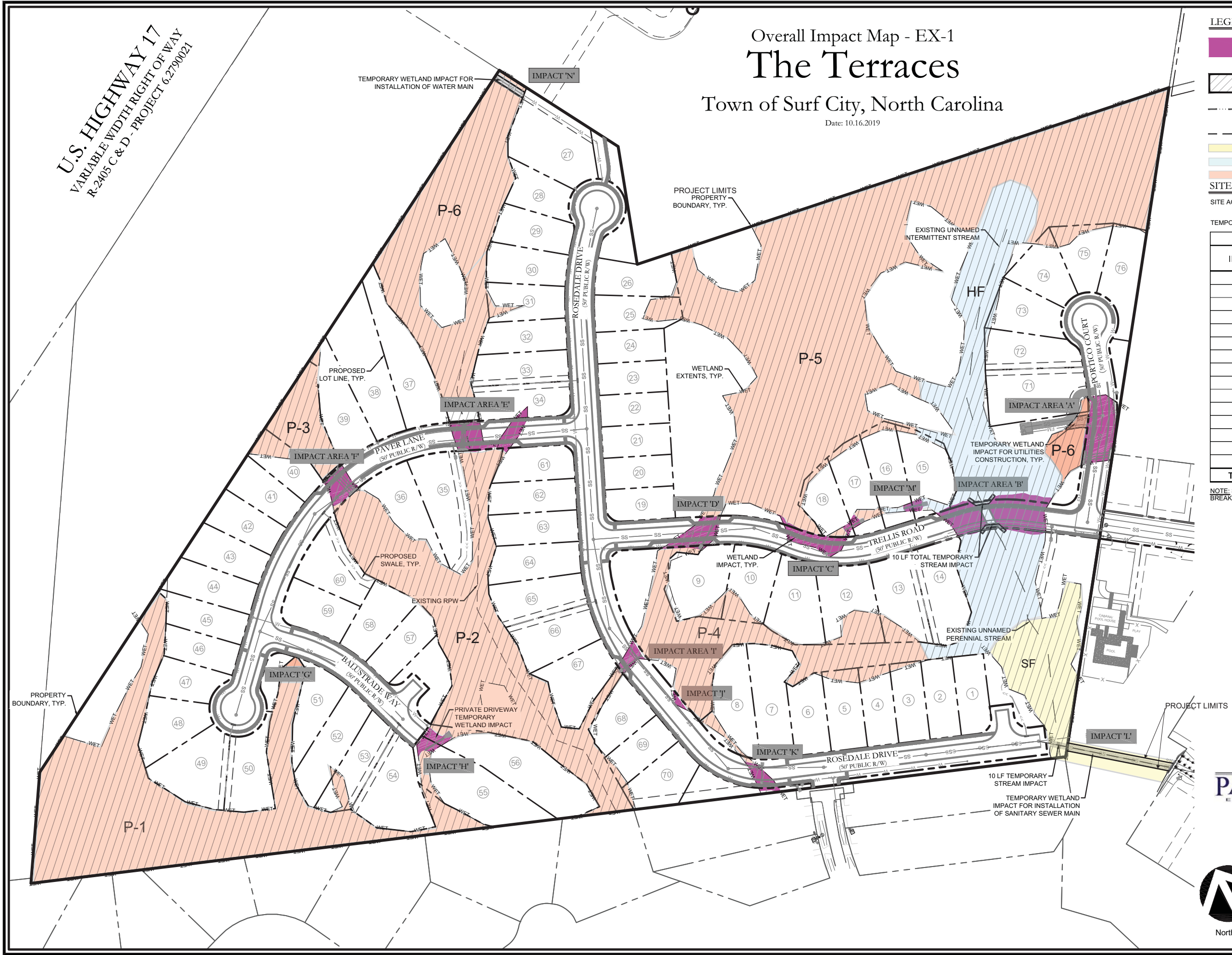

PARAMOUNTE
ENGINEERING, INC.

Wilmington, North Carolina 28403
(910) 791-6707 (O) (910) 791-6760 (F)
NC License #: C-2846
Project #: 17180.PE

Scale: 1" = 60' at 22" x 34"
1" = 120' at 11" x 17"

North

0' 30' 60' 120'

FINAL DESIGN - NOT RELEASED FOR CONSTRUCTION

Wetland Impacts Plan View - EX-2

The Terraces

Town of Surf City, North Carolina

Date: 10.16.2019

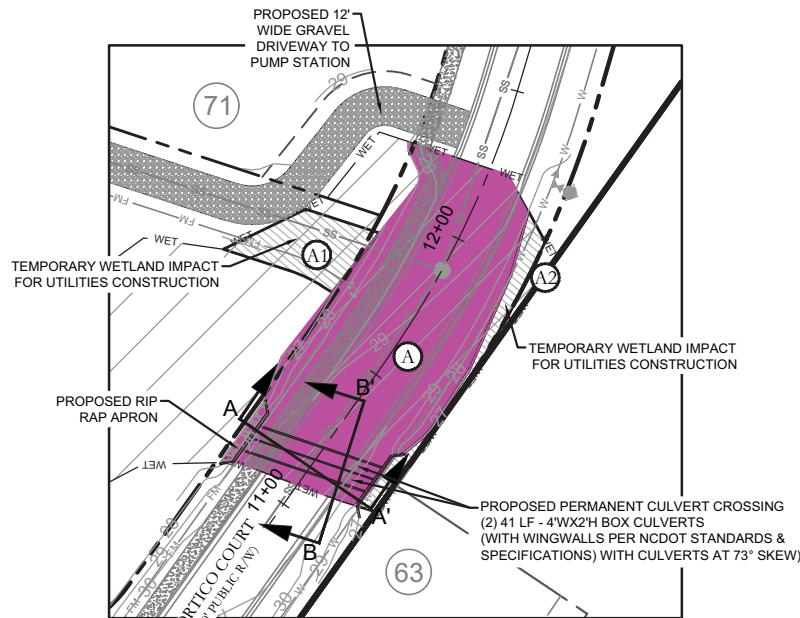

IMPACT AREA 'A'

SCALE: 1"=60' or 1"=30'
A = 5,135 SF (0.118 AC.) - PERMANENT
A1 = 631 SF (0.014 AC.) - TEMPORARY
A2 = 406 SF (0.009 AC.) - TEMPORARY

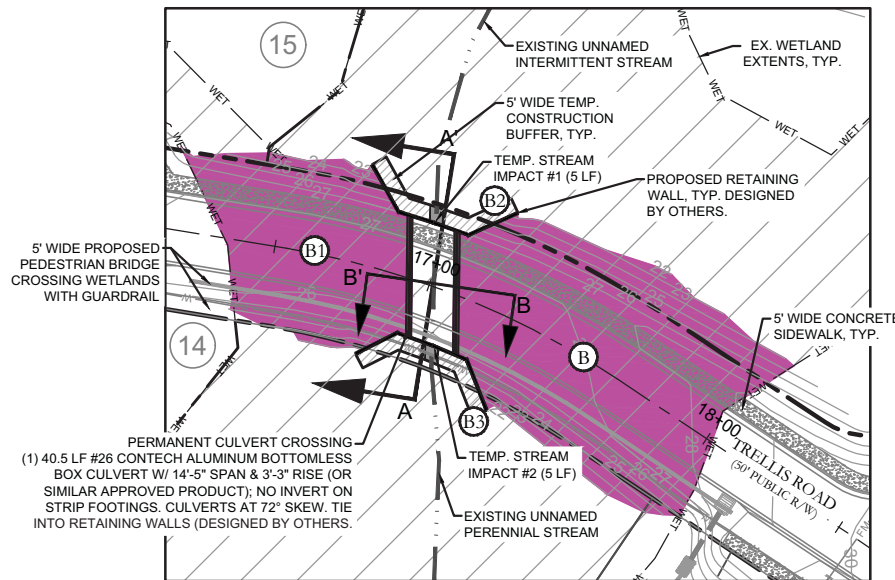

IMPACT AREA 'B'

SCALE: 1"=60' or 1"=30'
B = 5,850 SF (0.134 AC.) - PERMANENT
B1 = 3,233 SF (0.074 AC.) - PERMANENT
B2 = 266 SF (0.006 AC.) - TEMPORARY
B3 = 253 SF (0.006 AC.) - TEMPORARY

LEGEND

	JURISDICTIONAL WETLAND IMPACTS		STREAM		PERMANENT WETLAND IMPACT AREA
	TEMPORARY WETLAND IMPACT		RPW		TEMPORARY WETLAND IMPACT AREA
			STREAM IMPACT		TEMPORARY STREAM IMPACT AREA

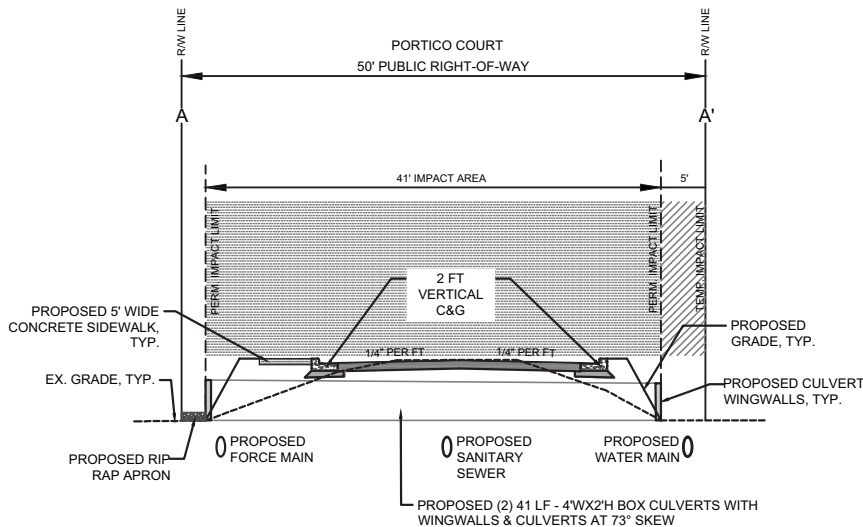

WETLAND IMPACT AREA 'A'
TYP. COLLECTOR STREET - PORTICO COURT
ROAD CROSS SECTION
NOT TO SCALE

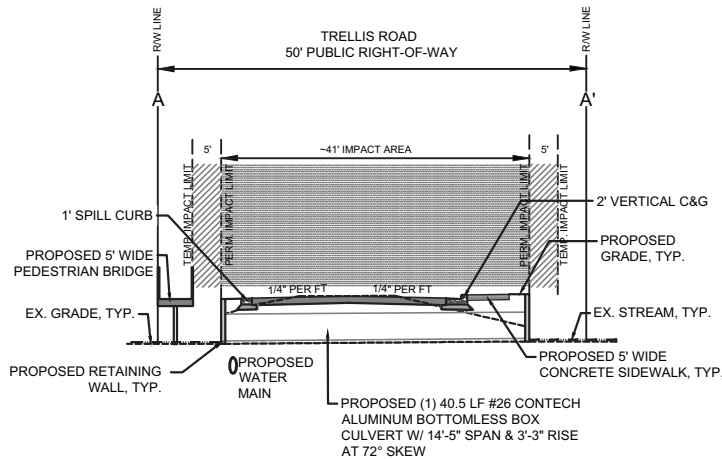

WETLAND IMPACT AREA 'B'
TYP. COLLECTOR STREET - TRELLIS ROAD
ROAD CROSS SECTION
NOT TO SCALE

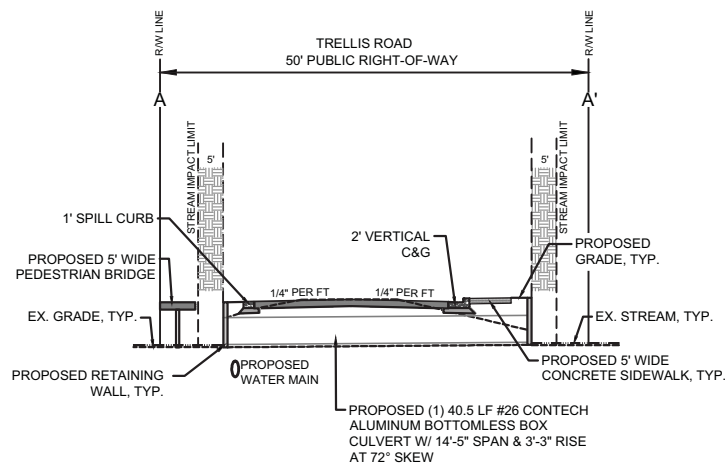

TEMPORARY STREAM IMPACT @ IMPACT AREA 'B'
TYP. COLLECTOR STREET - TRELLIS ROAD
ROAD CROSS SECTION
NOT TO SCALE

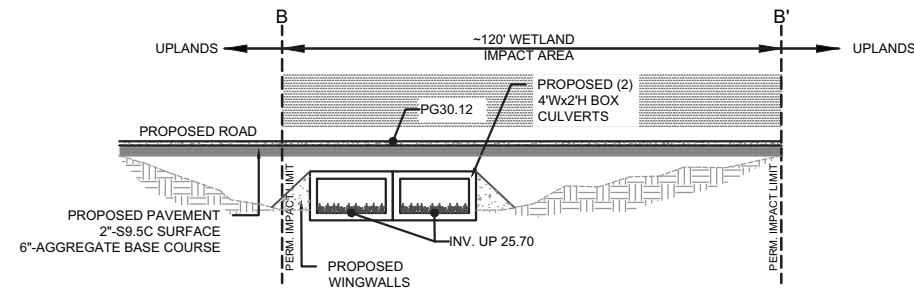

WETLAND IMPACT AREA 'A'
STA. 11+17 PORTICO ROAD
WETLAND CROSS SECTION
NOT TO SCALE

NOTES

- CROSS SECTION FACING DOWNSTREAM (SE TO NW)
- PROPOSED BOXED CULVERTS (2) 41 LF 4'Wx2'H AT 73° SKEW

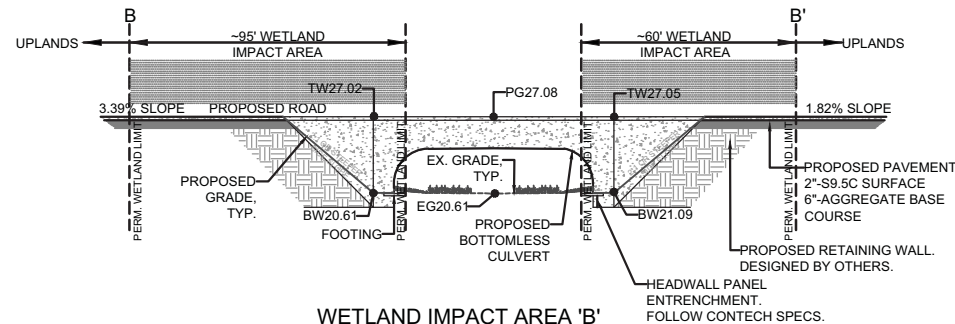

WETLAND IMPACT AREA 'B'
STA. 17+00 TRELLIS ROAD
STREAM CROSS SECTION
NOT TO SCALE

NOTES

- CROSS SECTION FACING DOWNSTREAM (N TO S)
- PROPOSE BOTTOMLESS CULVERT IS CONTECH PRODUCT #26-C6 ALUMINUM BOX CULVERT, ON FOOTING PADS (HS-20 RATING) WITH 14'-5" SPAN AND 3'-3" RISE (OR SIMILAR APPROVED PRODUCT). FOLLOW CONTECH PRODUCT SPECIFICATIONS FOR CONSTRUCTION AND ASSEMBLY REQUIREMENTS.

PARAMOUNTE
ENGINEERING, INC.

Wilmington, North Carolina 28403
(910) 791-6707 (O) (910) 791-6760 (F)
NC License #: C-2846
Project #: 17180.PE



Scale: 1" = 30' at 22" x 34"
1" = 60' at 11" x 17"

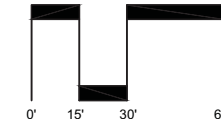

FINAL DESIGN - NOT RELEASED FOR CONSTRUCTION

Wetland Impacts Plan View - EX-3

The Terraces

Town of Surf City, North Carolina

Date: 10.16.2019

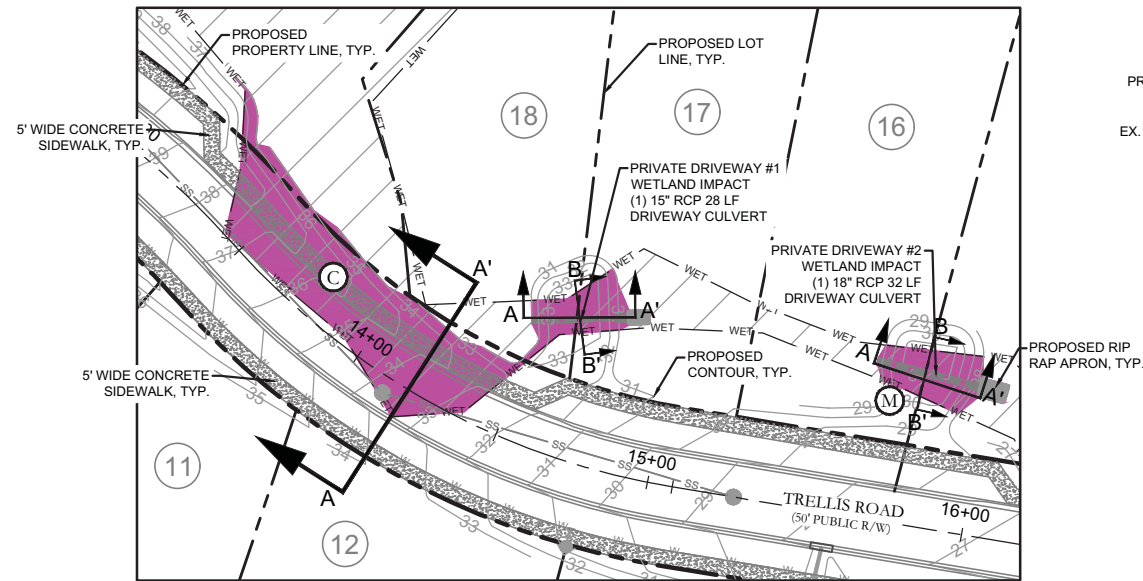

IMPACT AREAS 'C' & 'M'

SCALE: 1"=60' or 1"=30'
IMPACT C = 3,127 SF (0.072 AC.)
IMPACT M = 525 SF (0.012 AC.)

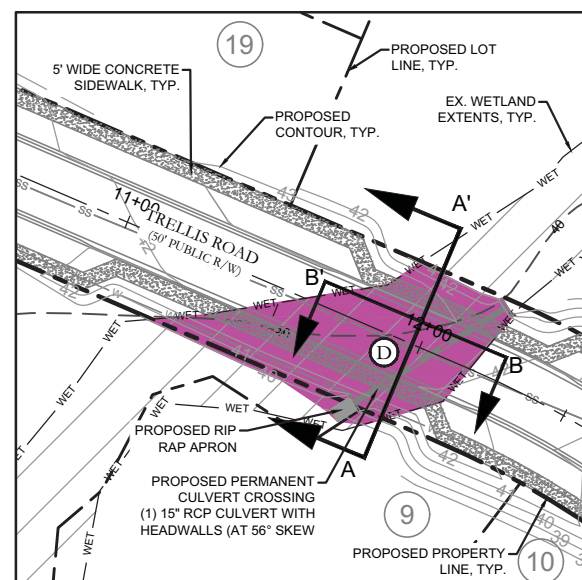

IMPACT AREA 'D'

SCALE: 1"=60' or 1"=30'
D = 2,936 SF (0.067 AC.)

LEGEND

	JURISDICTIONAL WETLAND IMPACTS		STREAM		PERMANENT WETLAND IMPACT AREA
	TEMPORARY WETLAND IMPACT		RPW		TEMPORARY WETLAND IMPACT AREA
			STREAM IMPACT		TEMPORARY STREAM IMPACT AREA

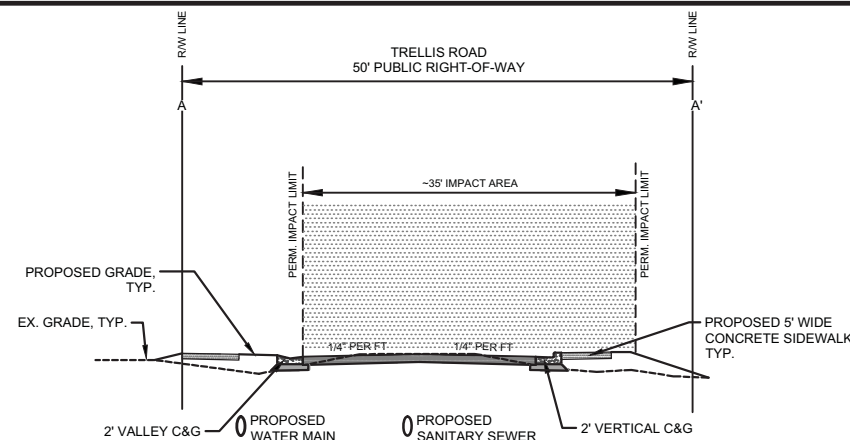

WETLAND IMPACT AREA 'C'
TYP. COLLECTOR STREET - TRELLIS ROAD
ROAD CROSS SECTION

NOT TO SCALE

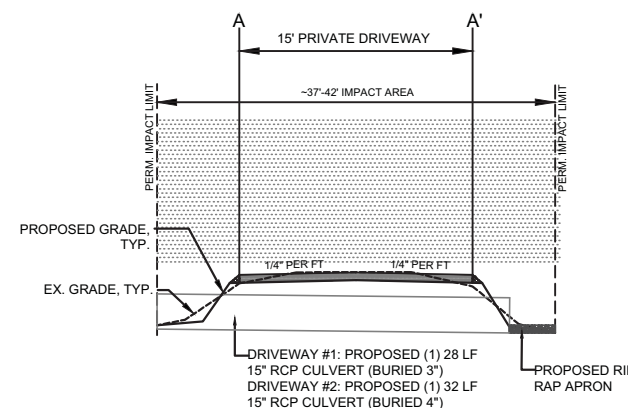

PRIVATE DRIVEWAYS ON TRELLIS ROAD
TYPICAL ROAD CROSS SECTION

NOT TO SCALE

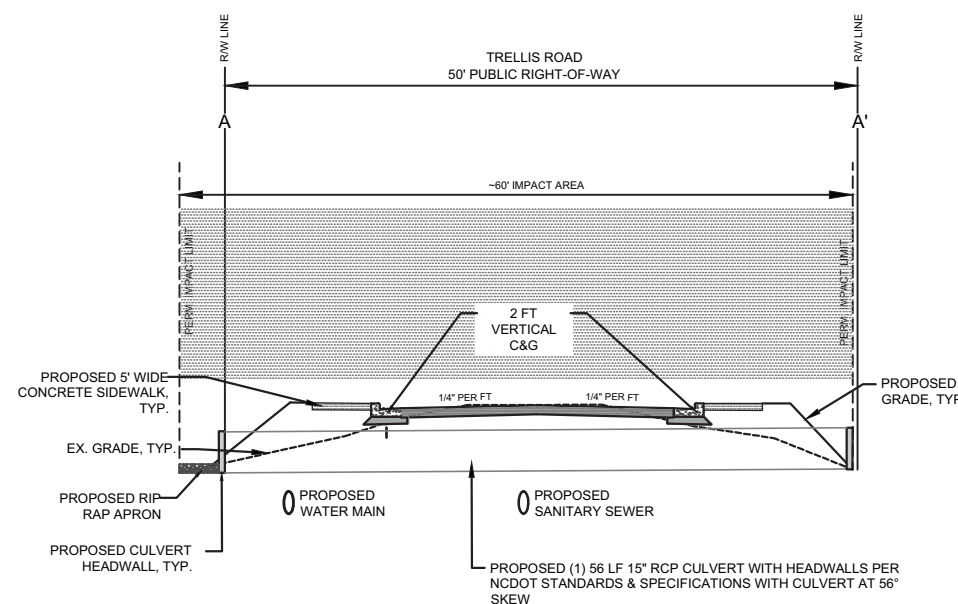

WETLAND IMPACT AREA 'D'
TYP. COLLECTOR STREET - TRELLIS ROAD
ROAD CROSS SECTION

NOT TO SCALE

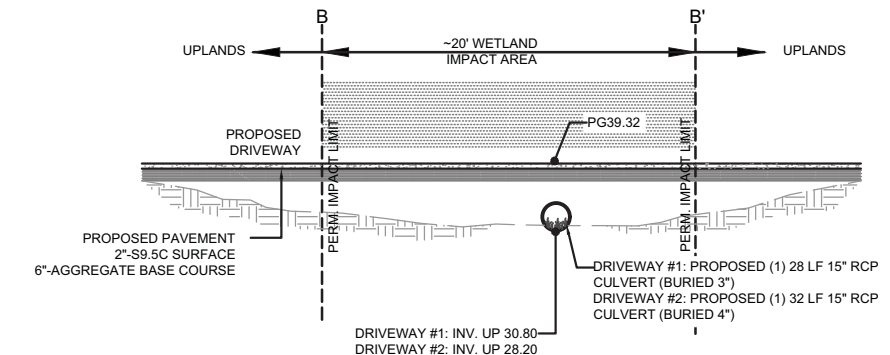

PRIVATE DRIVEWAYS ON TRELLIS ROAD
TYPICAL WETLAND CROSS SECTION

NOT TO SCALE

NOTES

- CROSS SECTION IS FACING DOWNSTREAM (W TO E)
- PROPOSED (1) 41 LF 24" RCP CULVERT WITH HEADWALLS

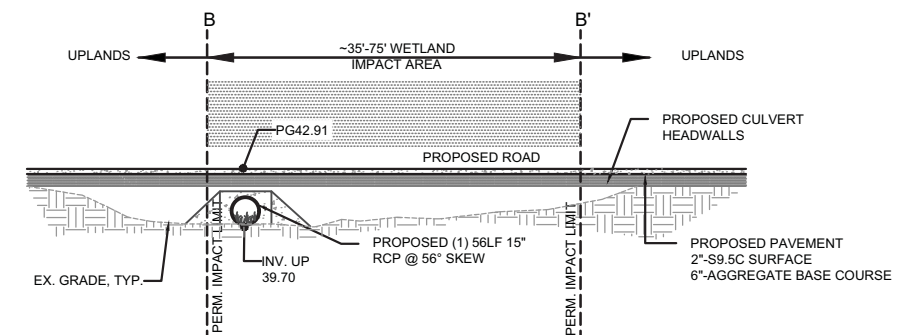

WETLAND IMPACT AREA 'D'
STA. 12+05 TRELLIS ROAD
WETLAND CROSS SECTION

NOT TO SCALE

NOTES

- CROSS SECTION FACING DOWNSTREAM (NE TO SW)
- PROPOSED (1) 56 LF 15" RCP CULVERT AT 56° SKEW

PARAMOUNT
ENGINEERING, INC.

Wilmington, North Carolina 28403
(910) 791-6707 (C) (910) 791-6760 (F)
NC License #: C-2846
Project #: 17180.PE



Scale: 1" = 30' at 22" x 34"
1" = 60' at 11" x 17"

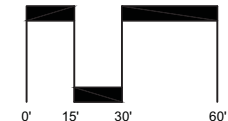

FINAL DESIGN - NOT RELEASED FOR CONSTRUCTION

Wetland Impacts Plan View - EX-4

The Terraces

Town of Surf City, North Carolina

Date: 10.16.2019

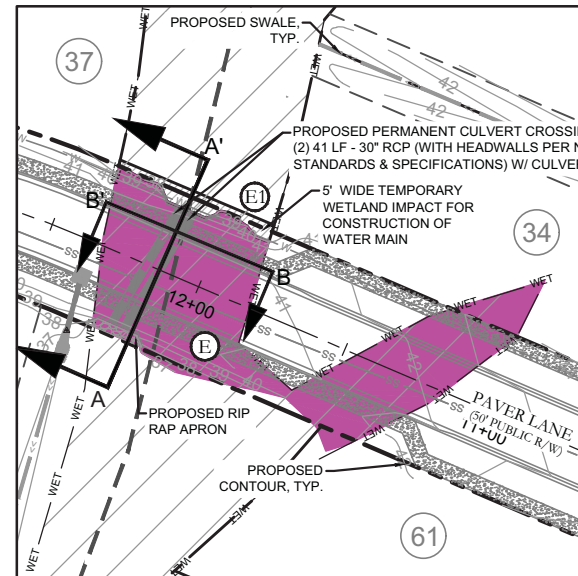

IMPACT AREA 'E'
E = 4,211 SF (0.097 AC.) - PERMANENT
E1 = 218 SF (0.005 AC.) - TEMPORARY

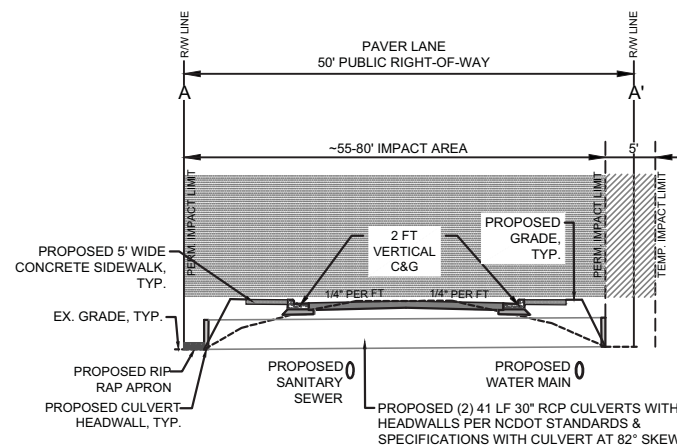

WETLAND IMPACT AREA 'E'
TYP. COLLECTOR STREET - PAVER LANE
ROAD CROSS SECTION
NOT TO SCALE

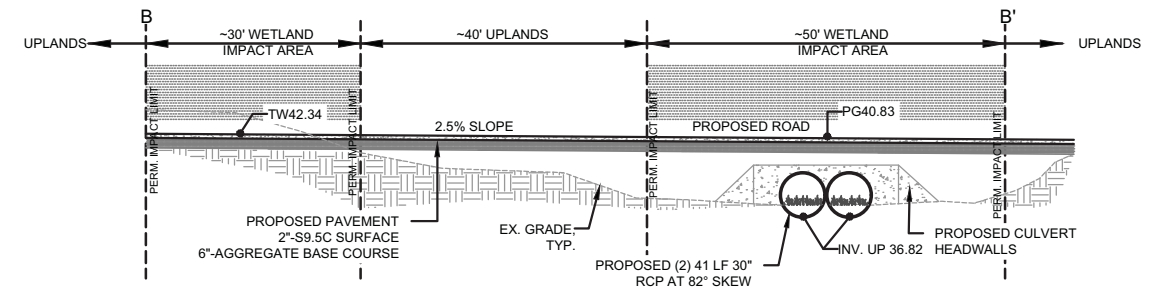

WETLAND IMPACT AREA 'E'
STA. 12+15 PAVER LANE
WETLAND CROSS SECTION
NOT TO SCALE

NOTES
- CROSS SECTION FACING DOWNSTREAM (NE TO SW)
- PROPOSED (2) 41 LF 30" RCP CULVERTS AT 82° SKEW

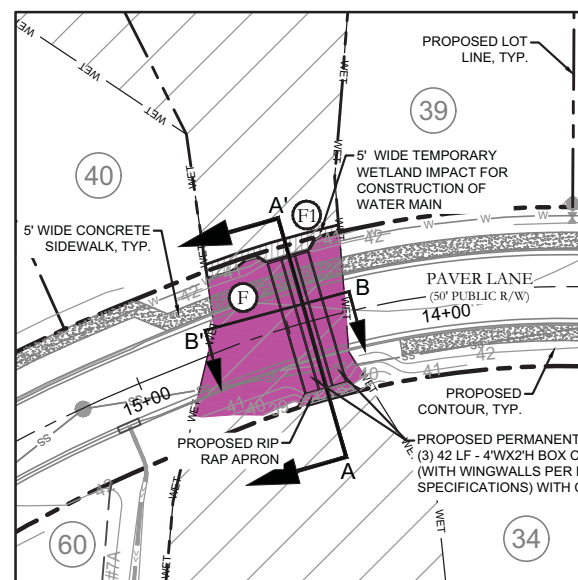

IMPACT AREA 'F'
F = 2,121 SF (0.040 AC.) - PERMANENT
F1 = 179 SF (0.004 AC.) - TEMPORARY

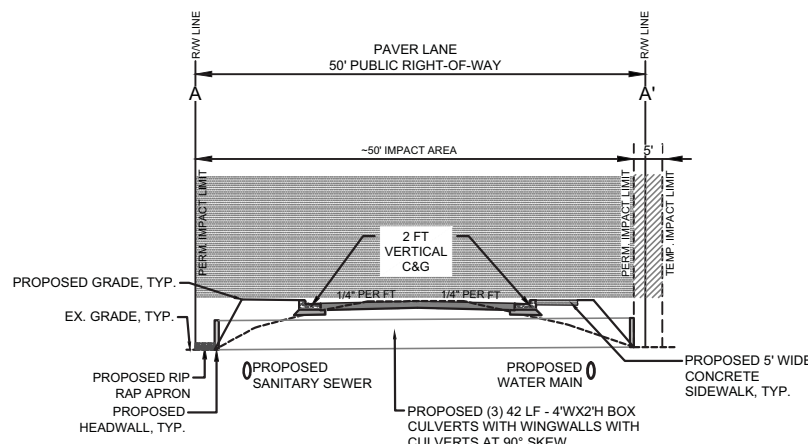

WETLAND IMPACT AREA 'F'
TYP. COLLECTOR STREET - PAVER LANE
ROAD CROSS SECTION
NOT TO SCALE

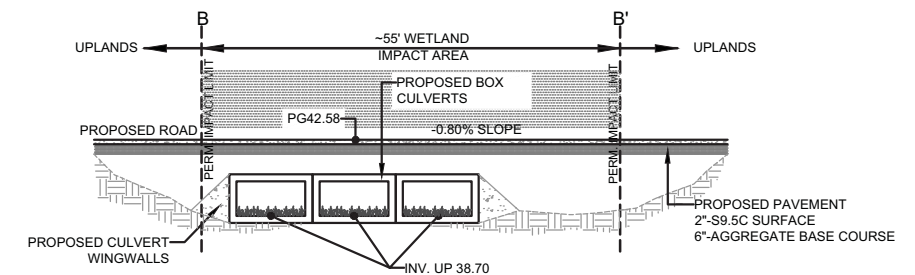

WETLAND IMPACT AREA 'F'
STA. 14+45 PAVER LANE
WETLAND CROSSING - CROSS SECTION
NOT TO SCALE

NOTES
- CROSS SECTION FACING DOWNSTREAM (NW TO SE)
- PROPOSED BOXED CULVERTS (3) 42 LF 4'WX2'H WITH WINGWALLS AT 90° SKEW

LEGEND

	JURISDICTIONAL WETLAND IMPACTS		STREAM		PERMANENT WETLAND IMPACT AREA
	TEMPORARY WETLAND IMPACT		RPW		TEMPORARY WETLAND IMPACT AREA
			STREAM IMPACT		TEMPORARY STREAM IMPACT AREA

PARAMOUNT
ENGINEERING, INC.

Wilmington, North Carolina 28403
(910) 791-6707 (O) (910) 791-6760 (F)
NC License #: C-2846
Project #: 17180.PE

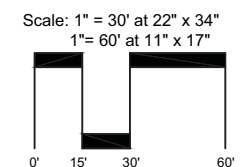

FINAL DESIGN - NOT RELEASED FOR CONSTRUCTION

Wetland Impacts Plan View - EX-5

The Terraces

Town of Surf City, North Carolina

Date: 10.16.2019

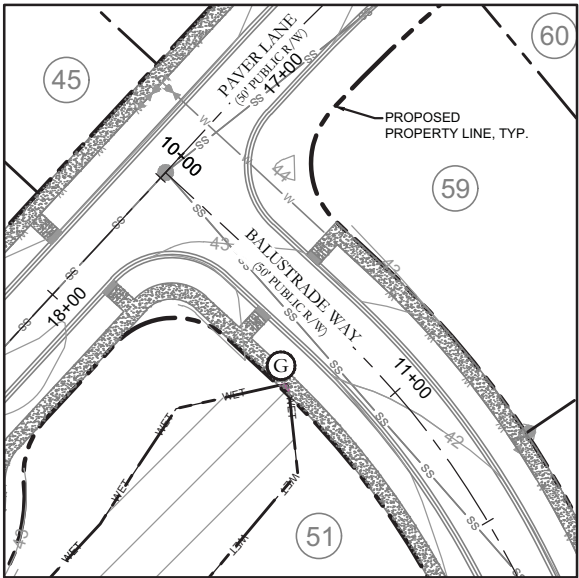

IMPACT AREA 'G'
G = 6 SF (0.0001 AC.)

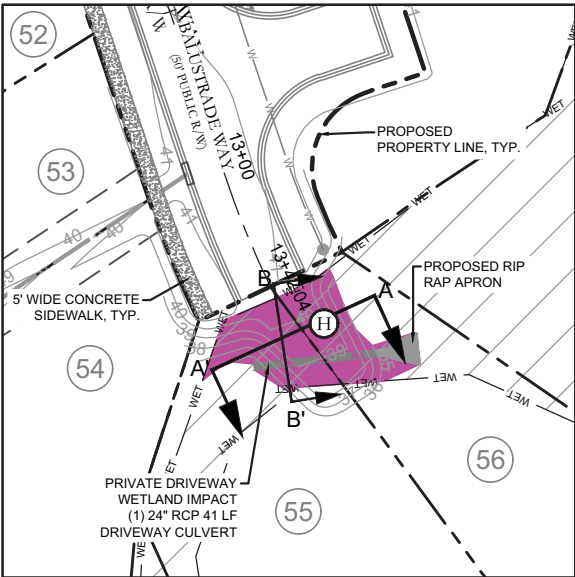

IMPACT AREA 'H'
H = 1,342 SF (0.031 AC.)

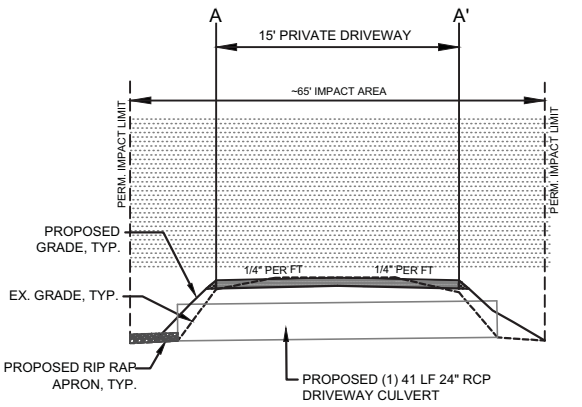



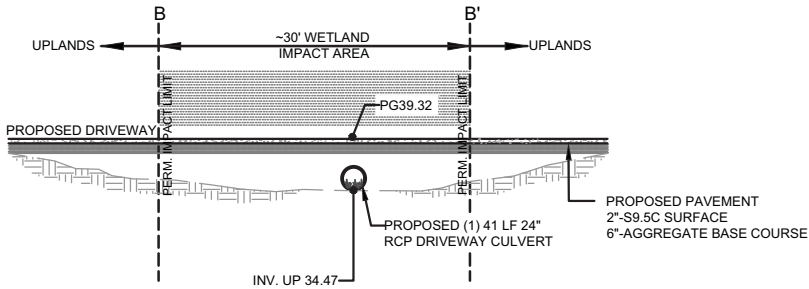





WETLAND IMPACT AREA 'H'
PRIVATE DRIVEWAY AT END OF BALUSTRADE WAY
ROAD CROSS SECTION
NOT TO SCALE



WETLAND IMPACT AREA 'H'
PRIVATE DRIVEWAY ON BALUSTRADE WAY
WETLAND CROSS SECTION
NOT TO SCALE

NOTES
- CROSS SECTION IS FACING DOWNSTREAM (W TO E)
- PROPOSED (1) 41 LF 24" RCP CULVERT WITH HEADWALLS

LEGEND

	JURISDICTIONAL WETLAND IMPACTS		STREAM		PERMANENT WETLAND IMPACT AREA
	TEMPORARY WETLAND IMPACT		RPW		TEMPORARY WETLAND IMPACT AREA
			STREAM IMPACT		TEMPORARY STREAM IMPACT AREA

PARAMOUNTE
ENGINEERING, INC.

Wilmington, North Carolina 28403
(910) 791-6707 (O) (910) 791-6760 (F)
NC License #: C-2846
Project #: 17180.PE

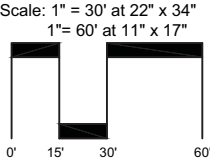

FINAL DESIGN - NOT RELEASED FOR CONSTRUCTION

Wetland Impacts Plan View - EX-6

The Terraces

Town of Surf City, North Carolina

Date: 10.16.2019

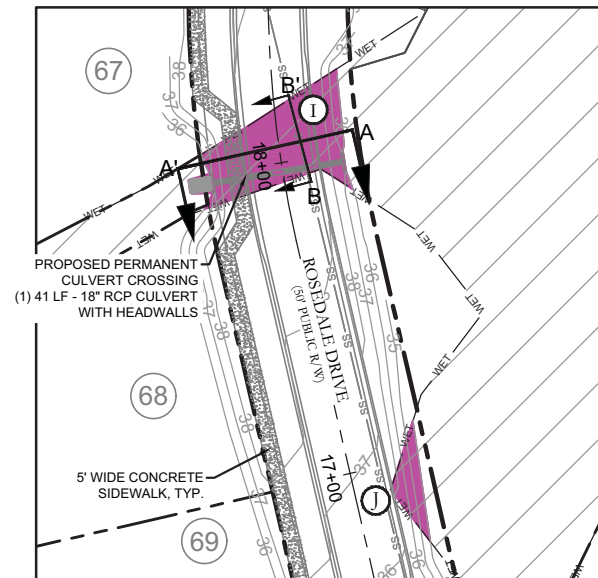

IMPACT AREAS 'I' & 'J'
SCALE: 1"=60' or 1"=30'
I = 1,072 SF (0.025 AC.)
J = 193 SF (0.004 AC.)

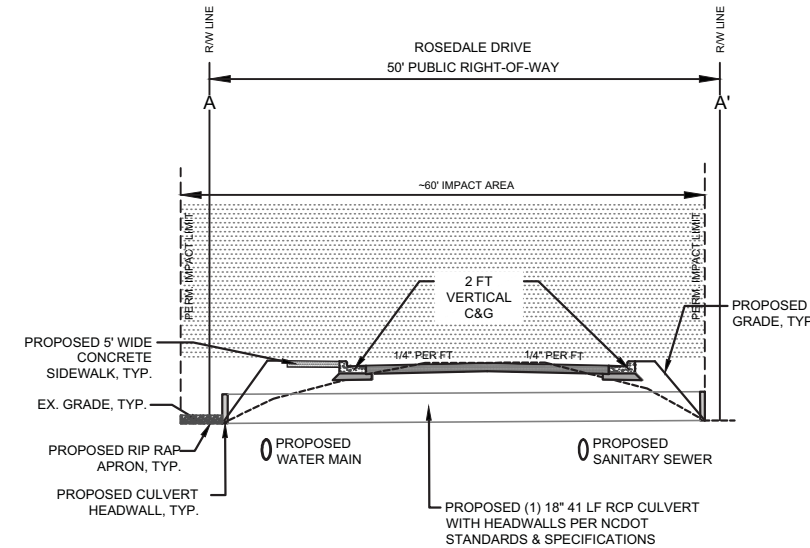

WETLAND IMPACT AREA 'I'
TYP. COLLECTOR STREET - ROSEDALE DRIVE
ROAD CROSS SECTION
NOT TO SCALE

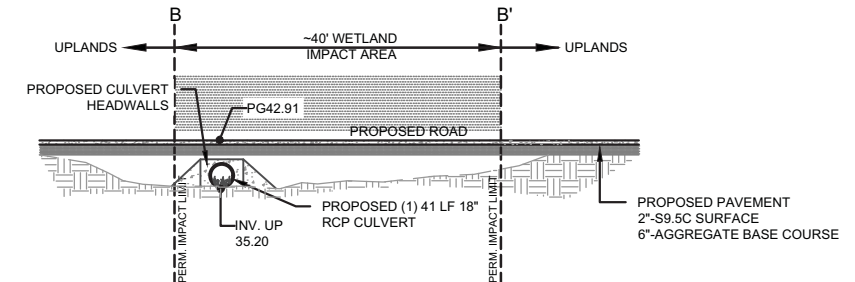

WETLAND IMPACT AREA 'I'
STA. 18+00 ROSEDALE DRIVE
WETLAND CROSS SECTION
NOT TO SCALE

NOTES
- CROSS SECTION FACING DOWNSTREAM (NE TO SW)
- PROPOSED (1) 41 LF 18" RCP CULVERT WITH HEADWALLS

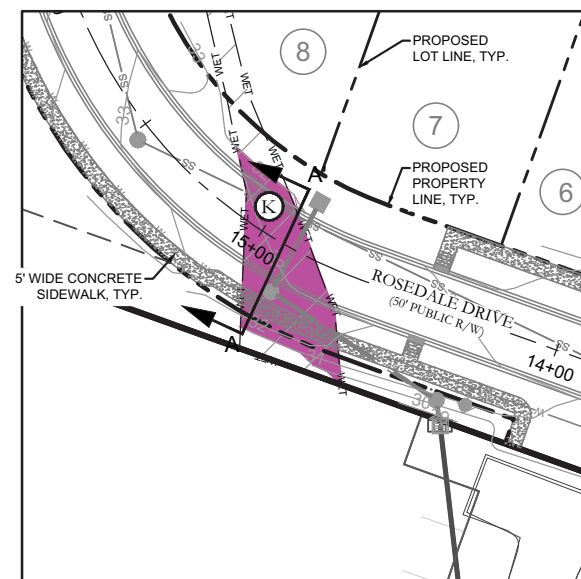

IMPACT AREA 'K'
SCALE: 1"=60' or 1"=30'
IMPACT K = 1,265 SF (0.029 AC.)

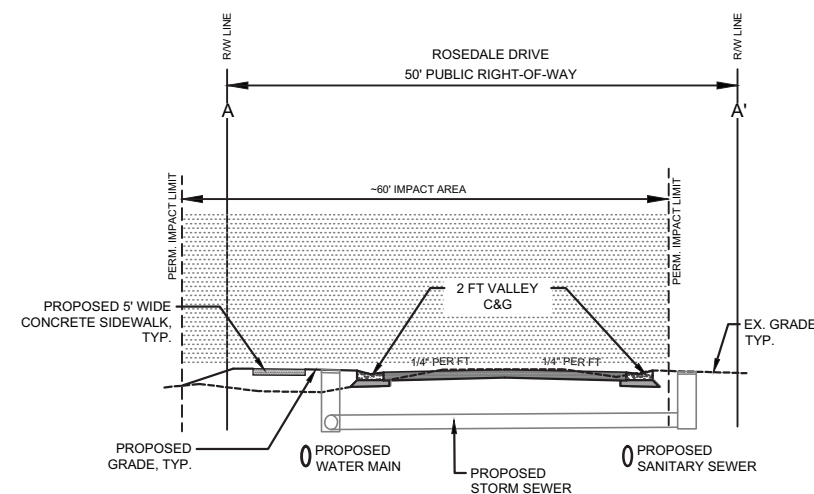

WETLAND IMPACT AREA 'K'
TYP. COLLECTOR STREET - ROSEDALE DRIVE
ROAD CROSS SECTION
NOT TO SCALE

LEGEND			
	JURISDICTIONAL WETLAND IMPACTS		STREAM
	TEMPORARY WETLAND IMPACT		RPW
			STREAM IMPACT
			PERMANENT WETLAND IMPACT AREA
			TEMPORARY WETLAND IMPACT AREA
			TEMPORARY STREAM IMPACT AREA

PARAMOUNT
ENGINEERING, INC.

Wilmington, North Carolina 28403
(910) 791-6707 (C) (910) 791-6760 (F)
NC License #: C-2846
Project #: 17180.PE

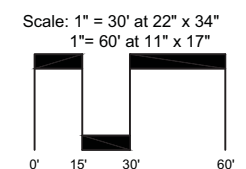

Wetland Impacts Plan View - EX-7

The Terraces

Town of Surf City, North Carolina

Date: 10.16.2019

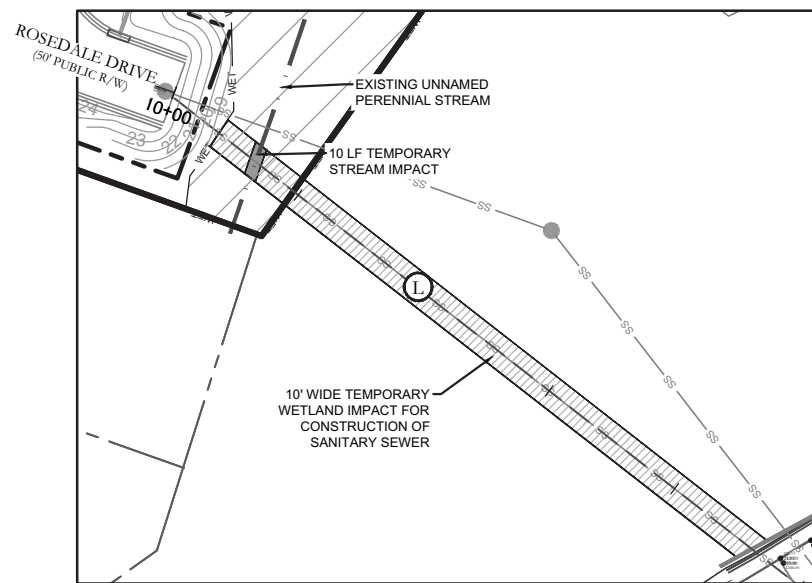



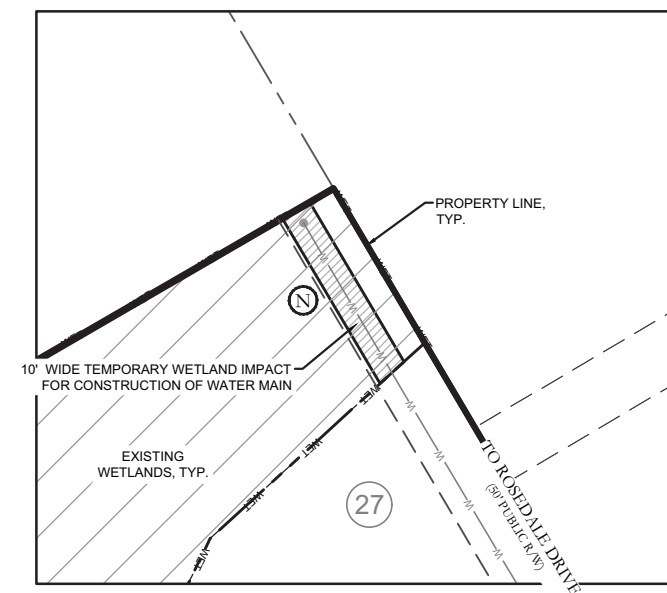





IMPACT AREA 'L'
IMPACT L = 2,124 SF (0.049 AC.) - TEMP.



IMPACT AREA 'N'
IMPACT N = 591 SF (0.014 AC.) - TEMP.

LEGEND

	JURISDICTIONAL WETLAND IMPACTS		STREAM		PERMANENT WETLAND IMPACT AREA
	TEMPORARY WETLAND IMPACT		RPW		TEMPORARY WETLAND IMPACT AREA
			STREAM IMPACT		TEMPORARY STREAM IMPACT AREA

PARAMOUNT
ENGINEERING, INC.

Wilmington, North Carolina 28403
(910) 791-6707 (O) (910) 791-6760 (F)
NC License #: C-2846
Project #: 17180.PE

