

LEGEND

ZONE 1 BUFFER

ZONE 2 BUFFER

IMPACTED WETLAND

STREAM & IMPACT



WETLAND AND STREAM PERMITTING CONSTRUCTION NOTES:

Utility line construction must comply with all regional and general conditions for USACE Nationwide Permit S8 and NC DWR General Certification 4276 (Effective March 25, 2021) including but not limited to:

1. Material resulting from trench excavation may be temporarily placed into waters of the United States for no more than three months, provided the material is not placed in such a manner that it is dispersed by currents or other forces.
2. In wetlands, the top 6 to 12 inches of the trench should normally be backfilled with topsoil from the trench.
3. The trench cannot be constructed or backfilled in such a manner as to drain waters of the United States (e.g., building with extensive gravel layers, creating a French drain effect).
4. Any exposed slopes and stream banks must be stabilized immediately upon completion of the utility line crossing of each wetlands.
5. After construction, temporary fills must be removed in their entirety and the affected areas returned to pre-construction elevations. The areas affected by temporary fills must be revegetated, as appropriate.
6. Access roads used solely for construction of the utility line must be removed upon completion of the work, in accordance with the requirements for temporary fills.
7. Any utility construction that is parallel to a stream or open water shall be no closer than 30 feet to the top of bank or ordinary high-water mark.
8. Where there are temporary or permanent impacts from stream crossings, utility lines shall cross the stream channel at a near-perpendicular direction.
9. Construction conditions in wetlands and/or sensitive stream channels shall be minimized to the maximum extent practicable and shall not exceed 60 feet wide.
10. Construction conditions in wetlands and/or sensitive stream channels shall be minimized to the maximum extent practicable and shall not exceed 60 feet wide.
11. When applicable, all construction activities shall be performed and maintained in full compliance with the Sediment and Pollution Control Act.

NOTES:

- WETLAND, PONDS, AND TRIBUTARIES SHOWN WERE PROVIDED BY WETLAND & WATERS ON JANUARY 3, 2022
- ENVIRONMENTAL INFORMATION SHOWN IS BASED ON FIELD RUN GPS

ROADWAY IMPACTS														
IMPACT #	ZONE 1		ZONE 2		WETLAND		STREAM		BMP BAP	TEMPORARY PUMP		TEMPORARY		TEMPORARY IMPACTS
	S.F.	AC	S.F.	AC	S.F.	AC	S.F.	AC		S.F.	AC	S.F.	AC	
1	1,200	0.00	7,000	0.13	2,000	0.04	300	0.01	0	0.00	0	0.00	0	0.00
2	100	0.00	0	0.00	0	0.00	0	0.00	0	0.00	0	0.00	0	0.00
3	1,200	0.00	7,000	0.13	2,000	0.04	300	0.01	0	0.00	0	0.00	0	0.00
TOTAL	2,500	0.00	14,000	0.26	4,000	0.08	600	0.02	0	0.00	0	0.00	0	0.00

SEWER IMPACTS															
IMPACT #	ZONE 1		ZONE 2		WETLAND		STREAM		BMP BAP	TEMPORARY PUMP		TEMPORARY		TEMPORARY IMPACTS	
	S.F.	AC	S.F.	AC	S.F.	AC	S.F.	AC		S.F.	AC	S.F.	AC		
1	0	0.00	0	0.00	2,000	0.00	0	0.00	0	0.00	0	0.00	0	0.00	
2	1	2310	0.00	3760	0.00	2110	0.00	40	1710	0	0.00	0	0.00	100	0.00
3	0	0.00	0	0.00	0	0.00	0	0.00	0	0.00	0	0.00	0	0.00	
4	500	0.00	2,500	0.00	4,000	0.11	80	35	0	0.00	0	0.00	0	0.00	
5	0	0.00	0	0.00	0	0.00	0	0.00	0	0.00	0	0.00	0	0.00	
6	500	0.00	2,500	0.00	4,000	0.11	80	35	0	0.00	0	0.00	0	0.00	
7	500	0.00	2,500	0.00	4,000	0.11	80	35	0	0.00	0	0.00	0	0.00	
8	500	0.00	2,500	0.00	4,000	0.11	80	35	0	0.00	0	0.00	0	0.00	
9	500	0.00	2,500	0.00	4,000	0.11	80	35	0	0.00	0	0.00	0	0.00	
10	500	0.00	2,500	0.00	4,000	0.11	80	35	0	0.00	0	0.00	0	0.00	
11	500	0.00	2,500	0.00	4,000	0.11	80	35	0	0.00	0	0.00	0	0.00	
12	500	0.00	2,500	0.00	4,000	0.11	80	35	0	0.00	0	0.00	0	0.00	
13	500	0.00	2,500	0.00	4,000	0.11	80	35	0	0.00	0	0.00	0	0.00	
14	500	0.00	2,500	0.00	4,000	0.11	80	35	0	0.00	0	0.00	0	0.00	
15	500	0.00	2,500	0.00	4,000	0.11	80	35	0	0.00	0	0.00	0	0.00	
16	500	0.00	2,500	0.00	4,000	0.11	80	35	0	0.00	0	0.00	0	0.00	
17	500	0.00	2,500	0.00	4,000	0.11	80	35	0	0.00	0	0.00	0	0.00	
18	500	0.00	2,500	0.00	4,000	0.11	80	35	0	0.00	0	0.00	0	0.00	
19	500	0.00	2,500	0.00	4,000	0.11	80	35	0	0.00	0	0.00	0	0.00	
20	500	0.00	2,500	0.00	4,000	0.11	80	35	0	0.00	0	0.00	0	0.00	
21	500	0.00	2,500	0.00	4,000	0.11	80	35	0	0.00	0	0.00	0	0.00	
22	500	0.00	2,500	0.00	4,000	0.11	80	35	0	0.00	0	0.00	0	0.00	
23	500	0.00	2,500	0.00	4,000	0.11	80	35	0	0.00	0	0.00	0	0.00	
24	500	0.00	2,500	0.00	4,000	0.11	80	35	0	0.00	0	0.00	0	0.00	
25	500	0.00	2,500	0.00	4,000	0.11	80	35	0	0.00	0	0.00	0	0.00	
26	500	0.00	2,500	0.00	4,000	0.11	80	35	0	0.00	0	0.00	0	0.00	
27	500	0.00	2,500	0.00	4,000	0.11	80	35	0	0.00	0	0.00	0	0.00	
28	500	0.00	2,500	0.00	4,000	0.11	80	35	0	0.00	0	0.00	0	0.00	
29	500	0.00	2,500	0.00	4,000	0.11	80	35	0	0.00	0	0.00	0	0.00	
30	500	0.00	2,500	0.00	4,000	0.11	80	35	0	0.00	0	0.00	0	0.00	
31	500	0.00	2,500	0.00	4,000	0.11	80	35	0	0.00	0	0.00	0	0.00	
32	500	0.00	2,500	0.00	4,000	0.11	80	35	0	0.00	0	0.00	0	0.00	
33	500	0.00	2,500	0.00	4,000	0.11	80	35	0	0.00	0	0.00	0	0.00	
34	500	0.00	2,500	0.00	4,000	0.11	80	35	0	0.00	0	0.00	0	0.00	
35	500	0.00	2,500	0.00	4,000	0.11	80	35	0	0.00	0	0.00	0	0.00	
36	500	0.00	2,500	0.00	4,000	0.11	80	35	0	0.00	0	0.00	0	0.00	
37	500	0.00	2,500	0.00	4,000	0.11	80	35	0	0.00	0	0.00	0	0.00	
38	500	0.00	2,500	0.00	4,000	0.11	80	35	0	0.00	0	0.00	0	0.00	
39	500	0.00	2,500	0.00	4,000	0.11	80	35	0	0.00	0	0.00	0	0.00	
40	500	0.00	2,500	0.00	4,000	0.11	80	35	0	0.00	0	0.00	0	0.00	
41	500	0.00	2,500	0.00	4,000	0.11	80	35	0	0.00	0	0.00	0	0.00	
42	500	0.00	2,500	0.00	4,000	0.11	80	35	0	0.00	0	0.00	0	0.00	
43	500	0.00	2,500	0.00	4,000	0.11	80	35	0	0.00	0	0.00	0	0.00	
44	500	0.00	2,500	0.00	4,000	0.11	80	35	0	0.00	0	0.00	0	0.00	
45	500	0.00	2,500	0.00	4,000	0.11	80	35	0	0.00	0	0.00	0	0.00	
46	500	0.00	2,500	0.00	4,000	0.11	80	35	0	0.00	0	0.00	0	0.00	
47	500	0.00	2,500	0.00	4,000	0.11	80	35	0	0.00	0	0.00	0	0.00	
48	500	0.00	2,500	0.00	4,000	0.11	80	35	0	0.00	0	0.00	0	0.00	
49	500	0.00	2,500	0.00	4,000	0.11	80	35	0	0.00	0	0.00	0	0.00	
50	500	0.00	2,500	0.00	4,000	0.11	80	35	0	0.00	0	0.00	0	0.00	
51	500	0.00	2,500	0.00	4,000	0.11	80	35	0	0.00	0	0.00	0	0.00	
52	500	0.00	2,500	0.00	4,000	0.11	80	35	0	0.00	0	0.00	0	0.00	
53	500	0.00	2,500	0.00	4,000	0.11	80	35	0	0.00	0	0.00	0	0.00	
54	500	0.00	2,500	0.00	4,000	0.11	80	35	0	0.00	0	0.00	0	0.00	
55	500	0.00	2,500	0.00	4,000	0.11	80	35	0	0.00	0	0.00	0	0.00	
56	500	0.00	2,500	0.00	4,000	0.11	80	35	0	0.00	0	0.00	0	0.00	
57	500	0.00	2,500	0.00	4,000	0.11	80	35	0	0.00	0	0.00	0	0.00	
58	500	0.00	2,500	0.00	4,000	0.11	80	35	0	0.00	0	0.00	0	0.00	
59	500	0.00	2,500	0.00	4,000	0.11	80	35	0	0.00	0	0.00	0	0.00	
60	500	0.00	2,500	0.00	4,000	0.11	80	35	0	0.00	0	0.00	0	0.00	
61	500	0.00	2,500	0.00	4,000	0.11	80	35	0	0.00	0	0.00	0	0.00	
62	500	0.00	2,500	0.00	4,000	0.11	80	35	0	0.00	0	0.00	0	0.00	
63	500	0.00	2,500	0.00	4,000	0.11	80	35	0	0.00	0	0.00	0	0.00	
64	500	0.00	2,500	0.00	4,000	0.11	80	35	0	0.00	0	0.00	0	0.00	
65	500	0.00	2,500	0.00	4,000	0.11	80	35	0	0.00	0	0.00	0	0.00	
66	500	0.00	2,500	0.00	4,000	0.11	80	35	0	0.00	0	0.00	0	0.00	
67	500	0.00	2,500	0.00	4,000	0.11	80	35	0	0.00	0	0.00	0	0.00	
68	500	0.00	2,500	0.00	4,000	0.11	80	35	0	0.00	0	0.00	0	0.00	
69	500	0.00	2,500	0.00	4,000	0.11	80	35	0	0.00	0	0.00	0	0.00	
70	500	0.00	2,500	0.00	4,000	0.11	80	35	0	0.00	0	0.00	0	0.00	
71	500	0.00	2,500	0.00	4,000	0.11	80	35	0	0.00	0	0.00	0	0.00	
72	500	0.00	2,500	0.00	4,000	0.11	80	35	0	0.00	0	0.00	0	0.00	
73	500	0.00	2,500	0.00	4,000	0.11	80	35	0	0.00	0	0.00	0	0.00	
74	500	0.00	2,500	0.00	4,000	0.11	80	35	0	0.00	0	0.00	0	0.00	
75	500	0.00	2,500	0.00	4,000	0.11	80	35	0	0.00	0	0.00	0	0.00	
76	500	0.00	2,500	0.00	4,000	0.11	80	35	0	0.00	0	0.00	0	0.00	
77	500	0.00	2,500	0.00	4,000	0.11	80	35	0	0.00	0	0.00	0	0.00	
78	500	0.00	2,500	0.00	4,000	0.11	80	35	0	0.00	0	0.00	0	0.00	
79	500	0.00	2,500	0.00	4,000	0.11	80	35	0	0.00	0	0.00	0	0.00	
80	500	0.00	2,500	0.00	4,000	0.11	80	35	0	0.00	0	0.00	0	0.00	
81	500	0.00	2,500	0.00	4,000	0.11	80	35	0	0.00	0	0.00	0	0.00	
82	500	0.00	2,500	0.00	4,000	0.11	80	35	0	0.00	0	0.00	0	0.00	
83	500	0.00	2,500	0.00	4,000	0.11	80	35	0	0.00	0	0.00	0	0.00	
84	500	0.00	2,500	0.00	4,000	0.11	80	35	0	0.00	0	0.00	0	0.00	
85	500	0.00	2,500	0.00	4,000	0.11	80	35	0	0.00	0	0.00	0	0.00	
86	500	0.00	2,500	0.00	4,000	0.11	80	35	0	0.00	0	0.00	0	0.00	
87	500	0.00	2,500	0.00	4,000	0.11	80	35	0	0.00	0	0.00	0	0.00	
88	500	0.00	2,500	0.00	4,000	0.11	80	35	0	0.00	0	0.00	0	0.00	
89	500	0.00	2,500	0.00	4,000	0.11	80	35	0	0.00	0	0.00	0	0.00	
90	500	0.00	2,500	0.00	4,000	0.11	80	35	0	0.00	0	0.00	0	0.00	
91	500	0.00	2,500	0.00	4,000	0.11	80	35	0	0.00	0	0.00	0	0.00	
92	500	0.00	2,500	0.00	4,000	0.11	80	35	0	0.00	0	0.00	0	0	

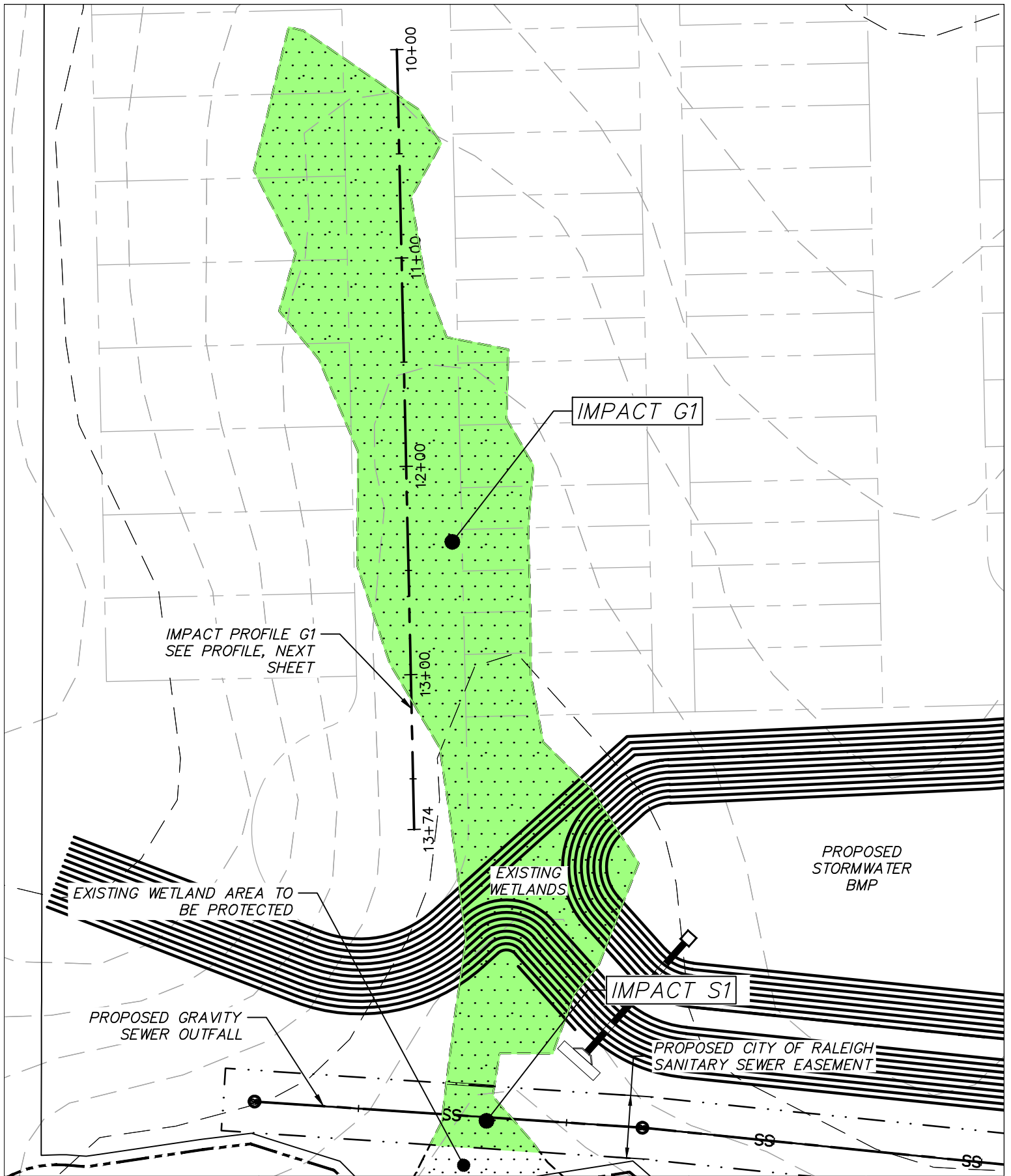

1730 Varsity Drive, Suite 500
Raleigh, North Carolina 27606
O: 919.233.8091 F: 919.233.8031

Wetland Impact Map Impact G1 & S1

Ammons Property

Scale: 1"=60'

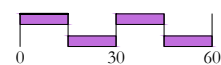

Date:
August 17, 2022



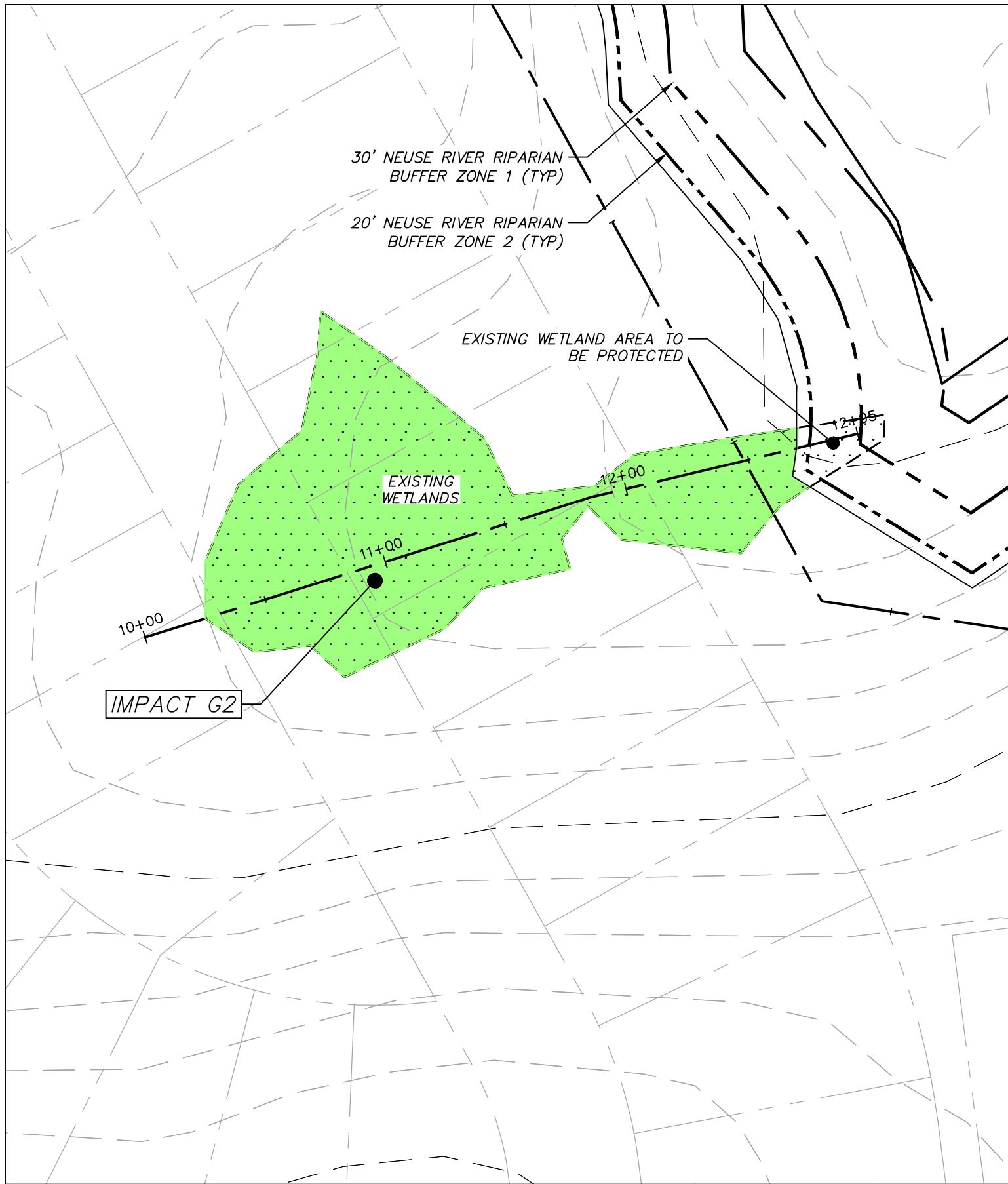

1730 Varsity Drive, Suite 500
Raleigh, North Carolina 27606
O: 919.233.8091 F: 919.233.8031

Wetland Impact Map Impact G2

Ammons Property

Scale: 1"=50'

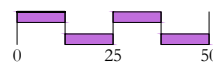

Date:
August 17, 2022



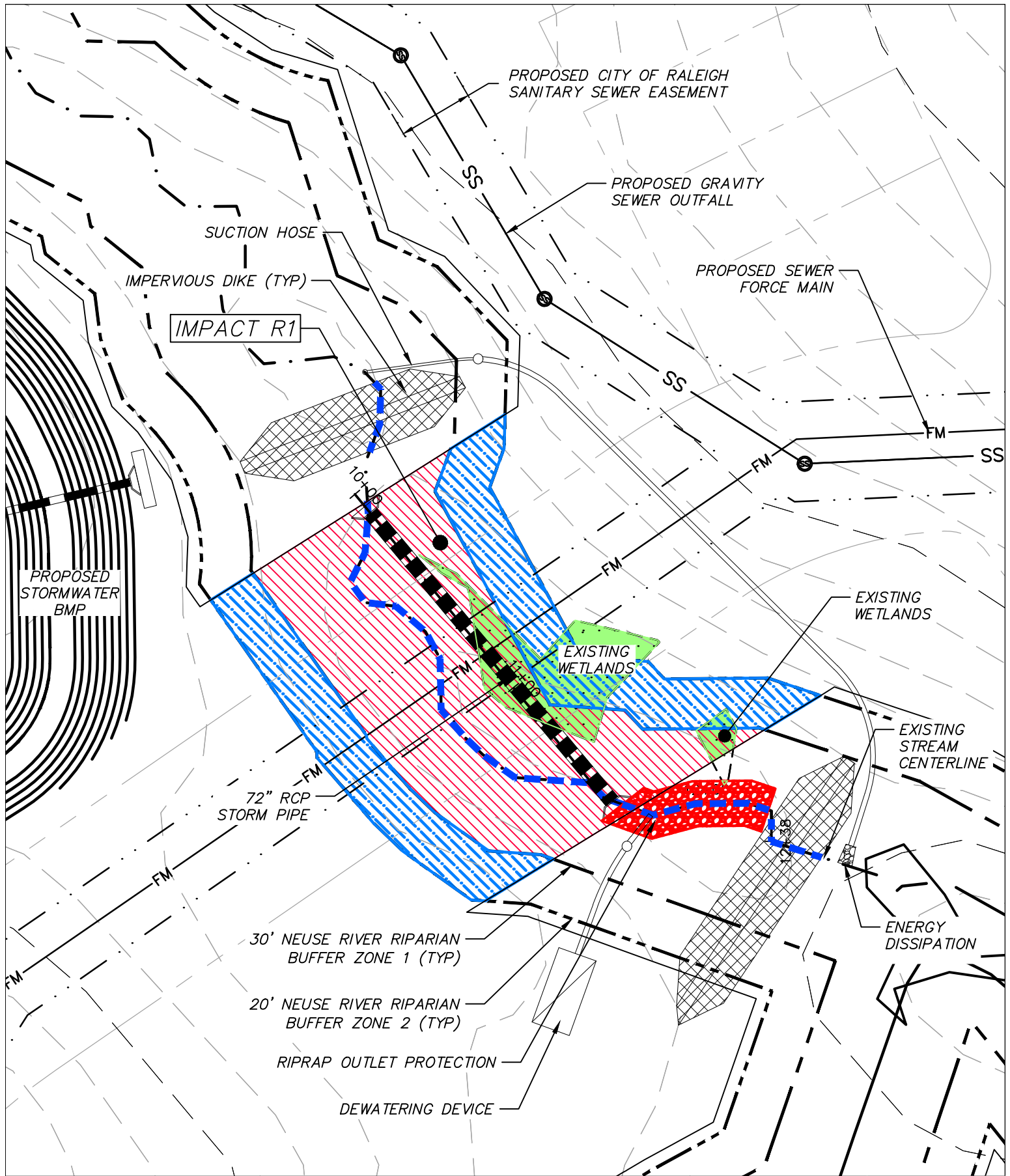

1730 Varsity Drive, Suite 500
 Raleigh, North Carolina 27606
 O: 919.233.8091 F: 919.233.8031

Wetland Impact Map Impact R1

Ammons Property

Scale: 1"=50'

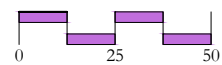

Date:
August 17, 2022



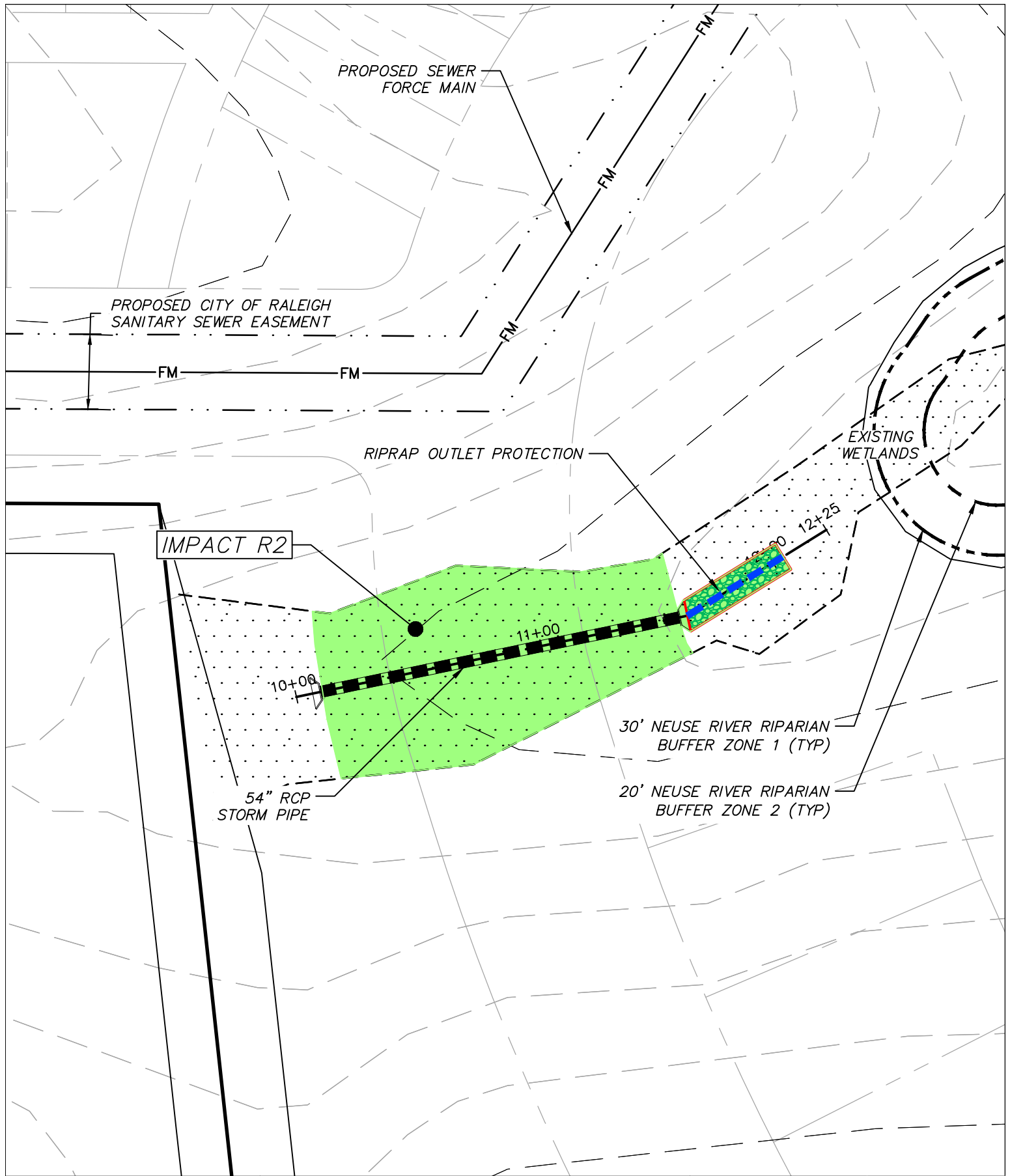

1730 Varsity Drive, Suite 500
Raleigh, North Carolina 27606
O: 919.233.8091 F: 919.233.8031

Wetland Impact Map Impact R2

Ammons Property

Scale: 1"=50'

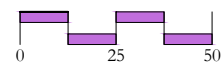

Date:
August 17, 2022



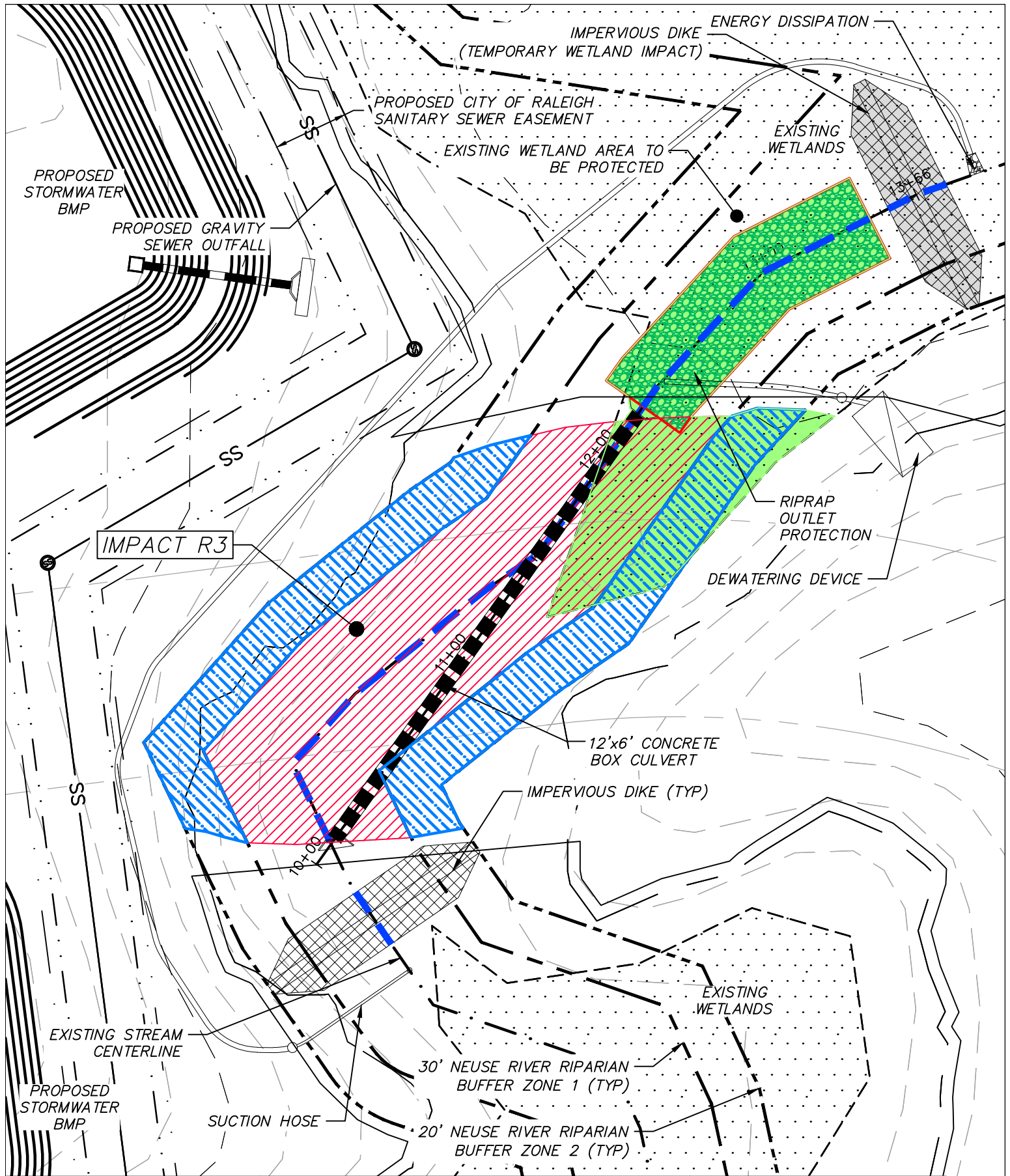

MCKIM & CREED
 1730 Varsity Drive, Suite 500
 Raleigh, North Carolina 27606
 O: 919.233.8091 F: 919.233.8031

Wetland Impact Map
Impact R3
Ammons Property

Scale: 1"=50'

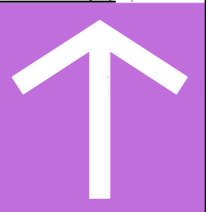
 Date:
 August 17, 2022

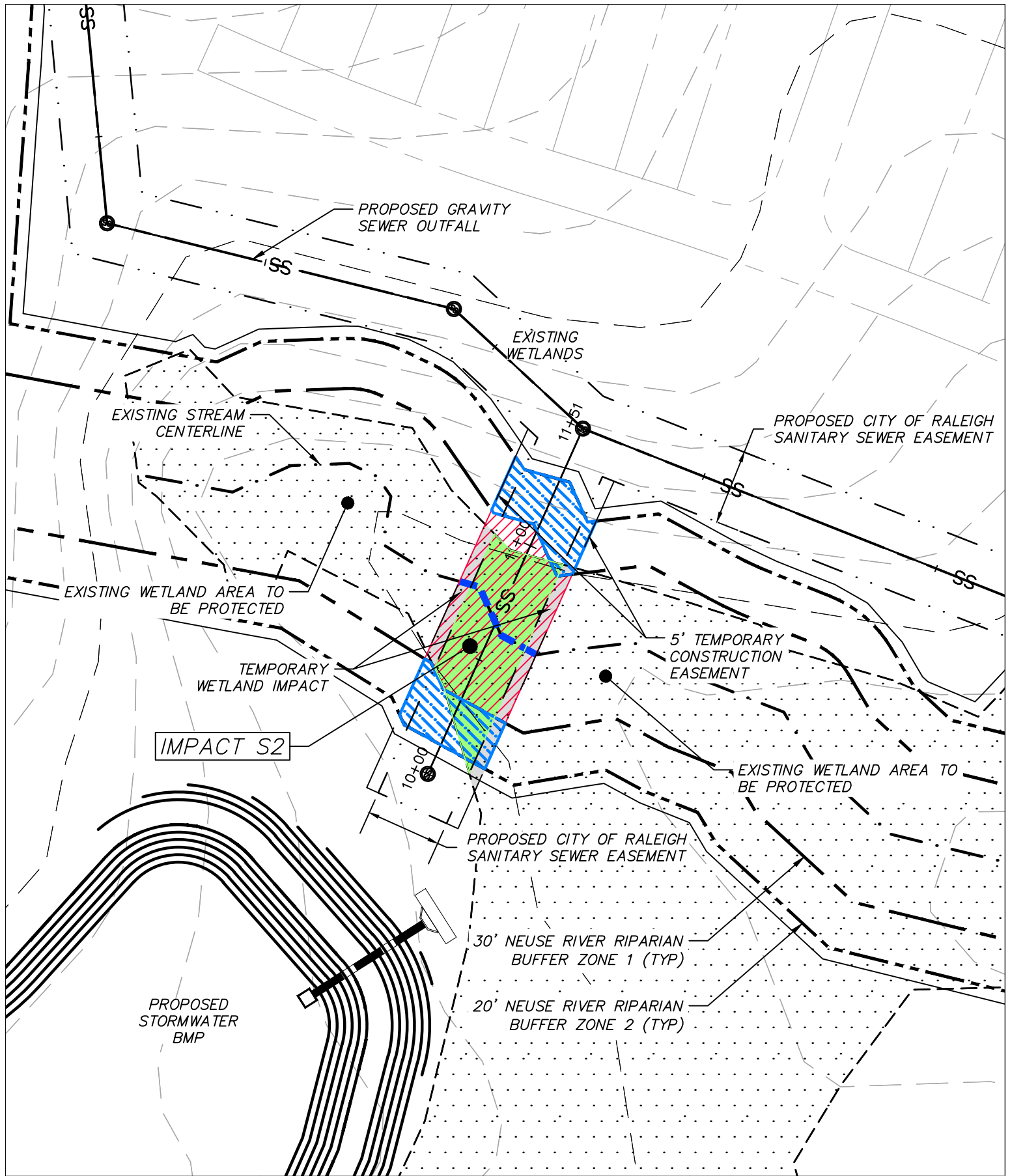



MCKIM & CREED
 1730 Varsity Drive, Suite 500
 Raleigh, North Carolina 27606
 O: 919.233.8091 F: 919.233.8031

Wetland Impact Map Impact S2

Ammons Property

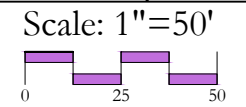

Date:
 August 17, 2022

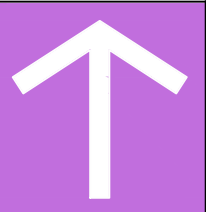

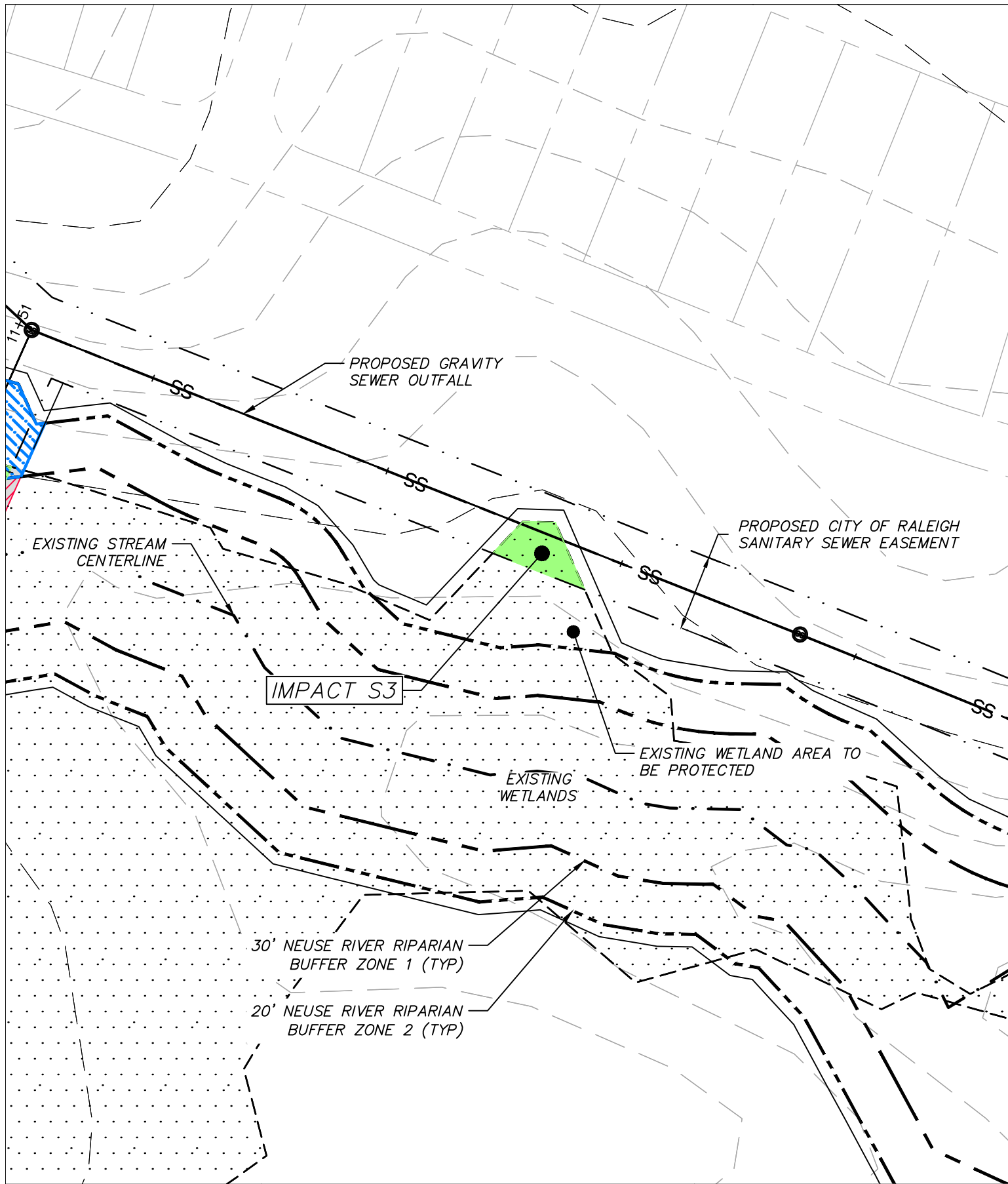

1730 Varsity Drive, Suite 500
Raleigh, North Carolina 27606
O: 919.233.8091 F: 919.233.8031

Wetland Impact Map Impact S3

Ammons Property

Scale: 1"=50'

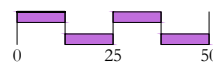

Date:
August 17, 2022



NOTE: CROSSING REQUIRES THE CONSTRUCTION OF A 60' WIDE TEMPORARY CAUSEWAY FOR THE SAFE CONSTRUCTION OF THE UTILITY LINE. TEMPORARY FILLS WILL NOT OBSTRUCT FLOWS AND WILL BE REMOVED WITHIN 90 DAYS OF THE START OF CONSTRUCTION. PRE-EXISTING CONTOURS WILL BE REESTABLISHED WITH WETLAND VEGETATION.

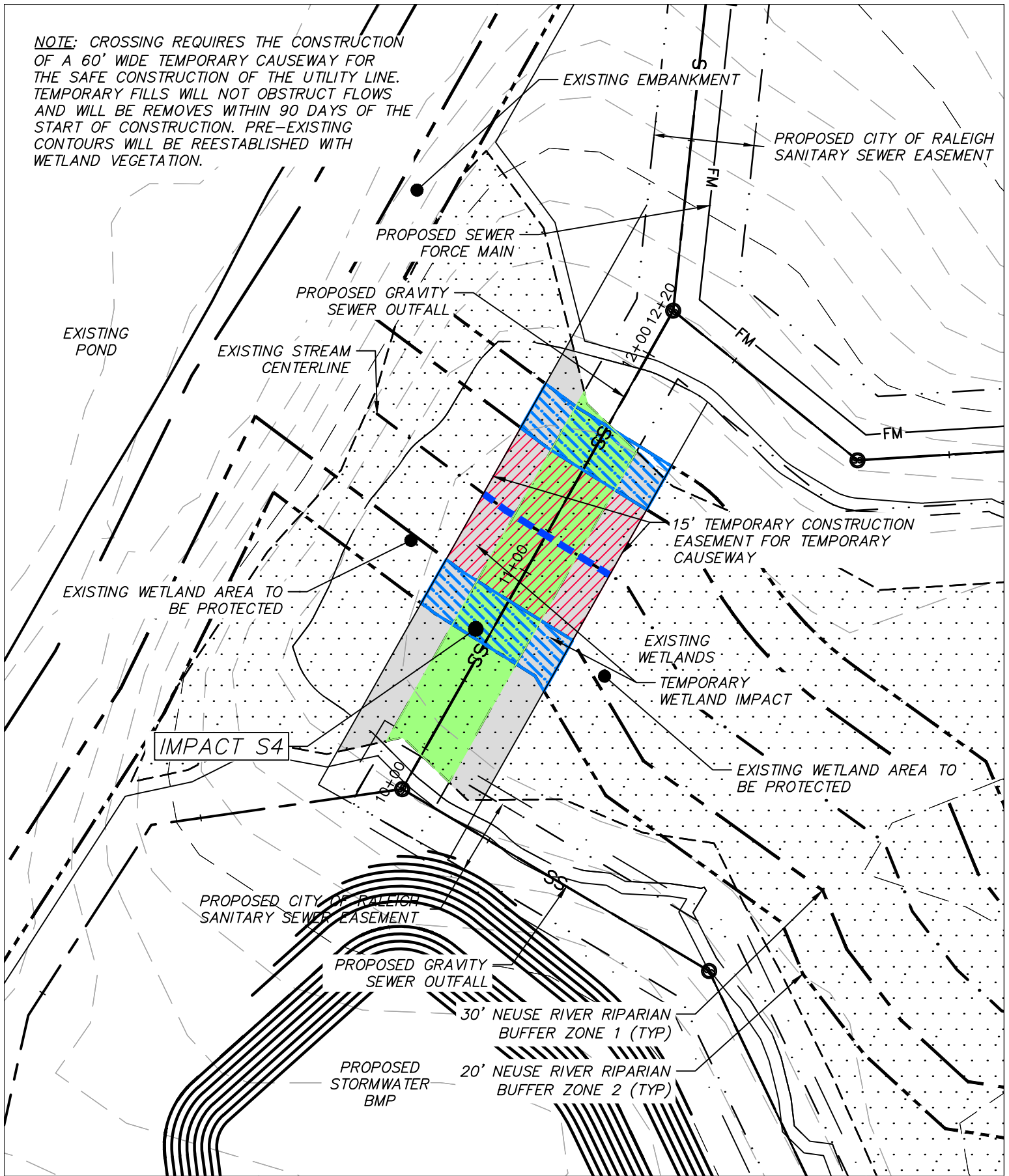

1730 Varsity Drive, Suite 500
Raleigh, North Carolina 27606
O: 919.233.8091 F: 919.233.8031

Wetland Impact Map Impact S4

Ammons Property

Scale: 1"=50'



Date:
August 17, 2022



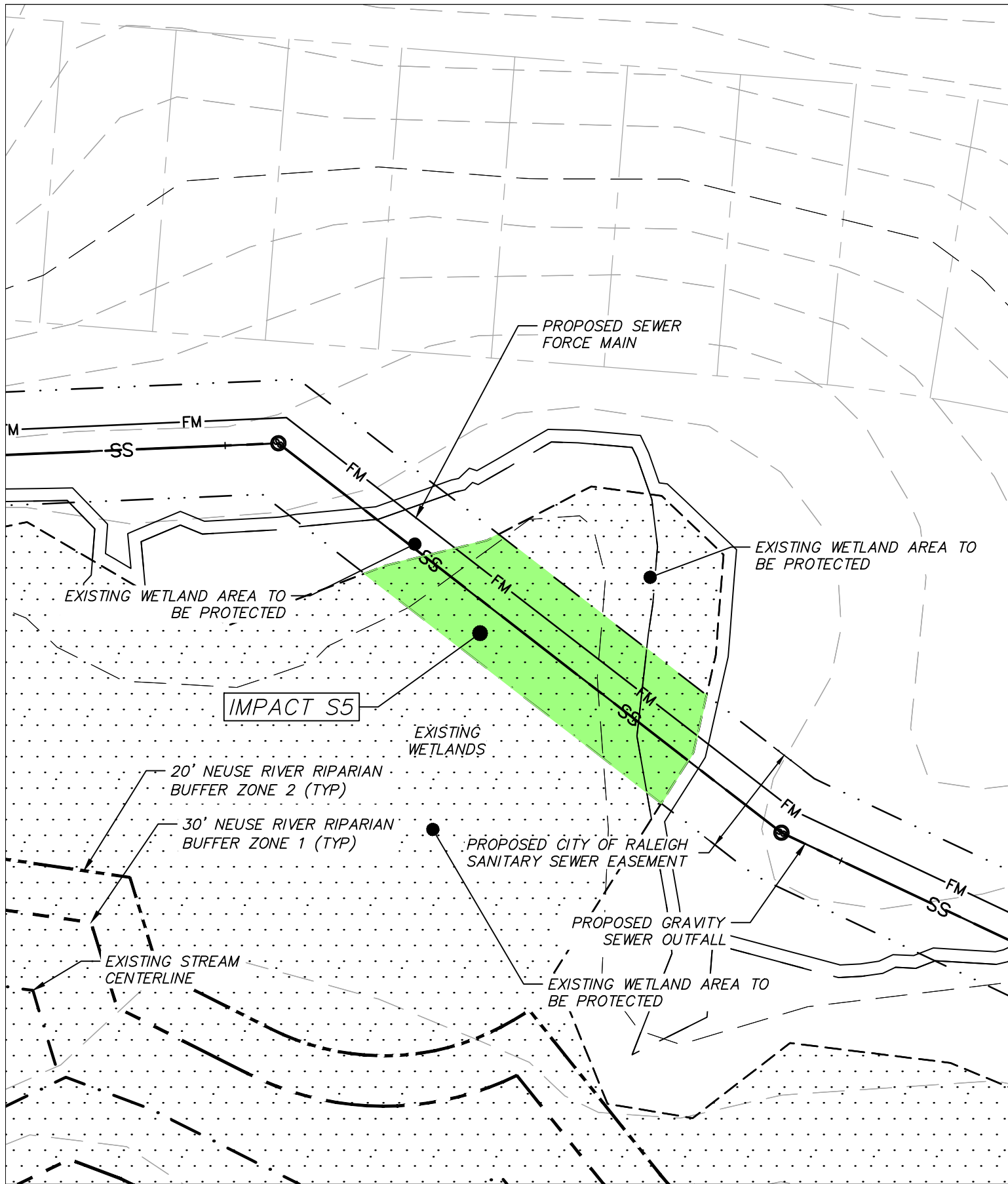

1730 Varsity Drive, Suite 500
 Raleigh, North Carolina 27606
 O: 919.233.8091 F: 919.233.8031

Wetland Impact Map Impact S5

Ammons Property

Scale: 1"=50'

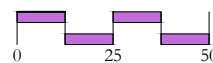

Date:
August 17, 2022



NOTE: CROSSING REQUIRES THE CONSTRUCTION OF A 60' WIDE TEMPORARY CAUSEWAY FOR THE SAFE CONSTRUCTION OF THE UTILITY LINE. TEMPORARY FILLS WILL NOT OBSTRUCT FLOWS AND WILL BE REMOVED WITHIN 90 DAYS OF THE START OF CONSTRUCTION. PRE-EXISTING CONTOURS WILL BE REESTABLISHED WITH WETLAND VEGETATION.

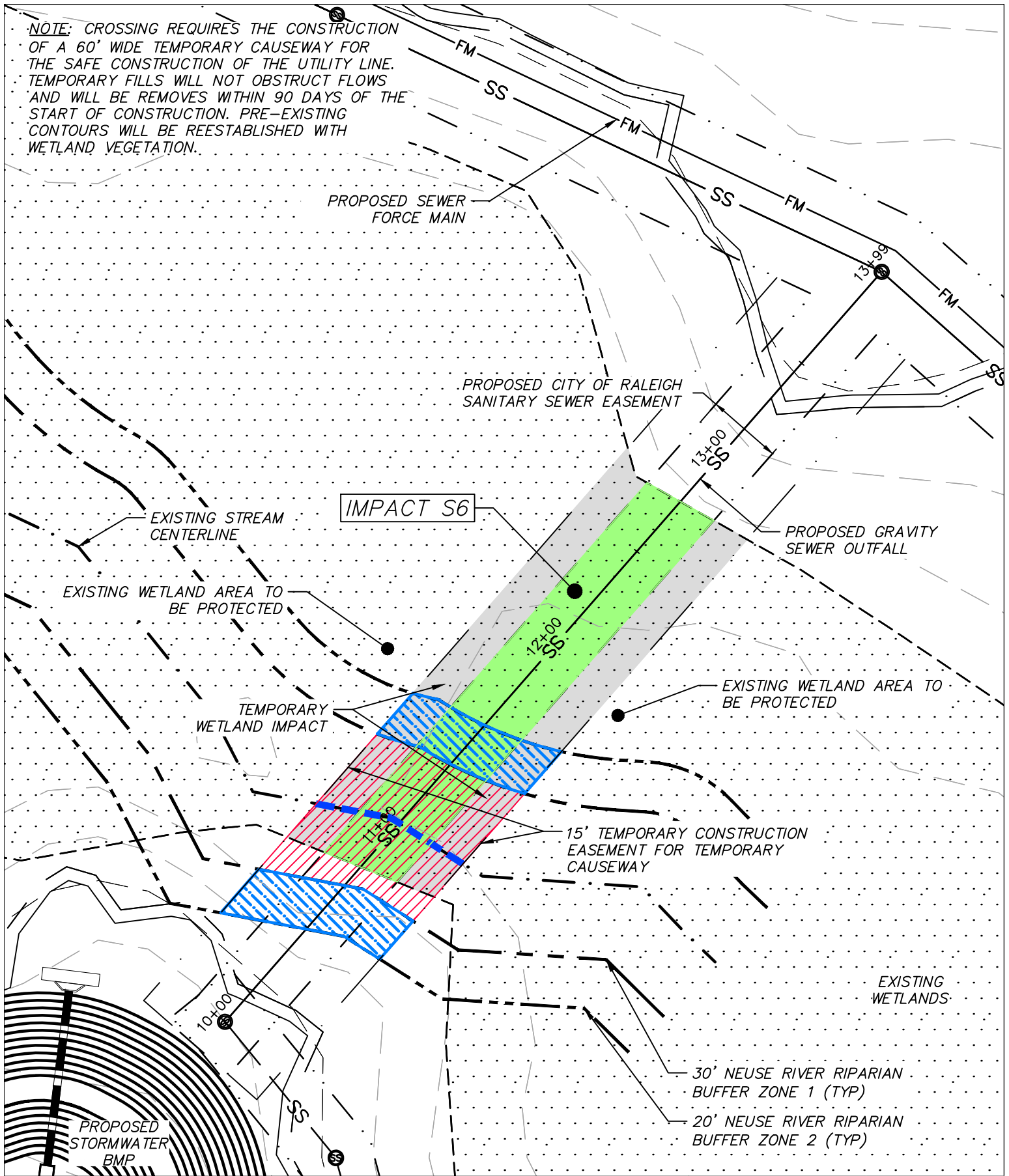

1730 Varsity Drive, Suite 500
Raleigh, North Carolina 27606
O: 919.233.8091 F: 919.233.8031

Wetland Impact Map Impact S6

Ammons Property

Scale: 1"=50'



Date:
August 17, 2022



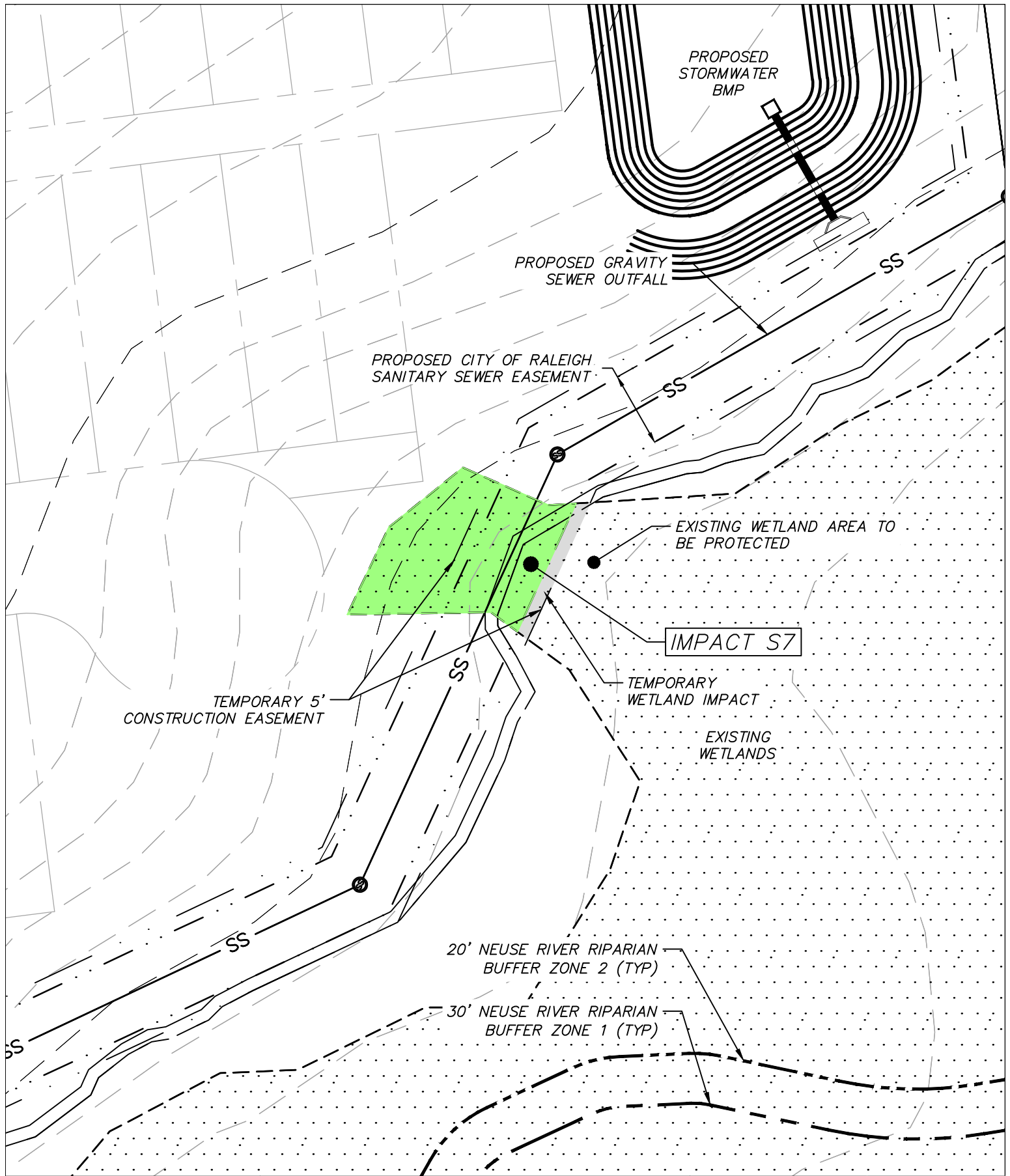

1730 Varsity Drive, Suite 500
Raleigh, North Carolina 27606
O: 919.233.8091 F: 919.233.8031

Wetland Impact Map Impact S7

Ammons Property

Scale: 1"=50'

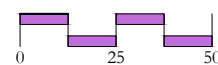

Date:
August 17, 2022



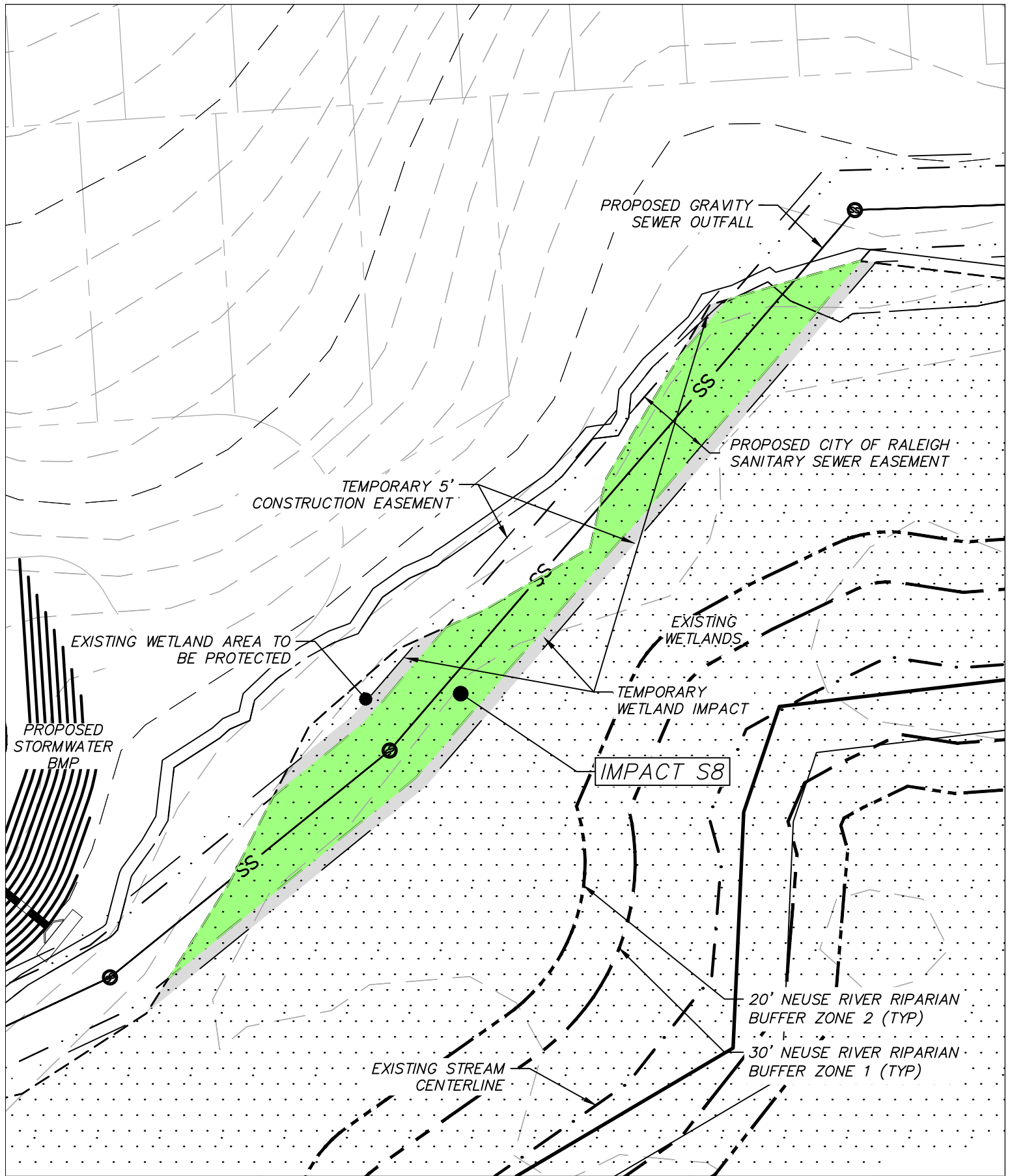

1730 Varsity Drive, Suite 500
Raleigh, North Carolina 27606
O: 919.233.8091 F: 919.233.8031

Wetland Impact Map Impact S8

Ammons Property

Scale: 1"=50'

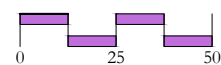

Date:
August 17, 2022



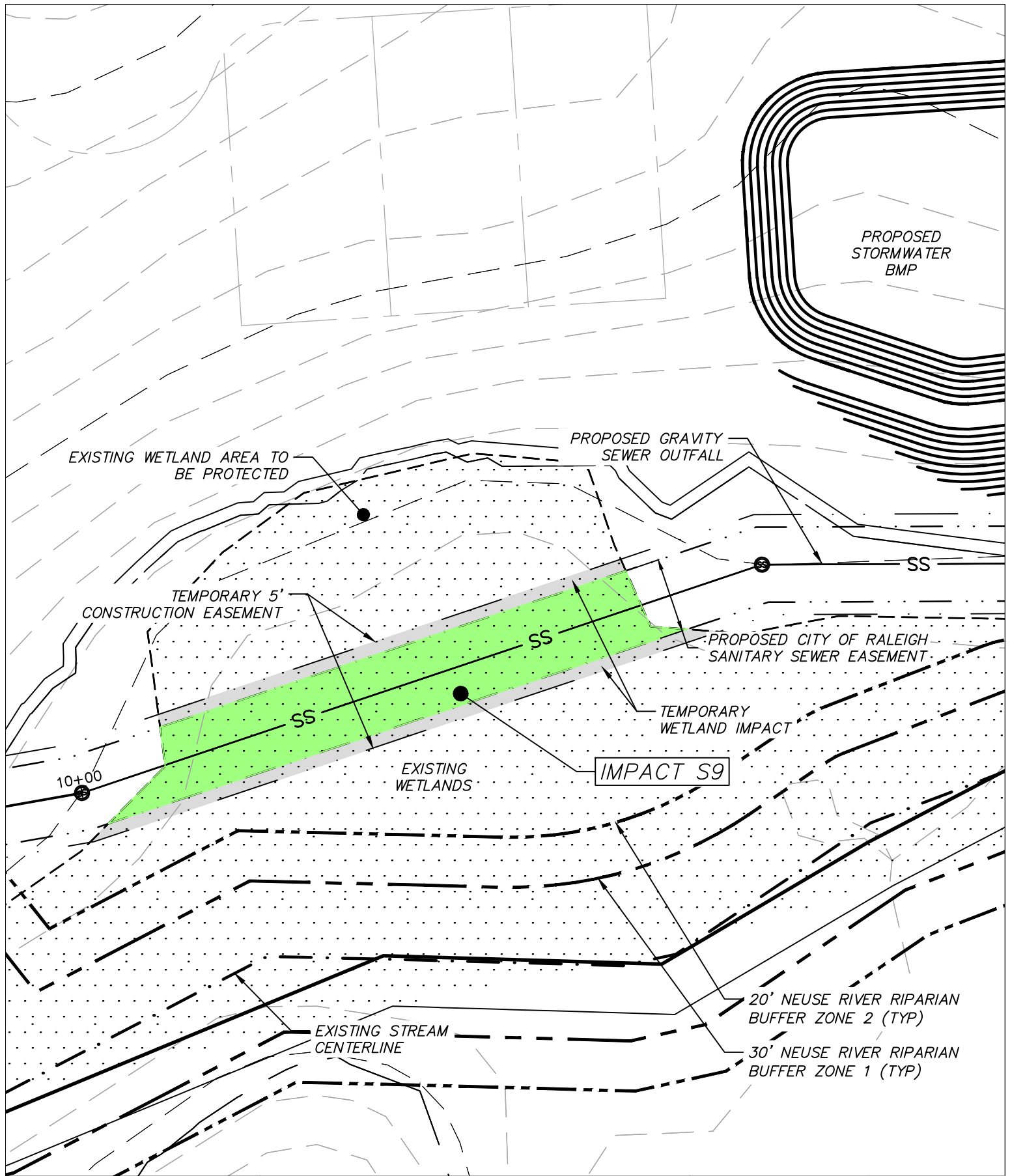

1730 Varsity Drive, Suite 500
Raleigh, North Carolina 27606
O: 919.233.8091 F: 919.233.8031

Wetland Impact Map Impact S9

Ammons Property

Scale: 1"=50'

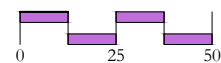

Date:
August 17, 2022



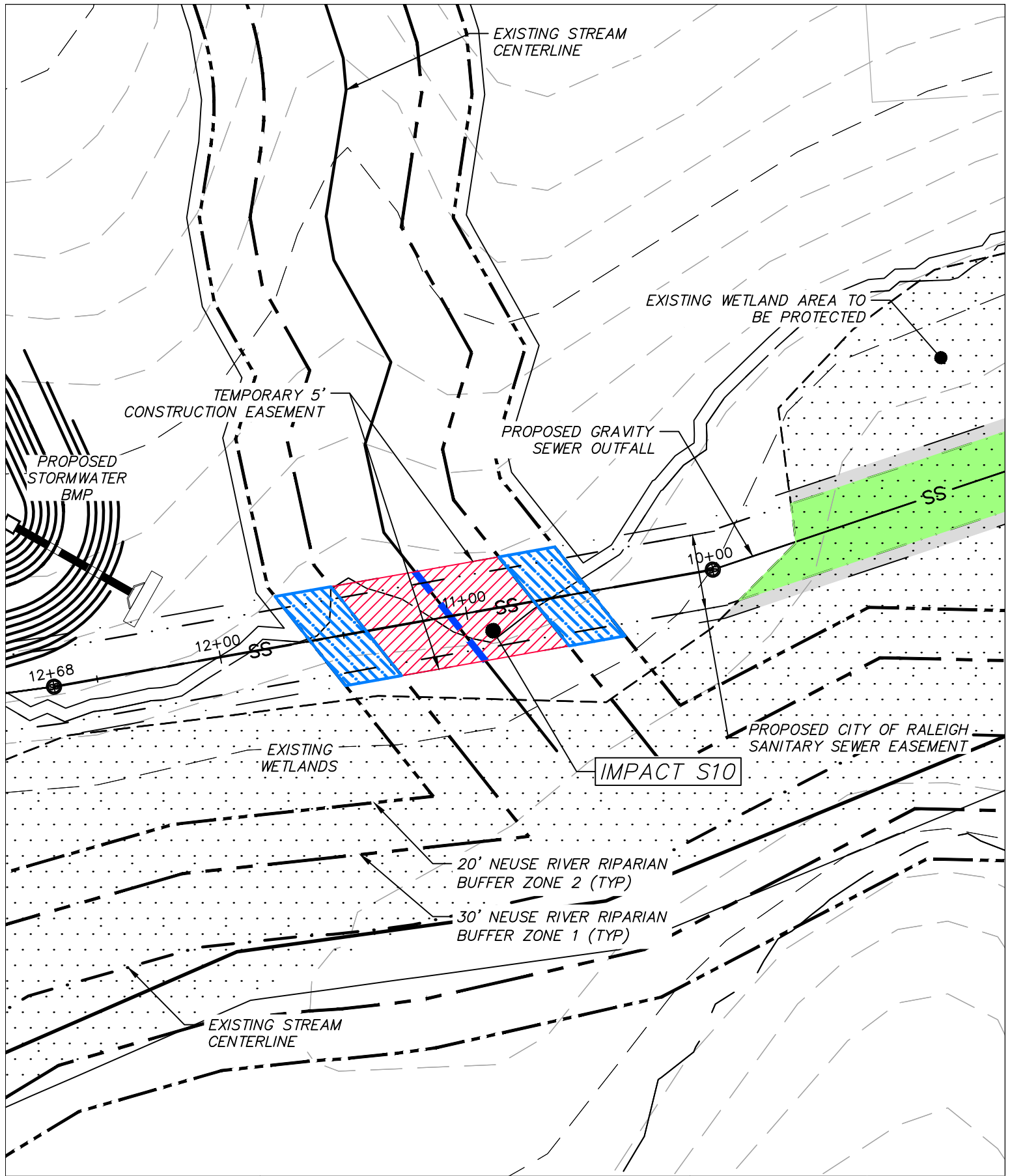

1730 Varsity Drive, Suite 500
 Raleigh, North Carolina 27606
 O: 919.233.8091 F: 919.233.8031

Wetland Impact Map Impact S10

Ammons Property

Scale: 1"=50'



Date:
August 17, 2022



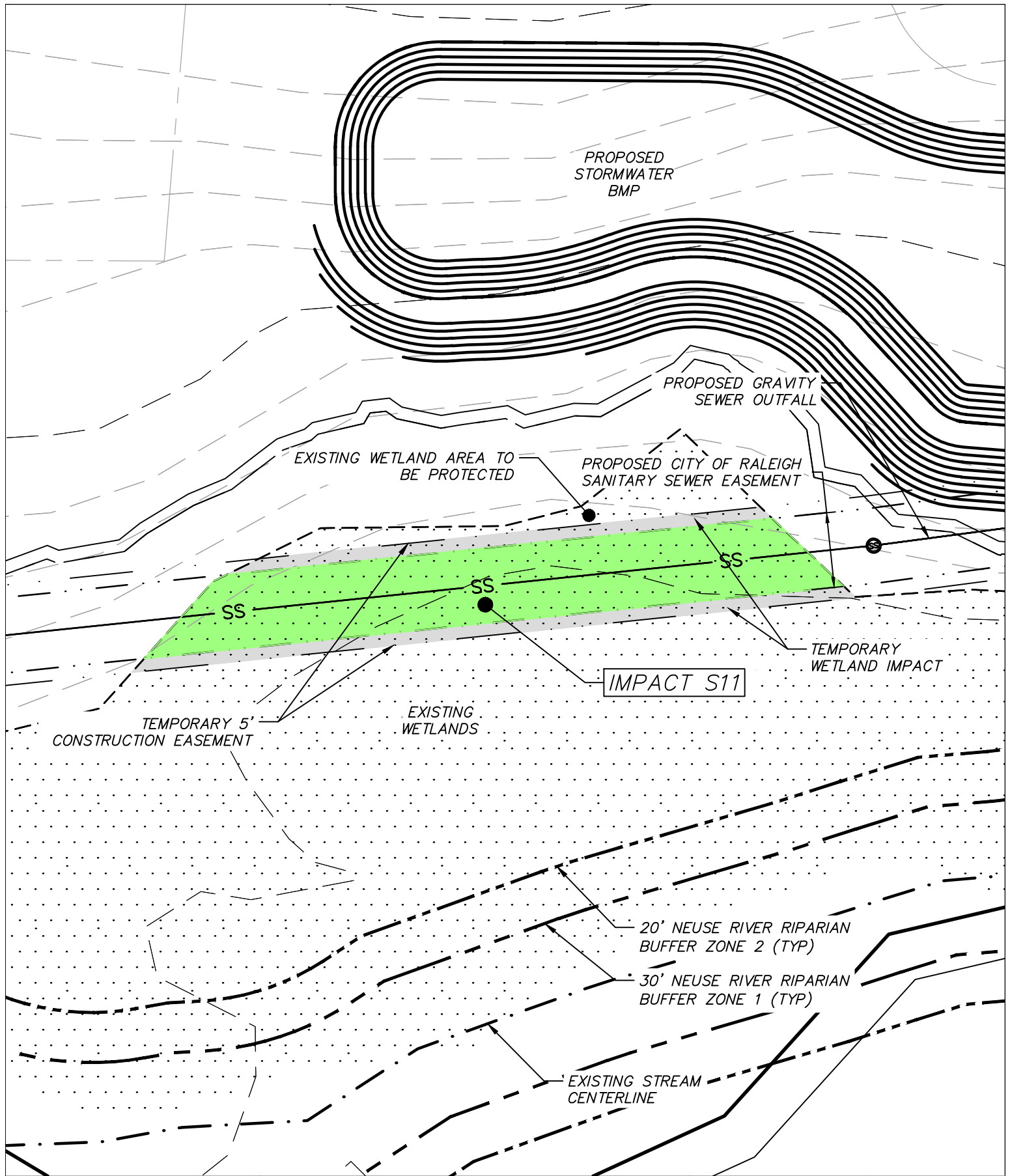

1730 Varsity Drive, Suite 500
Raleigh, North Carolina 27606
O: 919.233.8091 F: 919.233.8031

Wetland Impact Map Impact S11

Ammons Property

Scale: 1"=50'

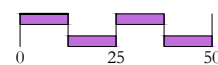

Date:
August 17, 2022



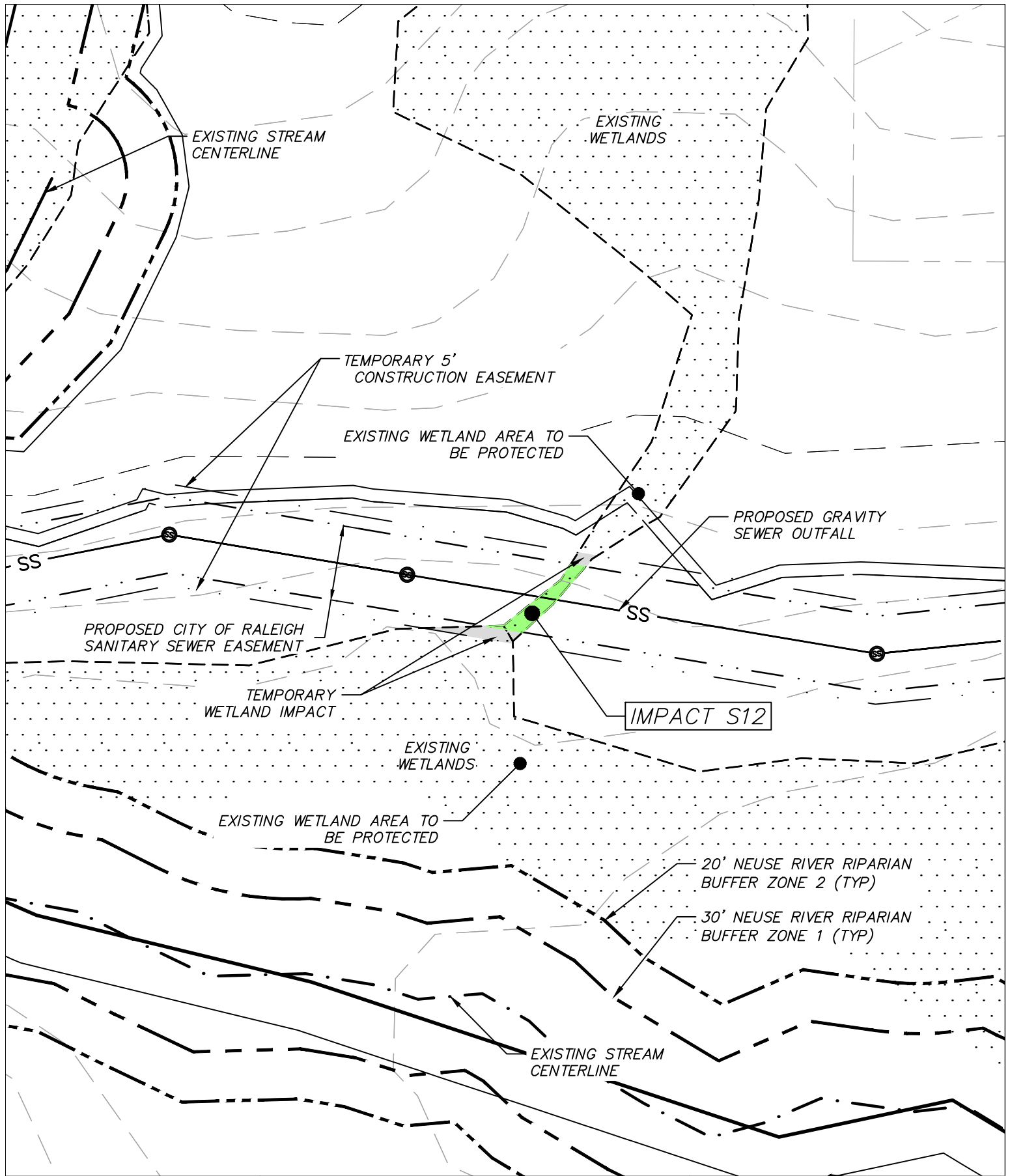

1730 Varsity Drive, Suite 500
Raleigh, North Carolina 27606
O: 919.233.8091 F: 919.233.8031

Wetland Impact Map Impact S12

Ammons Property

Scale: 1"=50'



Date:
August 17, 2022



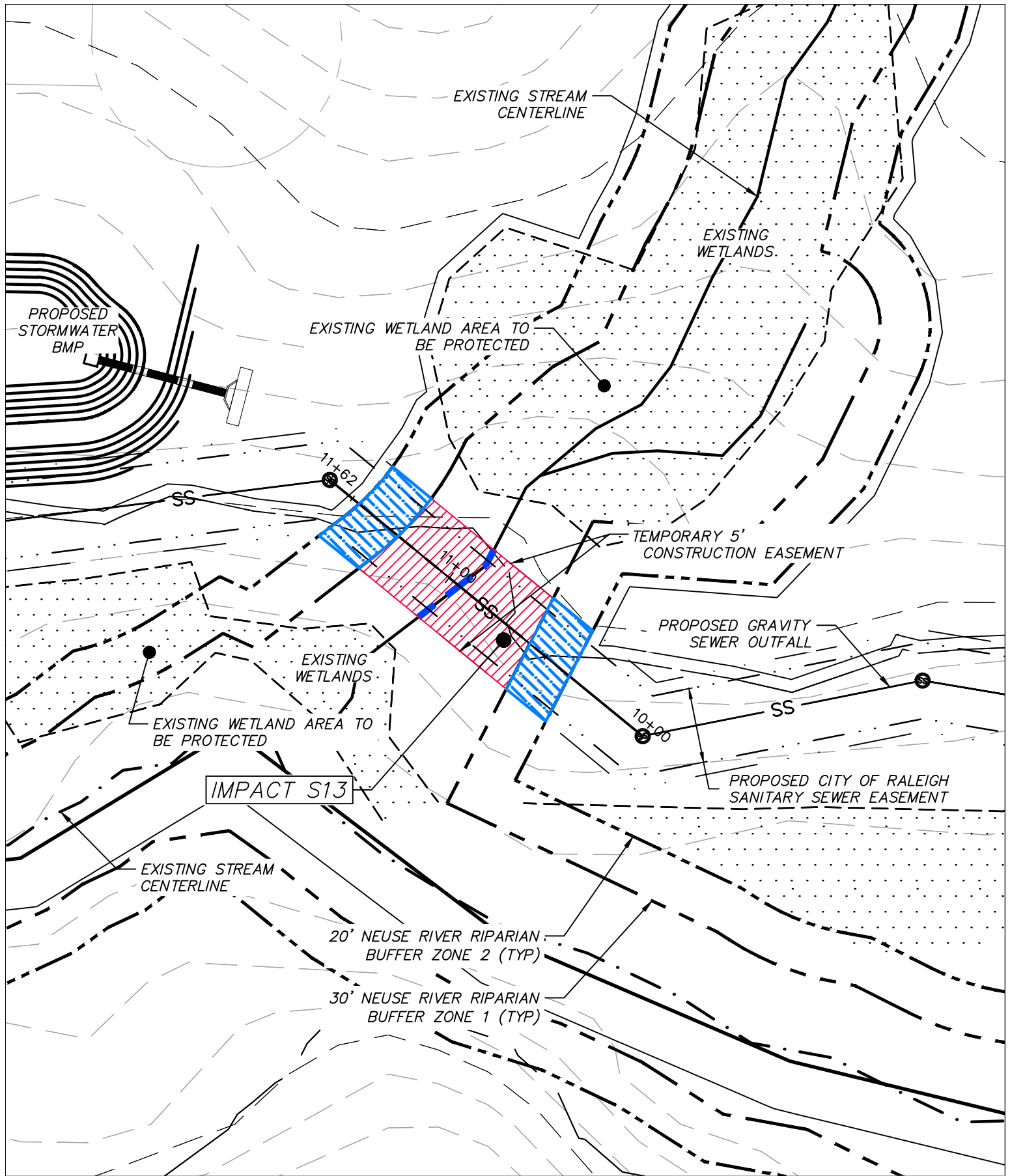

1730 Varsity Drive, Suite 500
 Raleigh, North Carolina 27606
 O: 919.233.8091 F: 919.233.8031

Wetland Impact Map Impact S13

Ammons Property

Scale: 1"=50'



Date:
August 17, 2022

