

**PROJECT
AREA**

L:\Wetlands\2020\20.348\Permitting\Maps

Boundaries are approximate and not meant to be absolute.

Map Source: World Street Map

Stateside Tract
Onslow County, NC

November 2022
DRGNCW20.348

DAVEY 
Resource Group
3805 Wrightsville Avenue
Wilmington, NC 28403
(910) 452-0001

**Figure 1.
Vicinity Map**



0 1 2 4 Miles
Scale applies to 11X17" print.



L:\Wetlands\2020\20.348\Permitting\Maps

Boundaries are approximate and not meant to be absolute.

Map Source: 2020 NC OneMap

Stateside Tract
Onslow County, NC

November 2022
DRGNCW20.348

DAVEY 
Resource Group
3805 Wrightsville Avenue
Wilmington, NC 28403
(910) 452-0001

Figure 4.
2020 Aerial



0 750 1,500 3,000
ft
Scale applies to 11X17" print.

Y:\Land Projects 3\Stateside 300 Ac School Tract\dwg\S-Overall Impact Map.dwg, 2/13/2023 10:31:48 AM, BLD

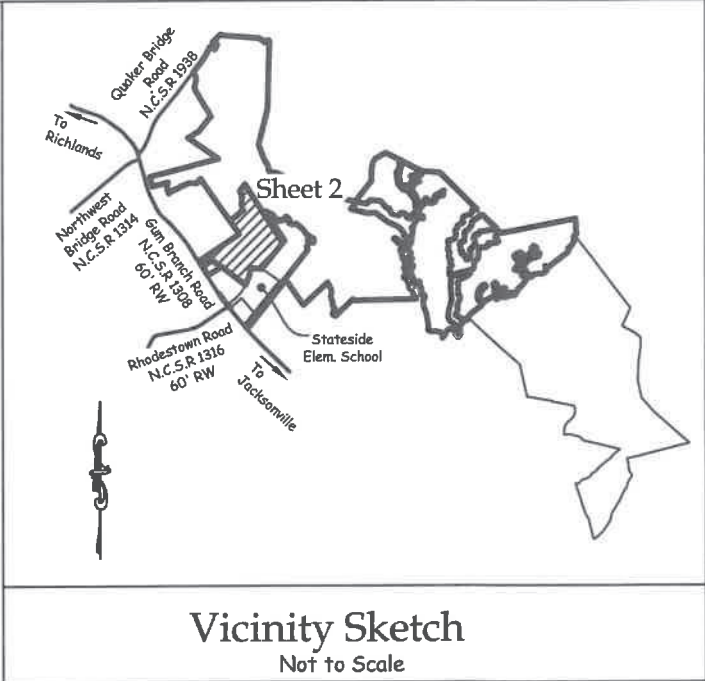
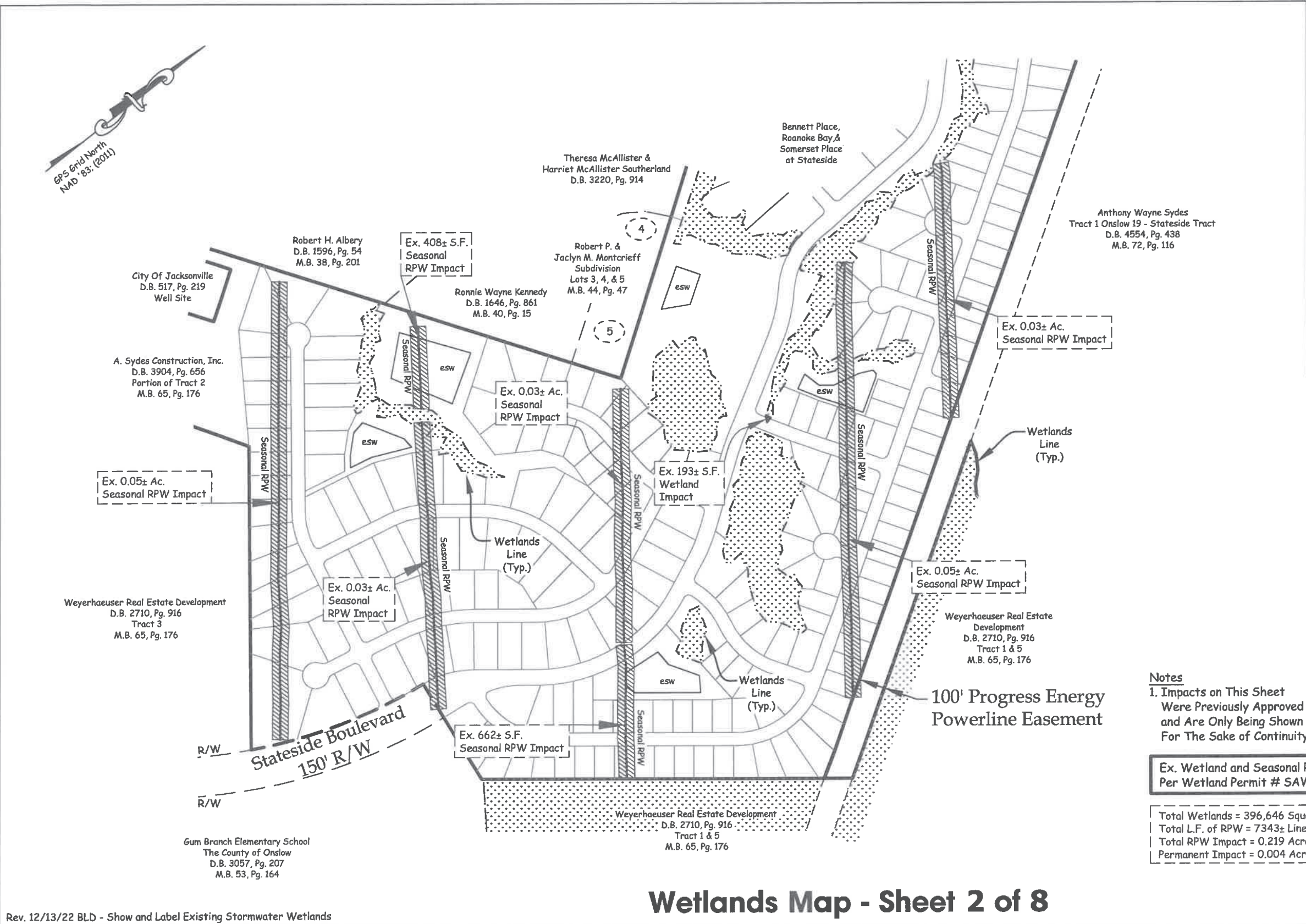

Legend:

- Ac. - Acre
- D.B. - Deed Book
- esw - Existing Stormwater Wetlands
- M.B. - Map Book
- N.C.S.R. - North Carolina Secondary Road
- Pg. - Page
- RPW - Relatively Permanent Water
- R/W - Right-of-way
- S.F. Square Feet
- Typ. - Typical

(2) - Adjoiner Lot Number

Wetlands Area

Seasonal RPW

Notes
1. Impacts on This Sheet
Were Previously Approved
and Are Only Being Shown
For The Sake of Continuity.

Ex. Wetland and Seasonal RPW Impacts
Per Wetland Permit # SAW-2013-01830

Total Wetlands = 396,646 Square Feet
Total L.F. of RPW = 7343± Linear Feet
Total RPW Impact = 0.219 Acres
Permanent Impact = 0.004 Acres

Wetlands Map - Sheet 2 of 8

Rev. 12/13/22 BLD - Show and Label Existing Stormwater Wetlands

Project:
**ONSLOW 19,
STATESIDE TRACT**
Richlands Twp., Onslow Co., North Carolina

Owners:
A. Sydes Construction Inc.
100 Carolina Plantation Boulevard
Jacksonville, North Carolina

Date: 08/25/22
Scale: 1"=400'
Field book: N/A
File Name: S-Overall Impact Map
Disk Name: Acad #2330
Drawn: BLD
Job No.: S220823-8189

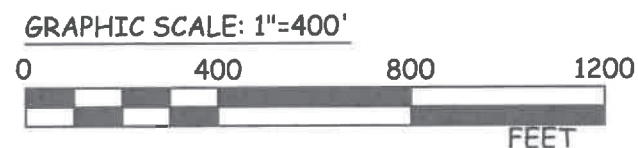

TIDEWATER ASSOCIATES, INC.
Consulting Engineers - Land Surveyors - Land Planners
Jacksonville, North Carolina
P.O. Box 976 - 306 New Bridge Street - 28540
Phone (910) 455-2414 - www.TidewaterENC.com
Firm License Number: F-0108



Y:\Land Projects 3\Stateside 300 Ac School Tract\dwg\S-Overall Impact Map.dwg, 2/13/2023 10:32:04 AM, BLD

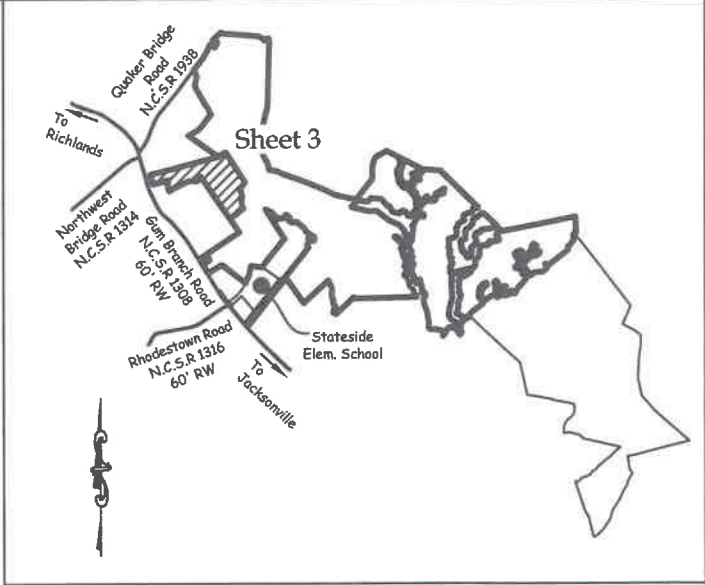
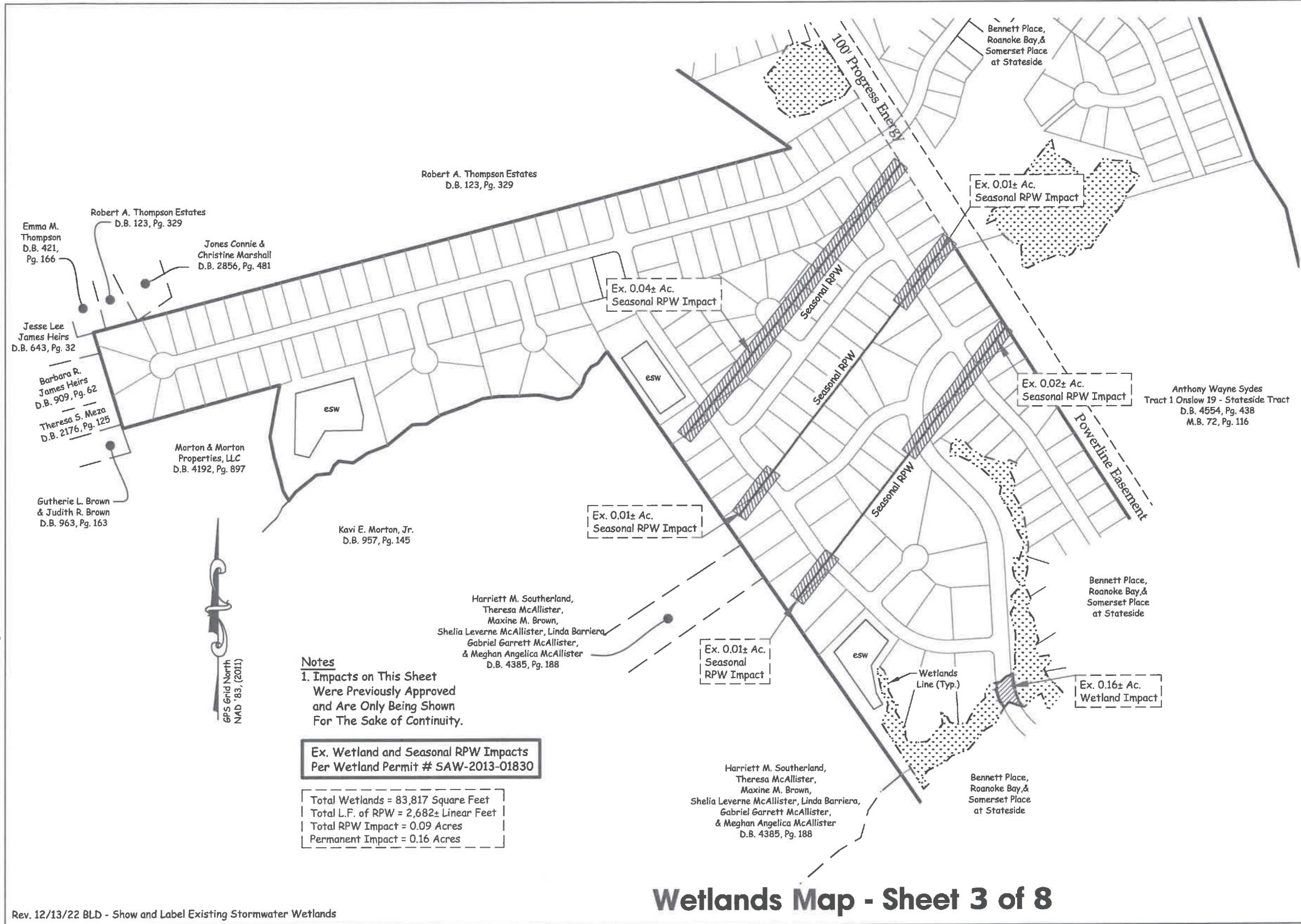

Vicinity Sketch
Not to Scale

Legend:

- Ac. - Acre
- D.B. - Deed Book
- esw - Existing Stormwater Wetlands
- M.B. - Map Book
- N.C.S.R. - North Carolina Secondary Road
- Pg. - Page
- RPW - Relatively Permanent Water
- R/W - Right-of-way
- S.F. Square Feet
- Typ. - Typical

(2) - Adjoiner Lot Number

[Pattern] - Wetlands Area

[Line] - Seasonal RPW

Notes
1. Impacts on This Sheet
Were Previously Approved
and Are Only Being Shown
For The Sake of Continuity.

Ex. Wetland and Seasonal RPW Impacts
Per Wetland Permit # SAW-2013-01830

Total Wetlands = 83,817 Square Feet
Total L.F. of RPW = 2,682± Linear Feet
Total RPW Impact = 0.09 Acres
Permanent Impact = 0.16 Acres

Wetlands Map - Sheet 3 of 8

Rev. 12/13/22 BLD - Show and Label Existing Stormwater Wetlands

Project:
**ONSLOW 19,
STATESIDE TRACT**
Richlands Twp., Onslow Co., North Carolina

Owners:
A. Sydes Construction Inc.
100 Carolina Plantation Boulevard
Jacksonville, North Carolina

Date: 08/25/22
Scale: 1"=400'
Field book: N/A
File Name: S-Overall Impact Map
Disk Name: Acad #2330
Drawn: BLD
Job No.: S220823-8189

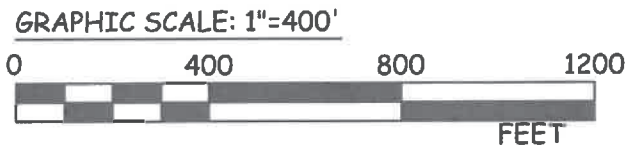

TIDEWATER ASSOCIATES, INC.
Consulting Engineers - Land Surveyors - Land Planners
Jacksonville, North Carolina
P.O. Box 976 - 306 New Bridge Street - 28540
Phone (910) 455-2414 - www.TidewaterENC.com
Firm License Number: F-0108



Y:\Land Projects\3\Stateside 300 Ac School Tract\dwg\S-Overall Impact Map.dwg, 2/13/2023 10:32:28 AM, BLD

1. Seasonal RPW To Be Filled
Approx. 343'± Long x 1.3'± Wide = 0.01± Ac. Impact
2. Seasonal RPW To Be Filled
Approx. 845'± Long x 1.3'± Wide = 0.03± Ac. Impact
3. Seasonal RPW To Be Filled
Approx. 680'± Long x 1.3'± Wide = 0.02± Ac. Impact
4. Seasonal RPW To Be Filled
Approx. 403'± Long x 1.3'± Wide = 0.01± Ac. Impact
5. Seasonal RPW To Be Filled
Approx. 585'± Long x 1.3'± Wide = 0.02± Ac. Impact
6. Portion of Seasonal RPW To Be Filled
Approx. 1,184'± Long x 1.3'± Wide = 0.04± Ac. Impact
7. Portion of Seasonal RPW To Be Filled
Approx. 876'± Long x 1.3'± Wide = 0.03± Ac. Impact
8. Portion of Seasonal RPW To Be Filled
Approx. 906'± Long x 1.3'± Wide = 0.03± Ac. Impact

9. Portion of Seasonal RPW To Be Filled
Approx. 564'± Long x 1.3'± Wide = 0.02± Ac. Impact
10. Seasonal RPW To Be Filled
Approx. 2,212'± Long x 1.3'± Wide = 0.07± Ac. Impact
11. Portion of Seasonal RPW To Be Filled
Approx. 1,903'± Long x 1.3'± Wide = 0.05± Ac. Impact
12. Seasonal RPW To Be Filled
Approx. 575'± Long x 1.3'± Wide = 0.02± Ac. Impact
13. Portion of Seasonal RPW To Be Filled
Approx. 740'± Long x 1.3'± Wide = 0.02± Ac. Impact

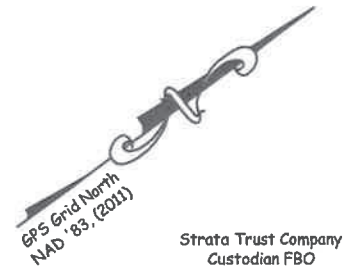

Strata Trust Company
Custodian FBO
D.B. 5406, Pg. 664
M.B. 79, Pg. 132

Robert A. Thompson
D.B. 123, Pg. 329

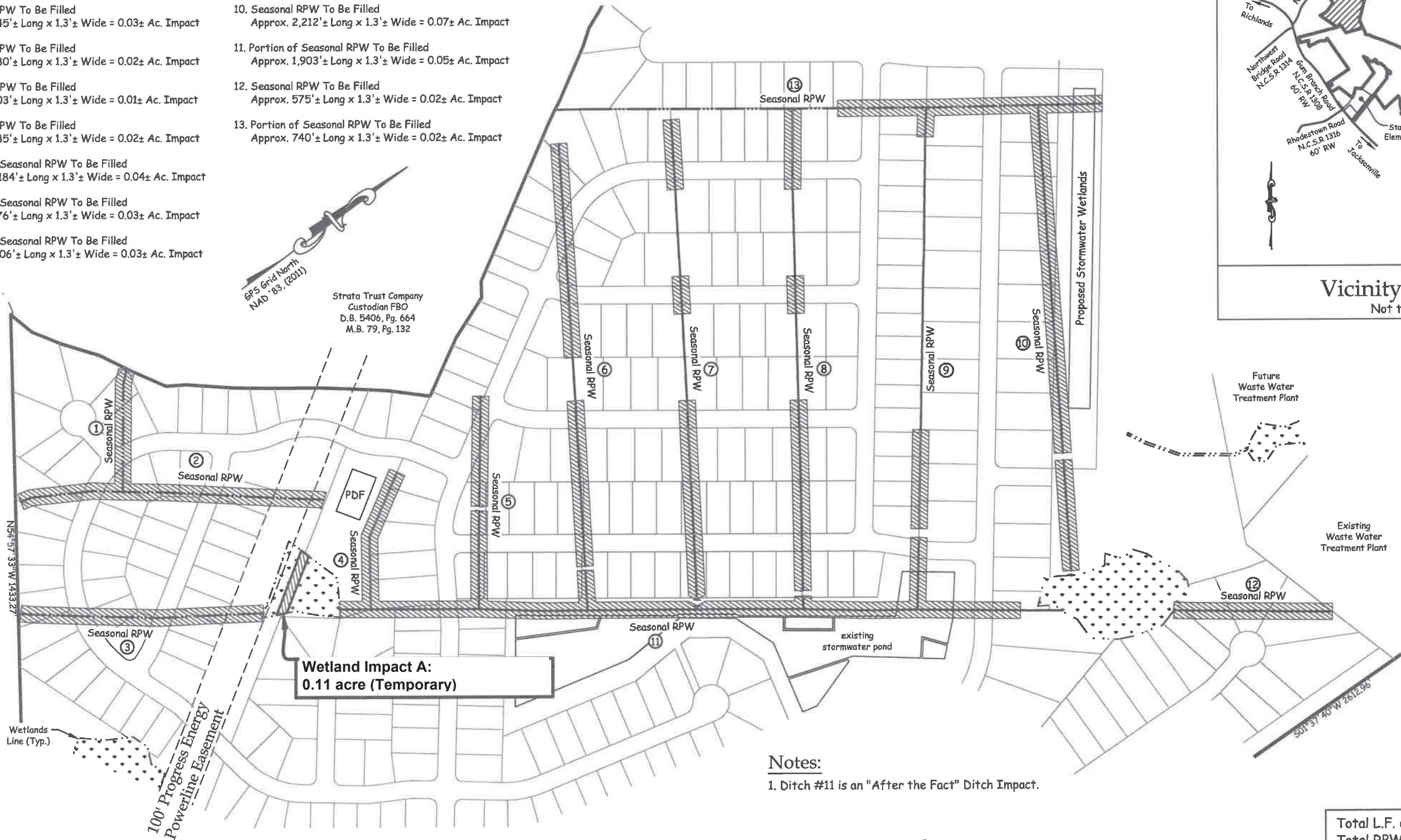

Notes:

1. Ditch #11 is an "After the Fact" Ditch Impact.

Total L.F. of RPW = 15,869± Linear Feet
Total RPW Impact = 0.36 Acres

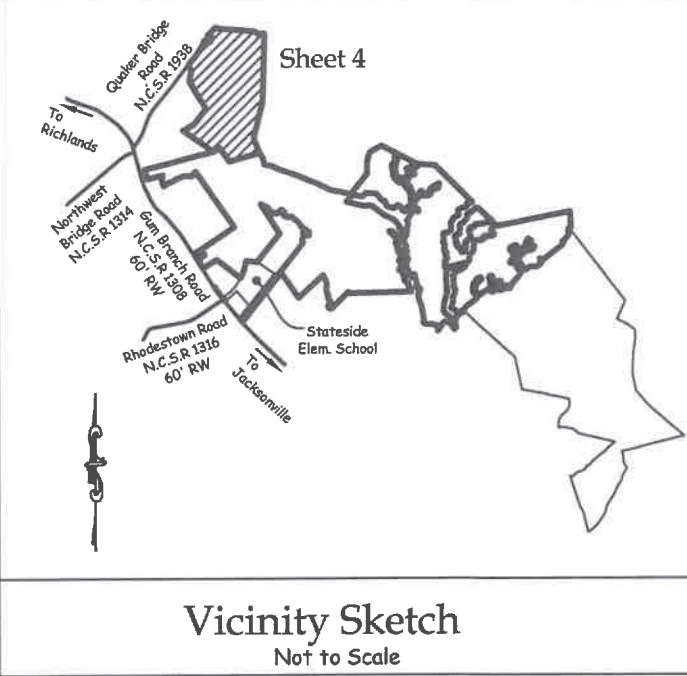

Legend:

- Ac. - Acre
- D.B. - Deed Book
- M.B. - Map Book
- N.C.S.R. - North Carolina Secondary Road
- PDF - Proposed Disconnected Forebay
- Pg. - Page
- RPW - Relatively Permanent Water
- R/W - Right-of-way
- S.F. Square Feet
- Typ. - Typical

- (2) - Adjoiner Lot Number
- Wetlands Area
- Seasonal RPW
- Seasonal RPW Filled

Rev. 02/13/23 BLD - Add Note and Impact #14
Rev. 12/13/22 BLD - Add Additional Seasonal RPW

Project:
**ONSLOW 19,
STATESIDE TRACT**
Richlands Twp., Onslow Co., North Carolina

Owners:
A. Sydes Construction Inc.
100 Carolina Plantation Boulevard
Jacksonville, North Carolina

Date: 08/25/22
Scale: 1"=300'
Field book: N/A
File Name: S-Overall Impact Map
Disk Name: Acad #2330
Drawn: BLD
Job No.: S220823-8189

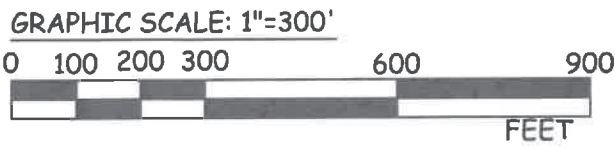

TIDEWATER ASSOCIATES, INC.
Consulting Engineers - Land Surveyors - Land Planners
Jacksonville, North Carolina
P.O. Box 976 - 306 New Bridge Street - 28540
Phone (910) 455-2414 - www.TidewaterENC.com
Firm License Number: F-0108



Y:\Land Projects 3\Stateside 300 Ac School Tract\dwg\S-Overall Impact Map.dwg, 2/13/2023 10:32:57 AM, BLD

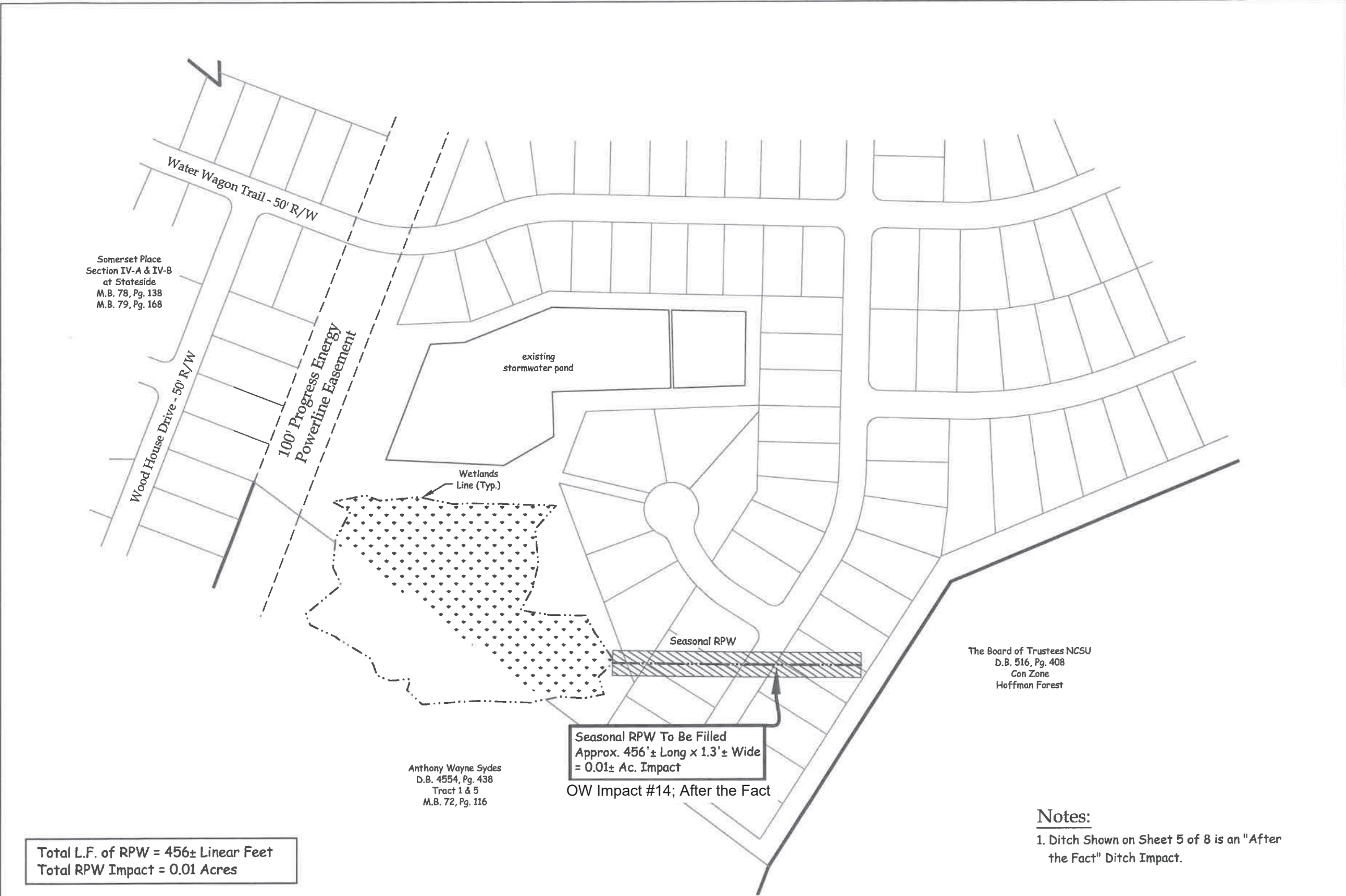

Total L.F. of RPW = 456± Linear Feet
Total RPW Impact = 0.01 Acres

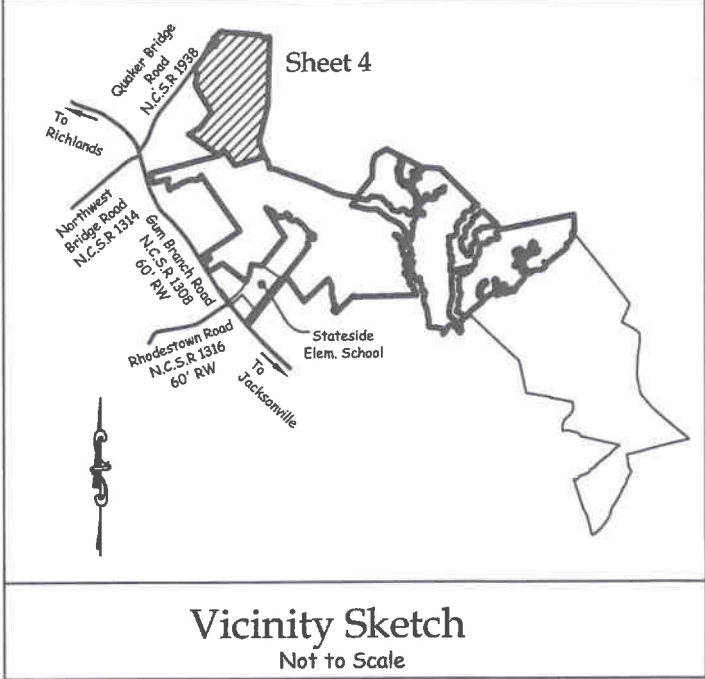

- Legend:**
- Ac. - Acre
 - D.B. - Deed Book
 - M.B. - Map Book
 - N.C.S.R. - North Carolina Secondary Road
 - Pg. - Page
 - RPW - Relatively Permanent Water
 - R/W - Right-of-way
 - S.F. Square Feet
 - Typ. - Typical
 - (2) - Adjoiner Lot Number
 - [Stippled Area] - Wetlands Area
 - [Dashed Line] - Seasonal RPW

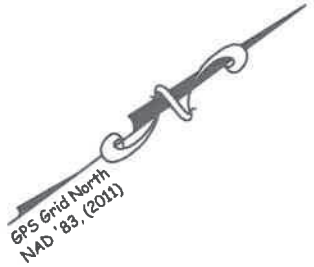

Notes:
1. Ditch Shown on Sheet 5 of 8 is an "After the Fact" Ditch Impact.

Wetlands Map - Sheet 5 of 8

Rev. 02/13/23 BLD - Add Note
Rev. 12/13/22 BLD - Revise Seasonal RPW

Project: ONSLOW 19, STATESIDE TRACT Richlands Twp., Onslow Co., North Carolina	Owners: A. Sydes Construction Inc. 100 Carolina Plantation Boulevard Jacksonville, North Carolina	Date: 08/25/22 Scale: 1"=200' Field book: N/A File Name: S-Overall Impact Map Disk Name: Acad #2330 Drawn: BLD Job No.: S220823-8189	GRAPHIC SCALE: 1"=200' 0 100 200 400 600 FEET	TIDEWATER ASSOCIATES, INC. Consulting Engineers - Land Surveyors - Land Planners Jacksonville, North Carolina P.O. Box 976 - 306 New Bridge Street - 28540 Phone (910) 455-2414 - www.TidewaterENC.com Firm License Number: F-0108	
--	--	---	--	--	--

Y:\Land Projects 3\Stateside 300 Ac School Tract\dwg\S-Overall Impact Map.dwg, 2/13/2023 10:33:22 AM, BLD

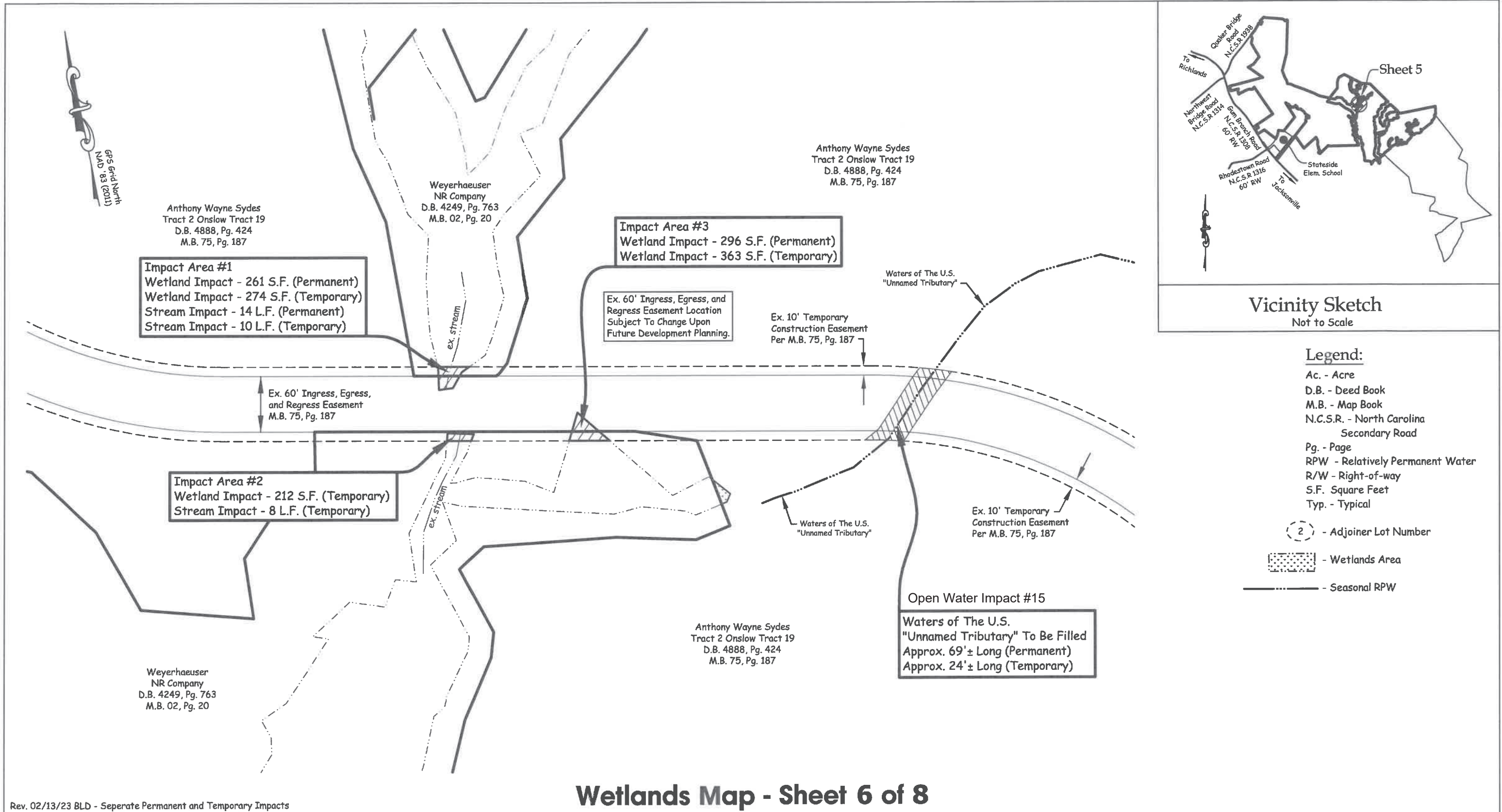

Rev. 02/13/23 BLD - Seperate Permanent and Temporary Impacts

<p>Project:</p> <p>ONSLOW 19, STATESIDE TRACT</p> <p>Richlands Twp., Onslow Co., North Carolina</p>	<p>Owners:</p> <p>A. Sydes Construction Inc.</p> <p>100 Carolina Plantation Boulevard Jacksonville, North Carolina</p>	<p>Date: 08/25/22 Scale: 1"=100' Field book: N/A File Name: S-Overall Impact Map Disk Name: Acad #2330 Drawn: BLD Job No.: S220823-8189</p>	<p>GRAPHIC SCALE: 1"=100'</p> <p>0 50 100 200 300</p> <p>FEET</p>	<p>TIDEWATER ASSOCIATES, INC.</p> <p>Consulting Engineers - Land Surveyors - Land Planners Jacksonville, North Carolina P.O. Box 976 - 306 New Bridge Street - 28540 Phone (910) 455-2414 - www.TidewaterENC.com Firm License Number: F-0108</p> <p>Est. 1961</p>
---	--	---	---	--

Y:\Land Projects 3\Stateside 300 Ac School Tract\dwg\S-Overall Impact Map.dwg, 2/13/2023 10:33:46 AM, BLD

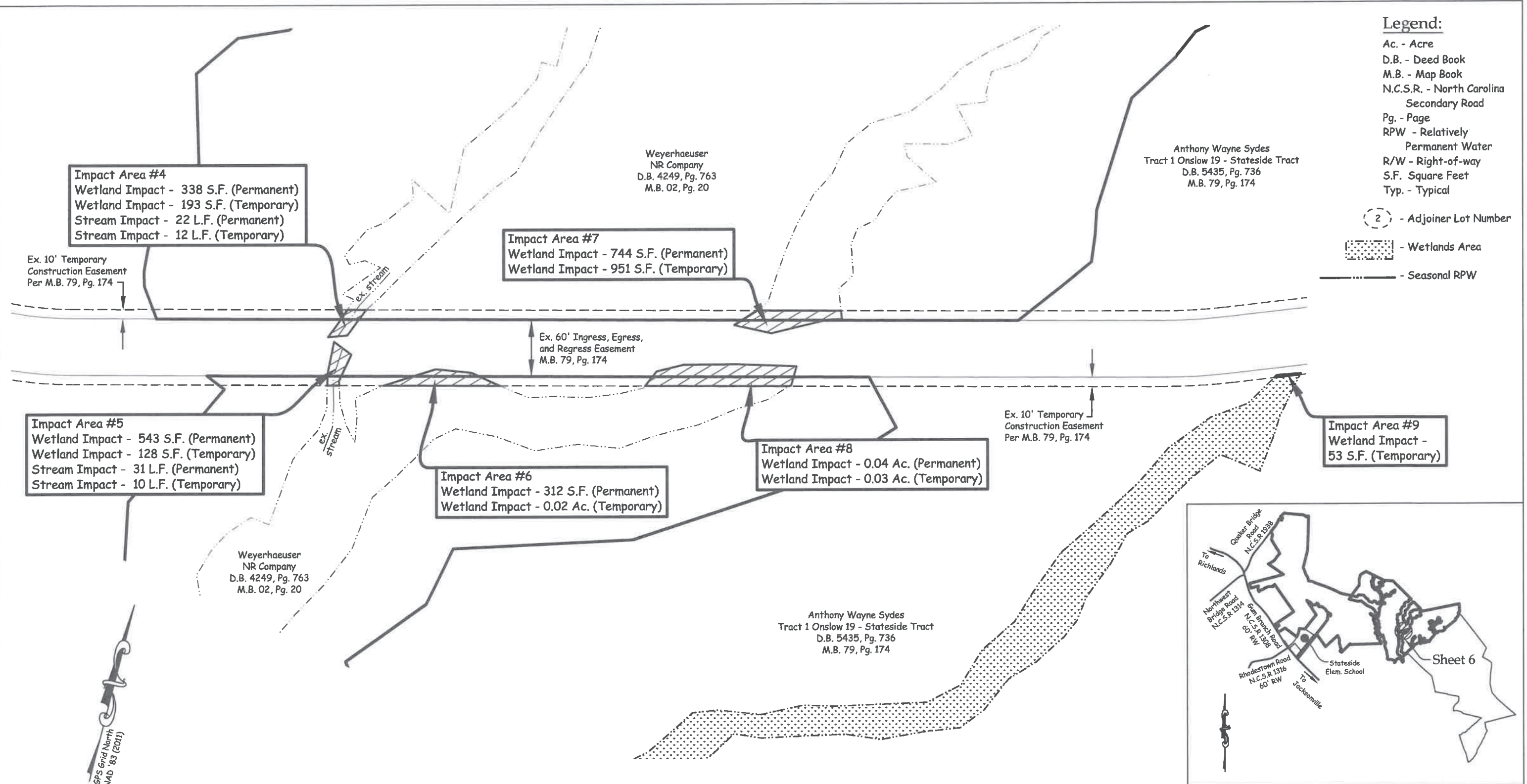

- Legend:**
- Ac. - Acre
 - D.B. - Deed Book
 - M.B. - Map Book
 - N.C.S.R. - North Carolina Secondary Road
 - Pg. - Page
 - RPW - Relatively Permanent Water
 - R/W - Right-of-way
 - S.F. Square Feet
 - Typ. - Typical

2 - Adjoiner Lot Number

- Wetlands Area

- Seasonal RPW

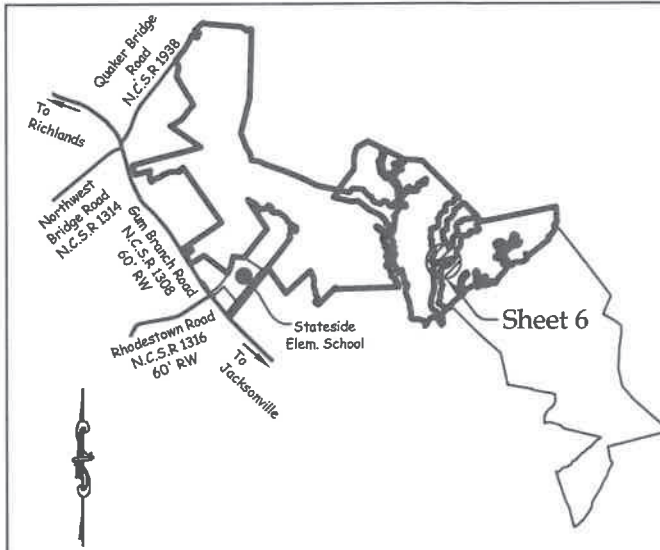

Wetlands Map - Sheet 7 of 8

Vicinity Sketch
Not to Scale

Rev. 02/13/23 BLD - Seperate Permanent and Temporary Impacts

Project: ONSLOW 19, STATESIDE TRACT Richlands Twp., Onslow Co., North Carolina	Owners: A. Sydes Construction Inc. 100 Carolina Plantation Boulevard Jacksonville, North Carolina	Date: 08/25/22 Scale: 1"=100' Field book: N/A File Name: S-Overall Impact Map Disk Name: Acad #2330 Drawn: BLD Job No.: S220823-8189	GRAPHIC SCALE: 1"=100' 0 50 100 200 300 FEET	TIDEWATER ASSOCIATES, INC. Consulting Engineers - Land Surveyors - Land Planners Jacksonville, North Carolina P.O. Box 976 - 306 New Bridge Street - 28540 Phone (910) 455-2414 - www.TidewaterENC.com Firm License Number: F-0108	 Est. 1961
--	--	---	---	--	--

Y:\Land Projects 3\Stateside 300 Ac School Tract\dwg\S-Overall Impact Map.dwg, 2/13/2023 10:34:08 AM, BLD

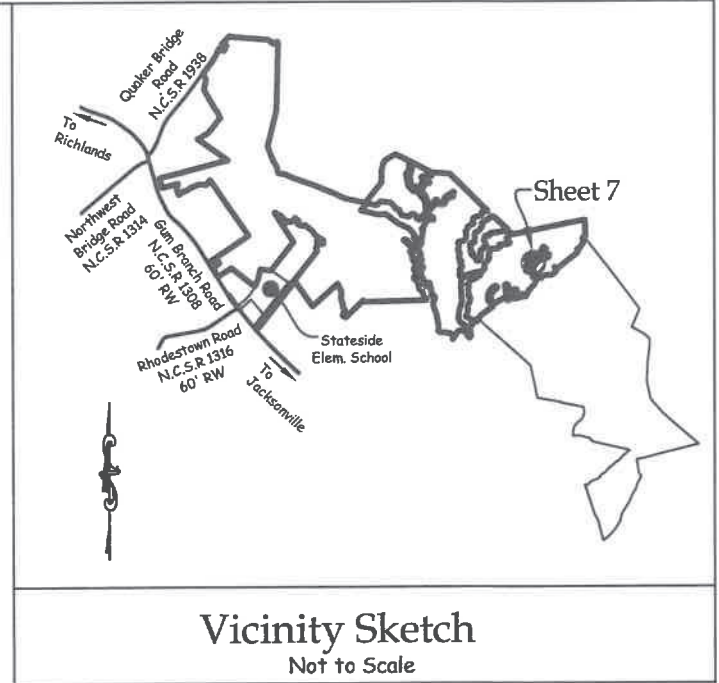
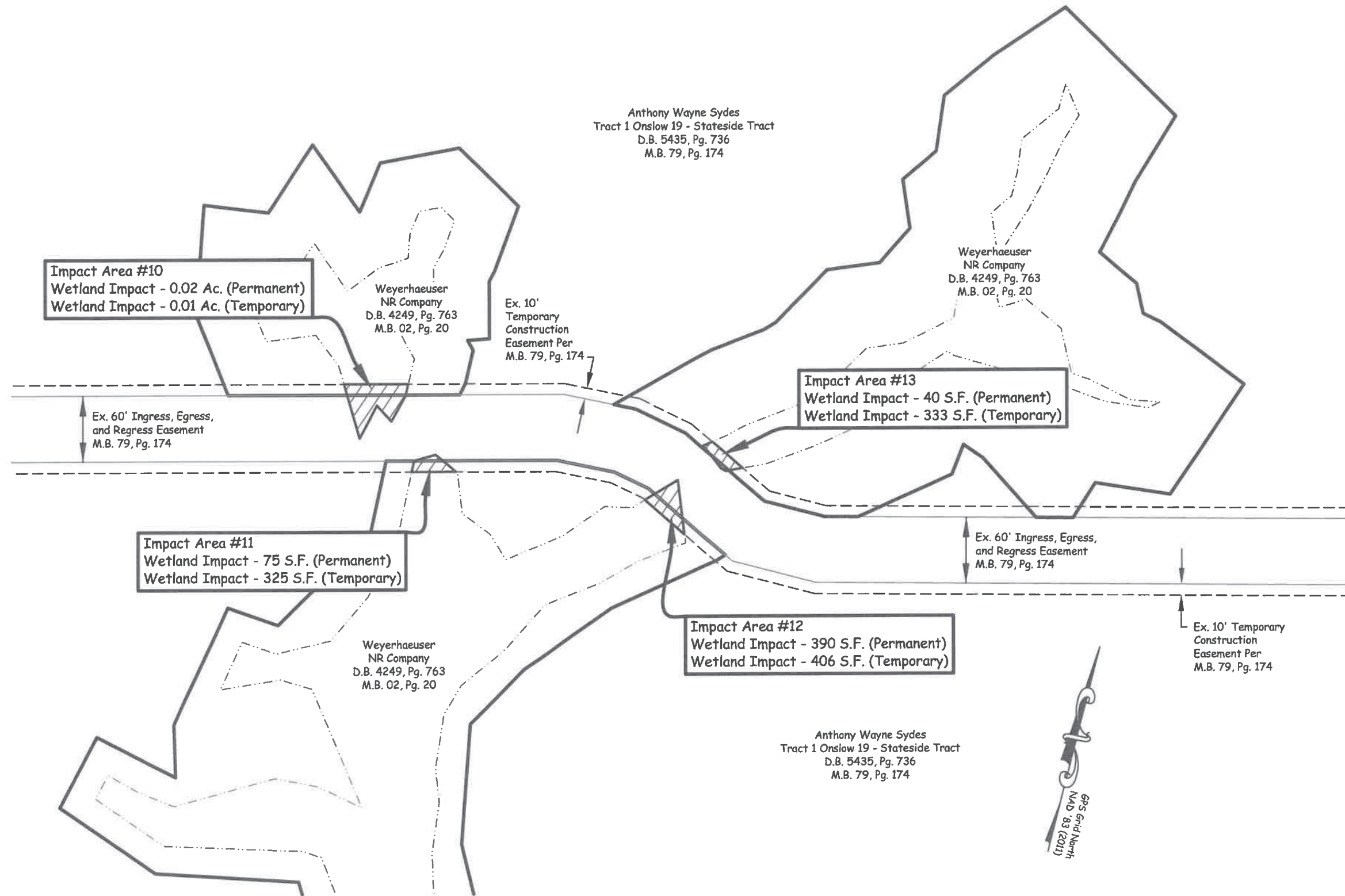

- Legend:**
- Ac. - Acre
 - D.B. - Deed Book
 - M.B. - Map Book
 - N.C.S.R. - North Carolina Secondary Road
 - Pg. - Page
 - RPW - Relatively Permanent Water
 - R/W - Right-of-way
 - S.F. - Square Feet
 - Typ. - Typical
 - (2) - Adjoiner Lot Number
 - [Stippled Area] - Wetlands Area
 - [Dashed Line] - Seasonal RPW

Wetlands Map - Sheet 8 of 8

Rev. 02/13/23 BLD - Seperate Permanent and Temporary Impacts

Project:

**ONSLOW 19,
STATESIDE TRACT**
Richlands Twp., Onslow Co., North Carolina

Owners:

A. Sydes Construction Inc.
100 Carolina Plantation Boulevard
Jacksonville, North Carolina

Date: 08/25/22
Scale: 1"=100'
Field book: N/A
File Name: S-Overall Impact Map
Disk Name: Acad #2330
Drawn: BLD
Job No.: S220823-8189

GRAPHIC SCALE: 1"=100'



TIDEWATER ASSOCIATES, INC.

Consulting Engineers - Land Surveyors - Land Planners
Jacksonville, North Carolina
P.O. Box 976 - 306 New Bridge Street - 28540
Phone (910) 455-2414 - www.TidewaterENC.com
Firm License Number: F-0108

