

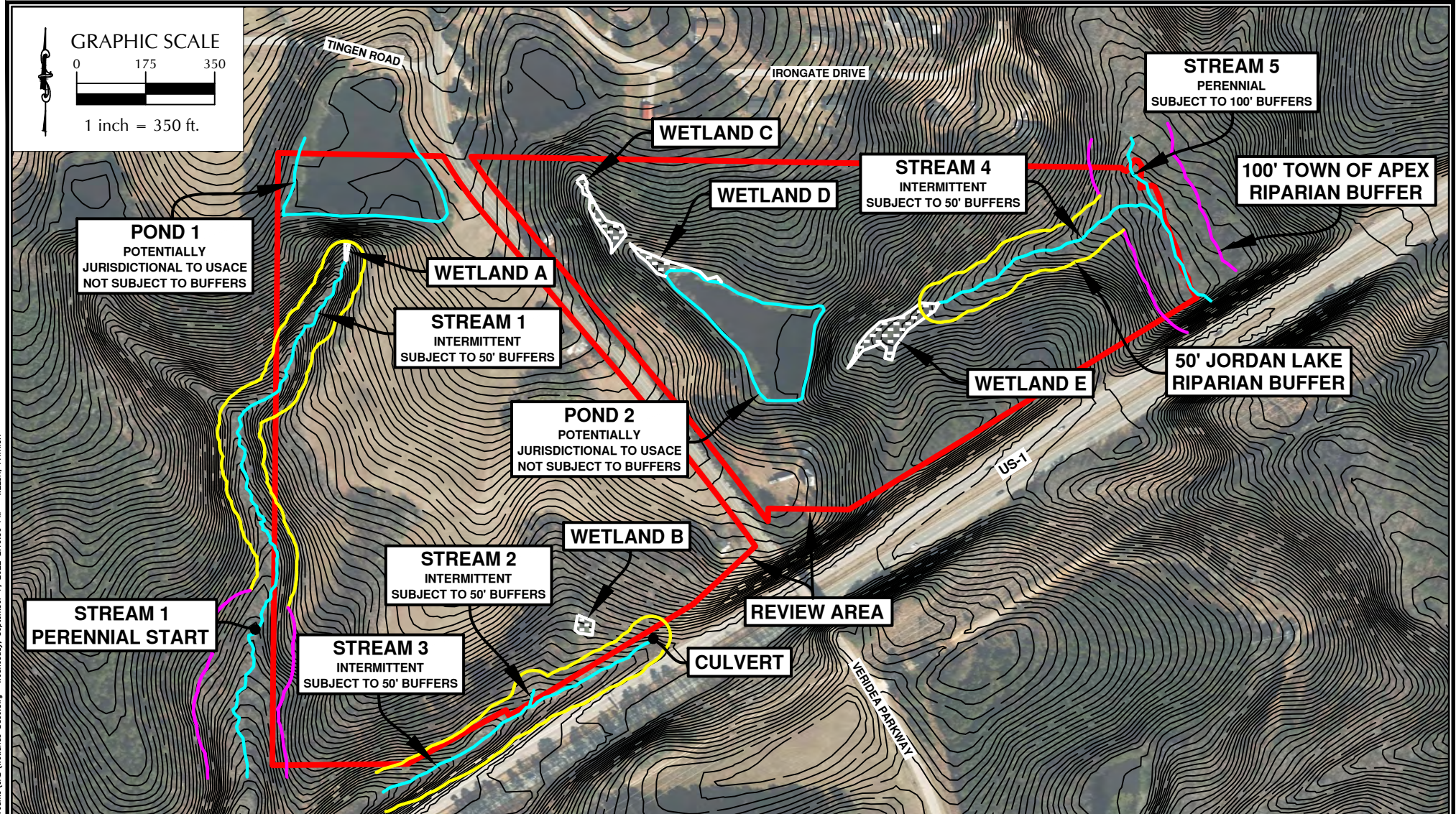

WithersRavenel

Our People. Your Success.

WETLAND DELINEATION EXHIBIT

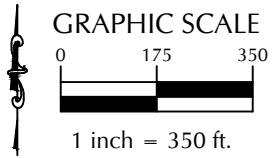

NOTES:

- 1) WETLAND/STREAM/RIPARIAN BUFFER DELINEATION PERFORMED BY WR ON 9/06/2022.
- 2) WETLAND/STREAM/BUFFER LOCATIONS ARE APPROXIMATE, BASED ON GPS LOCATION, WAKE COUNTY GIS DATA, AND TOPOGRAPHIC INTERPRETATION.
- 3) THIS PROPERTY IS LOCATED WITHIN THE CAPE FEAR RIVER BASIN, THEREFORE THIS PROPERTY IS NOT SUBJECT TO STATE RIPARIAN BUFFERS.
- 4) BUFFER SUBJECTIVITY BASED ON TOWN OF APEX RIPARIAN BUFFER ORDINANCE AND JORDAN LAKE RIPARIAN BUFFER RULES. BUFFER SUBJECTIVITY SHOULD BE VERIFIED BY TOWN OF APEX PRIOR TO DESIGN.
- 5) THIS PROPERTY MAY BE SUBJECT TO ADDITIONAL MUNICIPAL ZONING/PLANNING BUFFERS WHICH SHOULD BE VERIFIED PRIOR TO DESIGN.
- 6) DELINEATION AND JURISDICTIONAL DETERMINATION SHOULD BE VERIFIED BY USACE PRIOR TO DESIGN.

2728 VERIDEA PARKWAY

WETLAND/BUFFER DELINEATION EXHIBIT



K:\2022\22-0960\220960-00ce-00ce-00ce - EBT Tract\Wetlands-Streams\CAD\Wetlands-Streams Base.dwg - Wednesday, September 7, 2022 2:19:30 PM - WELSH, PATRICK

IMPACT EXHIBITS

J:\2019\2019-1811-Architects to Grace Christian School Apex\GIS\Map\Overall Impact Map.mxd; Friday, June 21, 2024, 2:50:35 AM; SDOE

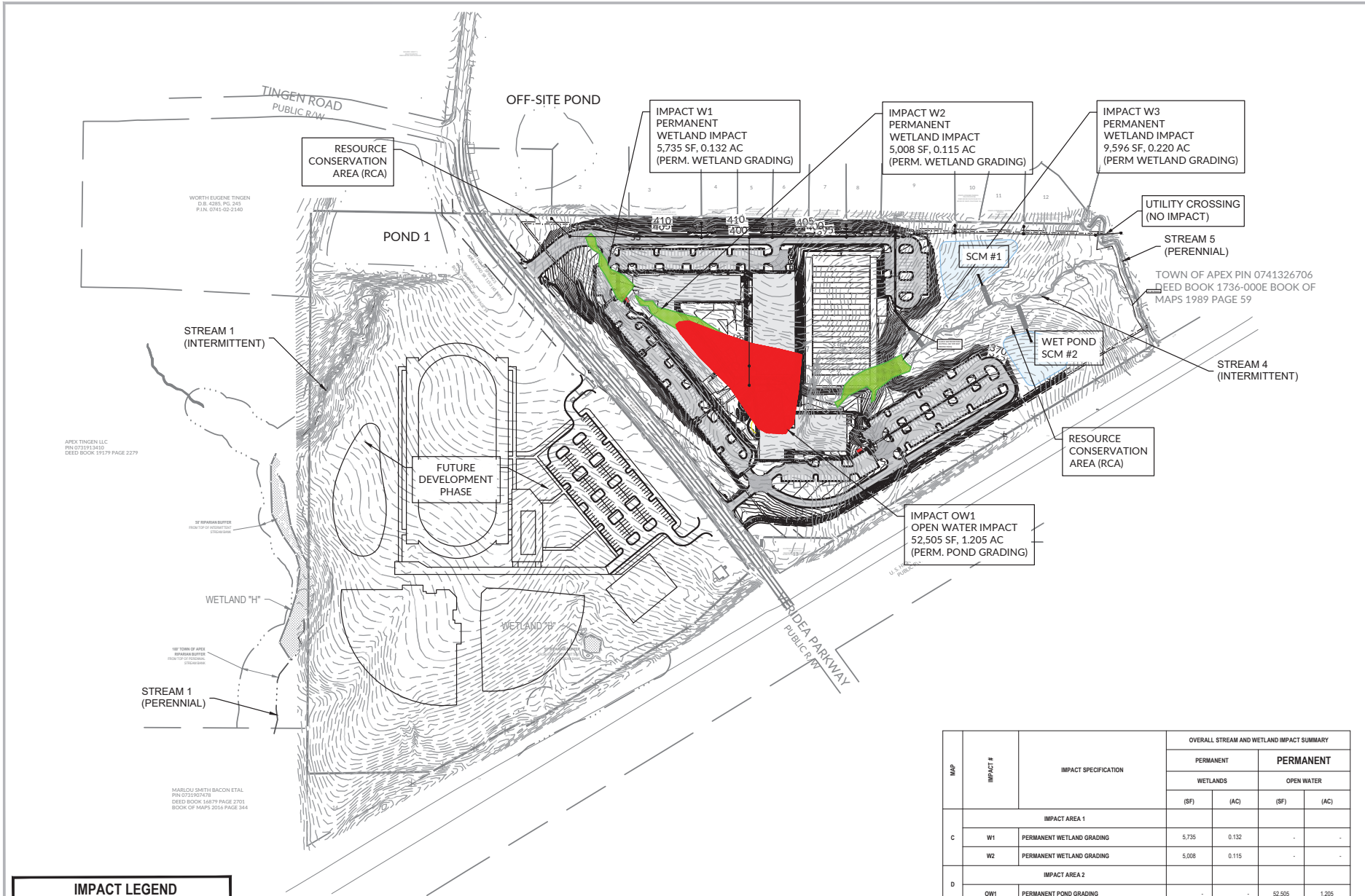

IMPACT LEGEND	
	PERMANENT WETLANDS
	PERMANENT OPEN WATER

IMPACT #	IMPACT SPECIFICATION	OVERALL STREAM AND WETLAND IMPACT SUMMARY			
		PERMANENT WETLANDS		PERMANENT OPEN WATER	
		(SF)	(AC)	(SF)	(AC)
IMPACT AREA 1					
C	W1 PERMANENT WETLAND GRADING	5,735	0.132	-	-
	W2 PERMANENT WETLAND GRADING	5,008	0.115	-	-
IMPACT AREA 2					
D	OW1 PERMANENT POND GRADING	-	-	52,505	1,205
IMPACT AREA 3					
E	W3 PERMANENT WETLAND GRADING	9,596	0.220	-	-
TOTAL		20,339	0.467	52,505	1,205

J:\2019\1818\Activities\Grace Christian School Apex\GIS\Wetland Impact\Mapsheet_Northing_11549_12100_19.03.17_A11_500E

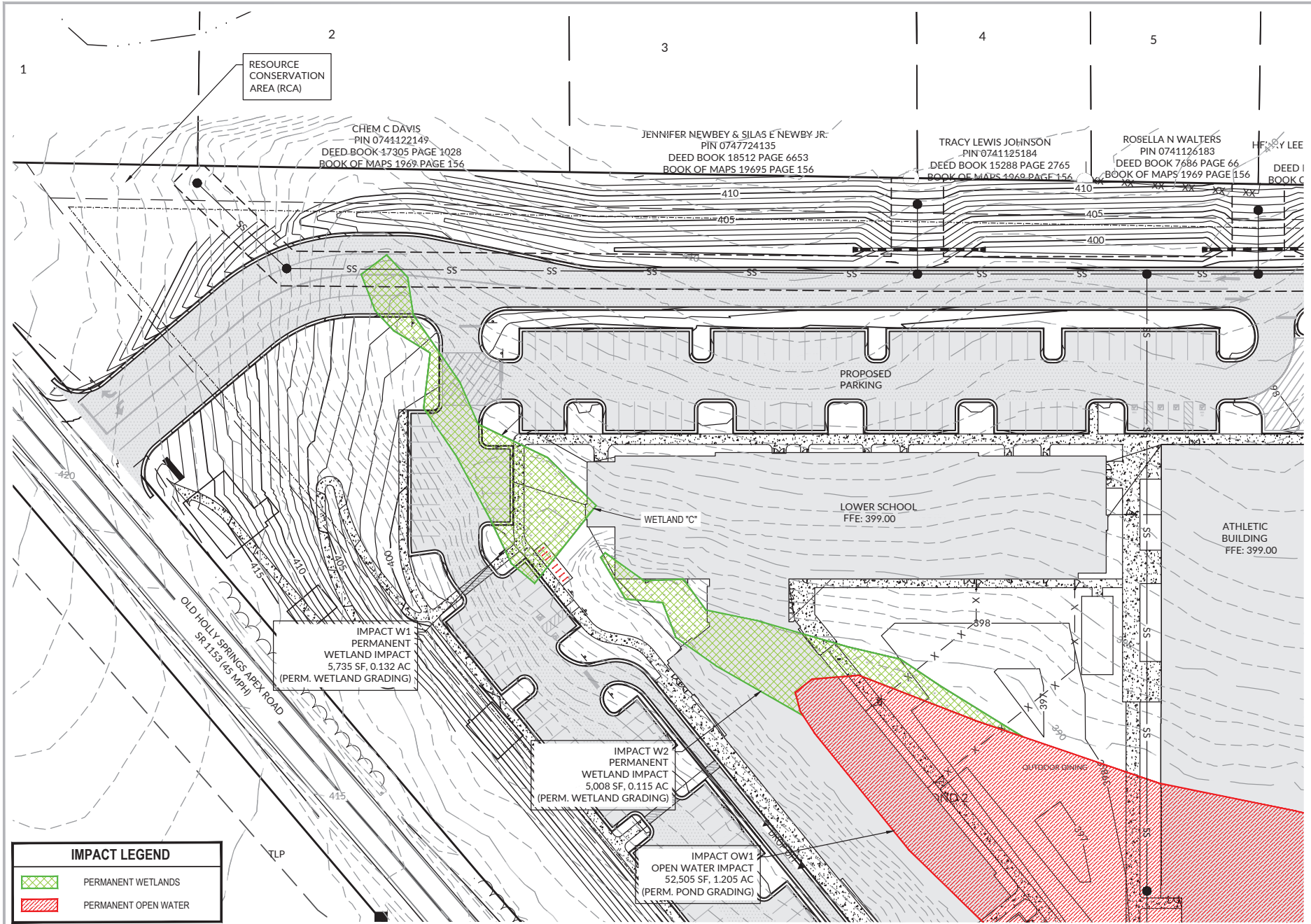

IMPACT LEGEND	
	PERMANENT WETLANDS
	PERMANENT OPEN WATER

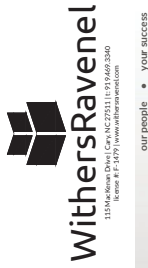

GRACE Christian
School Apex Campus

APEX, NORTH CAROLINA 27539 | WAKE COUNTY

WETLAND IMPACTS

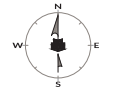

WR Job No. DATE
210859 06/20/2014
DRN: WR DGN: WR CKD: WR

C&D

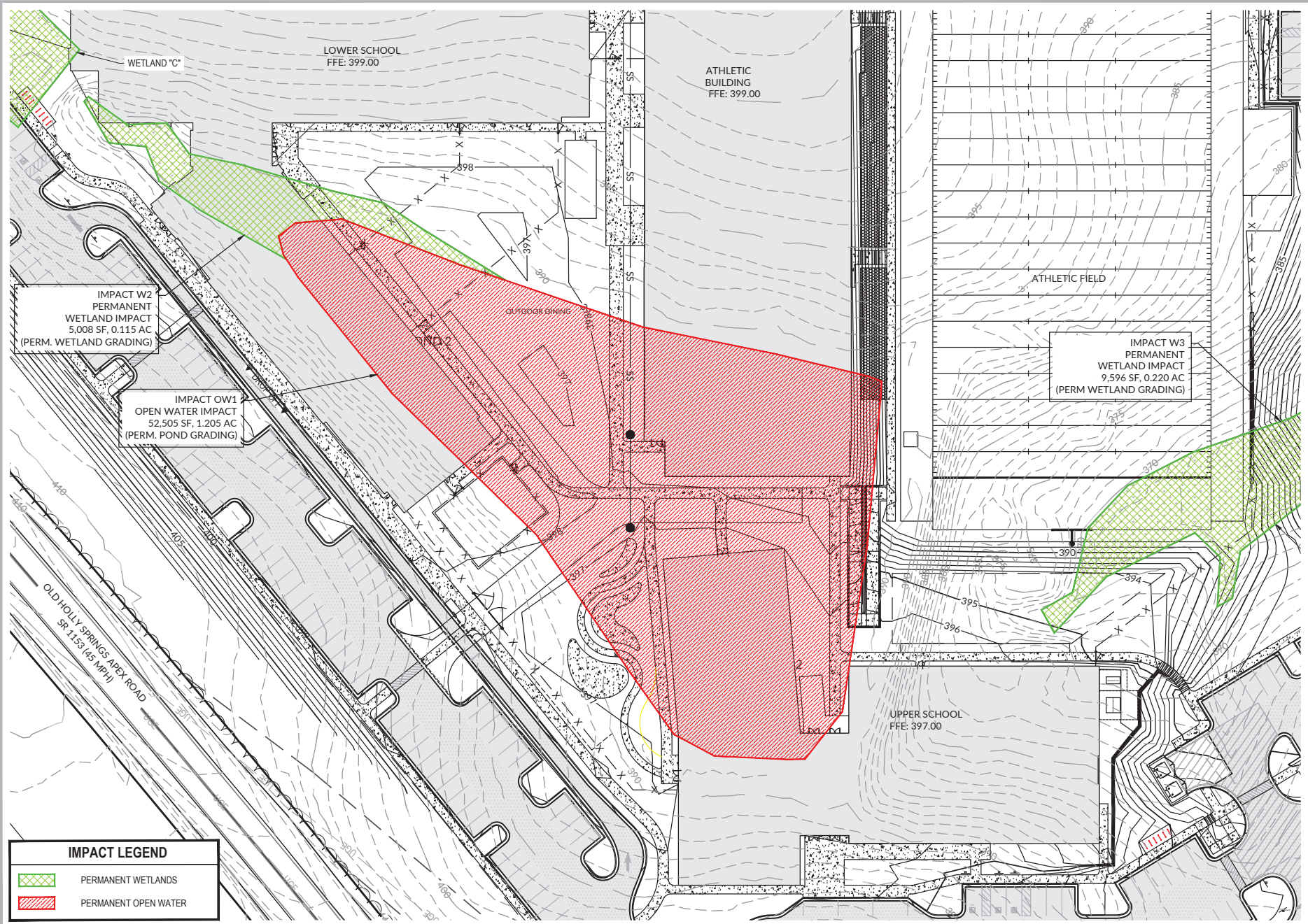

WETLAND "C"

LOWER SCHOOL
FFE: 399.00

ATHLETIC BUILDING
FFE: 399.00

ATHLETIC FIELD

IMPACT W2
PERMANENT
WETLAND IMPACT
5,008 SF, 0.115 AC
(PERM. WETLAND GRADING)

IMPACT OW1
OPEN WATER IMPACT
52,505 SF, 1.205 AC
(PERM. POND GRADING)

IMPACT W3
PERMANENT
WETLAND IMPACT
9,596 SF, 0.220 AC
(PERM WETLAND GRADING)

OLD HOLLY SPRINGS APEX ROAD
SR 1153 (45 MPH)

UPPER SCHOOL
FFE: 397.00

IMPACT LEGEND	
	PERMANENT WETLANDS
	PERMANENT OPEN WATER

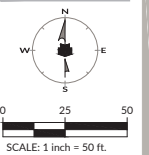

WR Job No. DATE:
210859 06/26/2024
DRN: WR DGN: WR CKD: WR

D

J:\210859\210859\Activities\Grace Christian School Apex Campus\GIS\210859\Impact\Map\Impact_Mapping_11May_21_2024_9:50:39 AM_500E

J:\2020\2079-1881\Activities\Grace Christian School Apex\GIS\Wetland\Wetland Impact\Map\Map.dwg, June 21, 2024, 9:50:23 AM, 50%

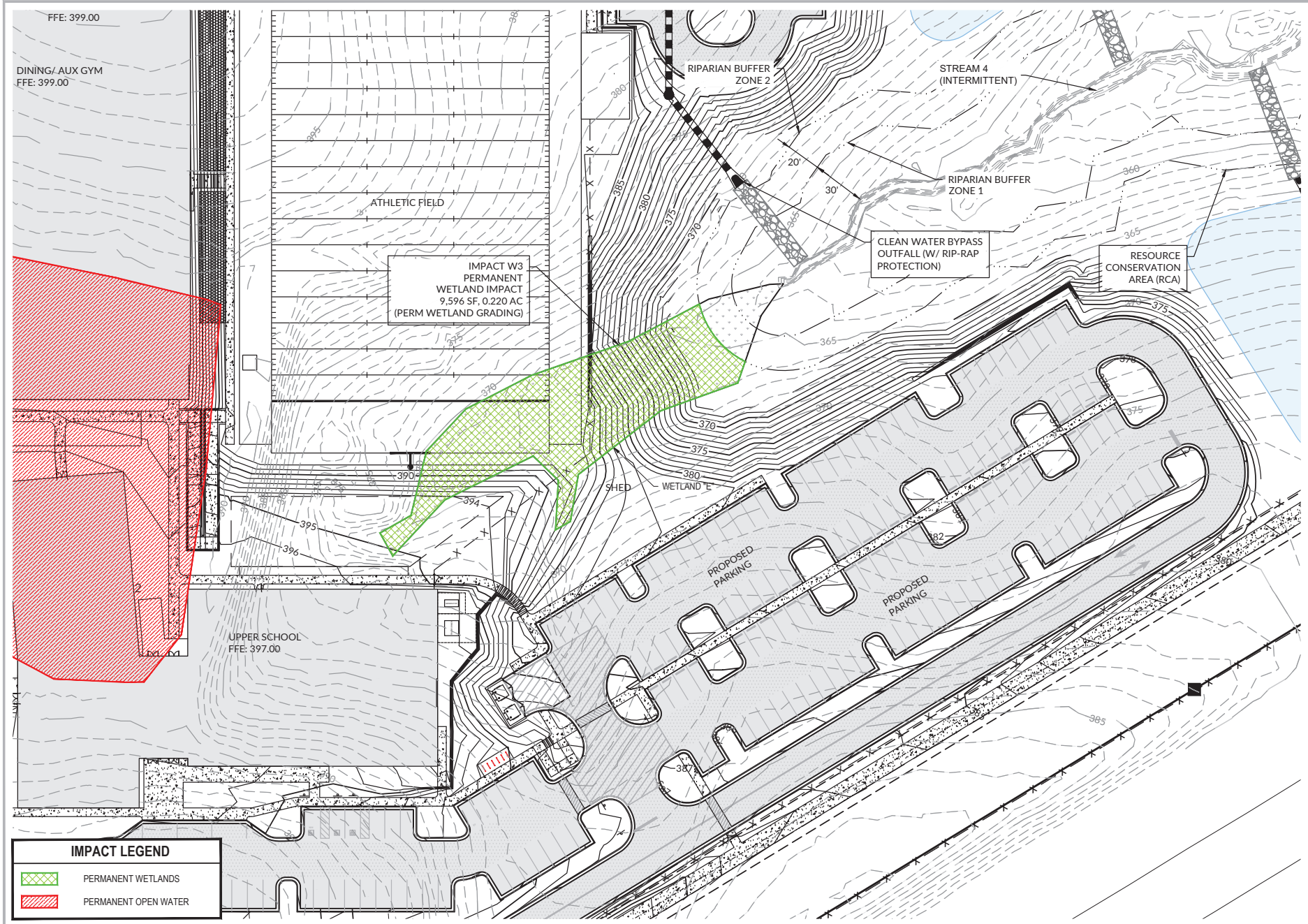

FFE: 399.00
 DINING/ AUX GYM
 FFE: 399.00

IMPACT W3
 PERMANENT
 WETLAND IMPACT
 9,596 SF, 0.220 AC
 (PERM WETLAND GRADING)

CLEAN WATER BYPASS
 OUTFALL (W/ RIP-RAP
 PROTECTION)

RESOURCE
 CONSERVATION
 AREA (RCA)

UPPER SCHOOL
 FFE: 397.00

IMPACT LEGEND	
	PERMANENT WETLANDS
	PERMANENT OPEN WATER



GRACE Christian
 School Apex Campus

APEX, NORTH CAROLINA 27539 | WAKE COUNTY

WETLAND IMPACTS

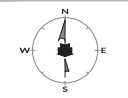

SCALE: 1 inch = 50 ft.

WR Job No. DATE
 210859 06/20/2024
 DRN: WR DGN: WR CKD: WR

F

J:\2025\279 - GRACE CHRISTIAN SCHOOL APX Campus Apex\GIS\GIS\Map\Map\Map.dwg, June 21, 2025 9:58:28 AM, 50%

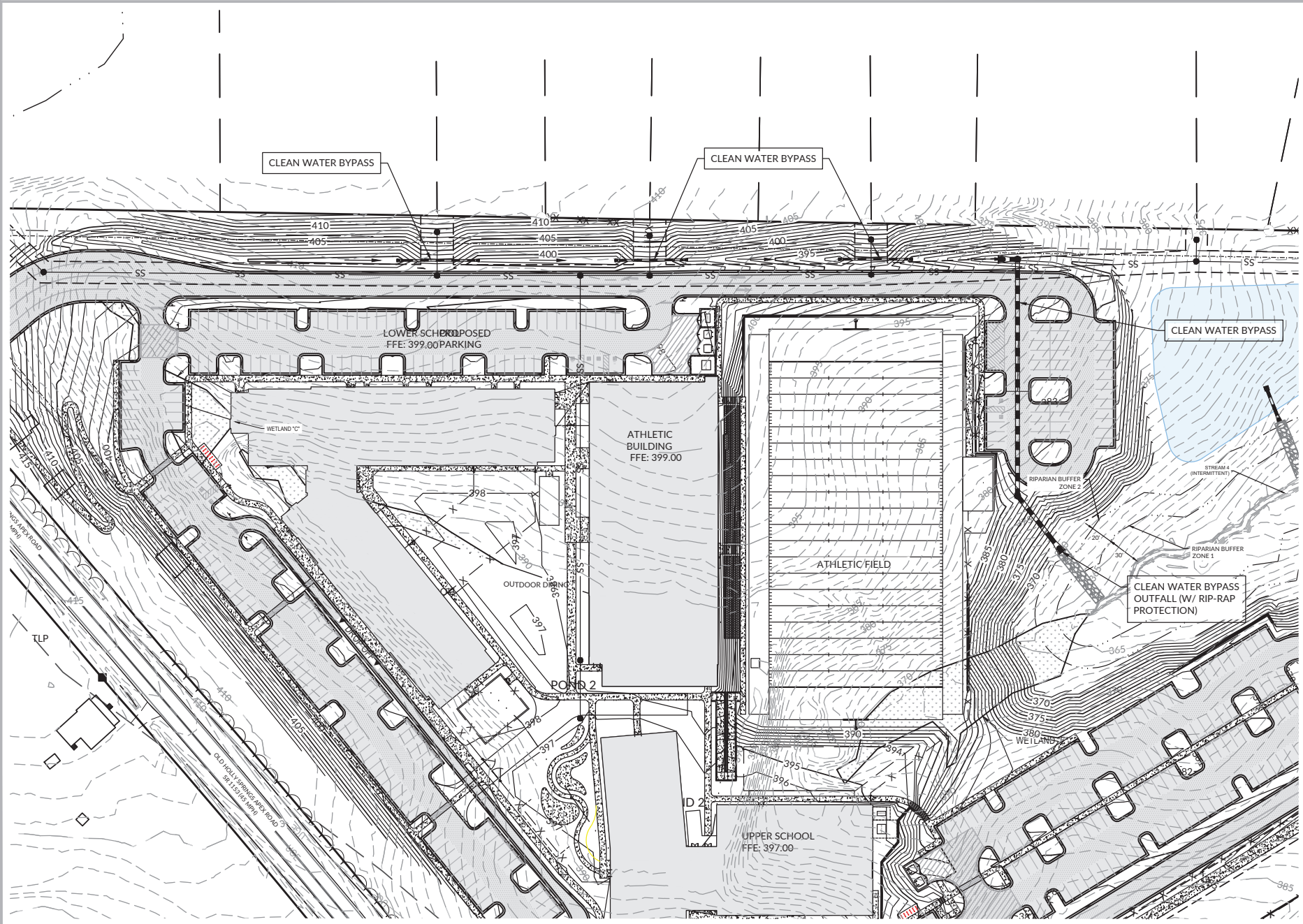

**GRACE Christian
School Apex Campus**

APEX, NORTH CAROLINA 27559 | WAKE COUNTY

CLEAN WATER BYPASS

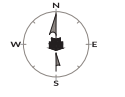

SCALE: 1 inch = 80 ft.

WR Job No.	DATE
230859	06/20/2024
DRN: WR	DCN: WR
	CKD: WR

F

12

JOSEPH/E PERKING & SANDRA M PERKINS
PIN 0741225009
DEED BOOK 2648 PAGE 83
BOOK OF MAPS 1569 PAGE 156

20' WD. PUBLIC SANITARY
SEWER EASEMENT

RIPARIAN BUFFER
ZONE 1

RIPARIAN BUFFER
ZONE 2

8" SANITARY SEWER
FARMS LLC
0741119629
DEED BOOK 15931 PAGE 1193
BOOK OF MAPS 2015 PAGE
14 23.679 ACRES 3.001.442 SF

STREAM 4
(INTERMITTENT)

100' TOWN OF APEX
RIPARIAN BUFFER

WET POND
SCM #2

UTILITY CROSSING
(NO IMPACT)

BORE UNDER STREAM
(APPROX. 40 LF)

NOTE:
PROPOSED SEWER TO
CONNECT TO NEW TOWN OF
APEX SANITARY SEWER MAIN.

STREAM 5
(PERENNIAL)

15' SETBACK

TOWN OF APEX PIN 0741326706 DEED
BOOK 1736-000E BOOK OF MAPS 1989
PAGE 59

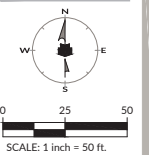
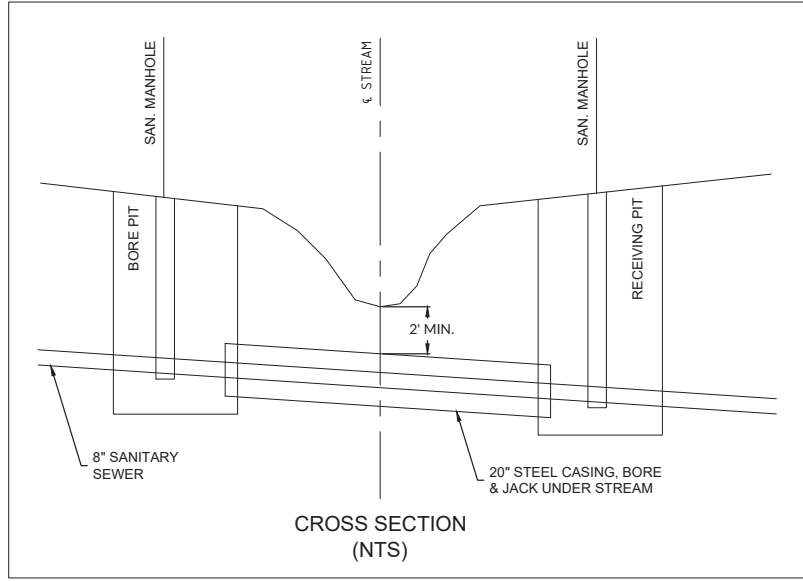

WR Job No. DATE
210850 06/20/2024
DRN: WR DGN: WR CKD: WR

G

J:\210850\210850-Utility\Drawings\Sheet\Utility\Map\Map.dwg, 11:54 AM, 21 JUN 2024 9:50:28 AM, SDE